

I n s t r u k c j a M o n t a ż u

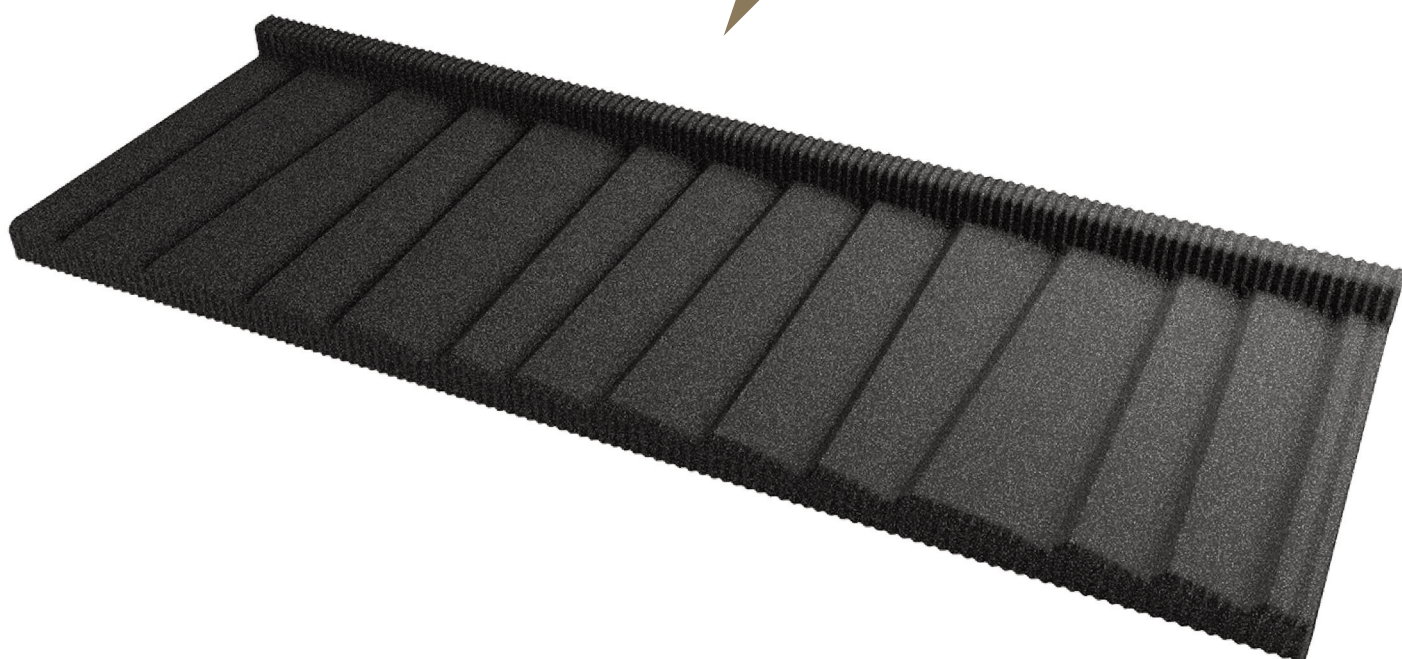

GRUPA  **BLACHOTRAPEZ**

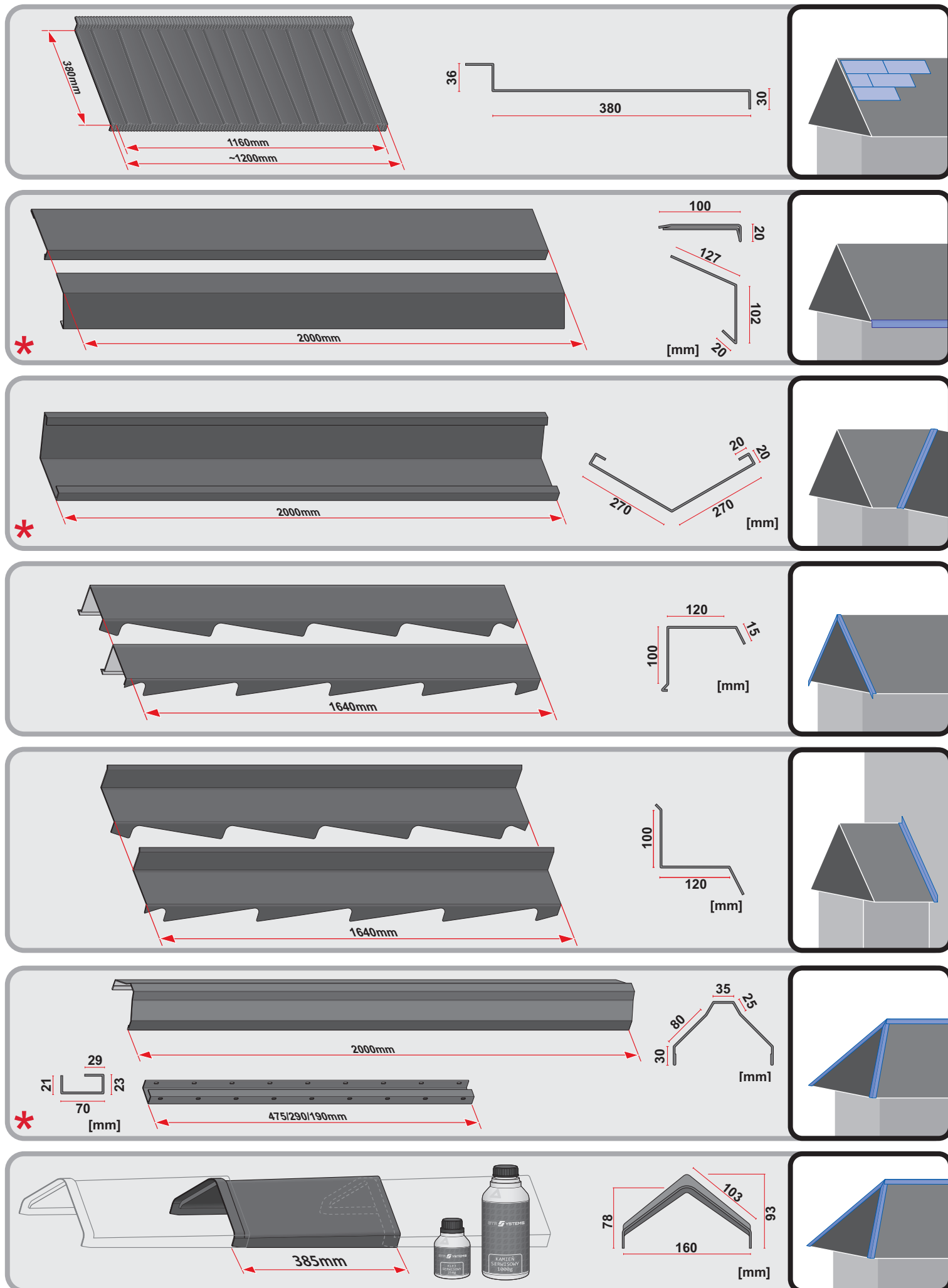



* Obróbki z gwiazdką wykonane na zamówienie z blachy Pladur® Relief Textured Wood.

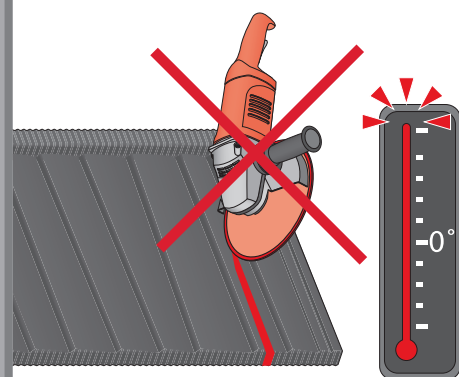
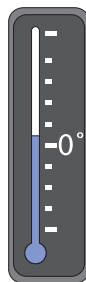
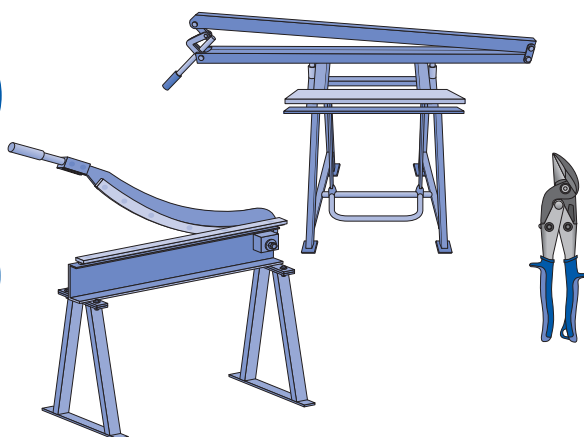

3

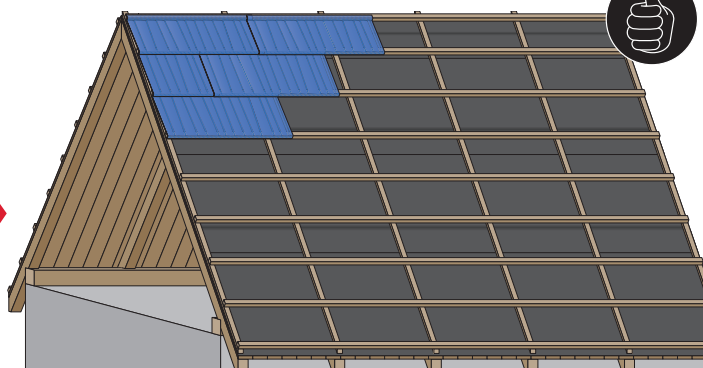
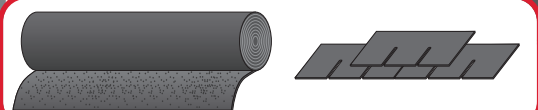
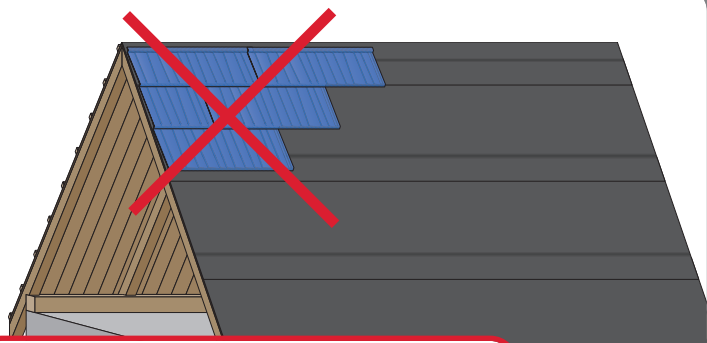
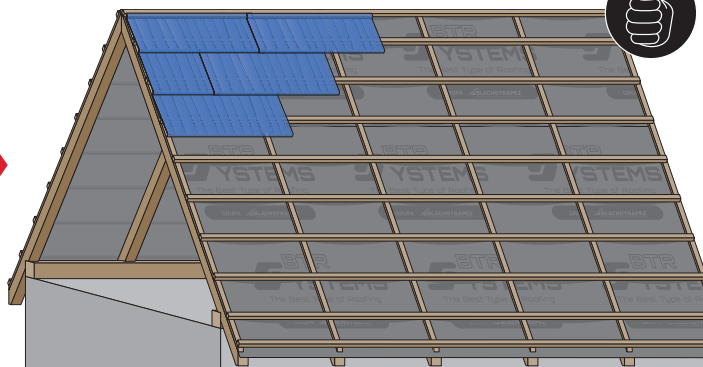
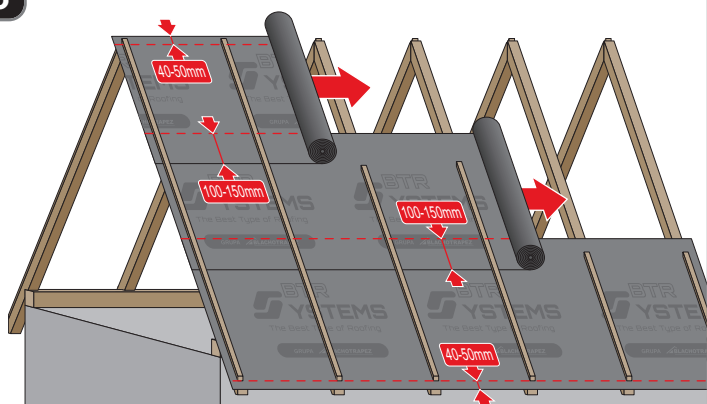

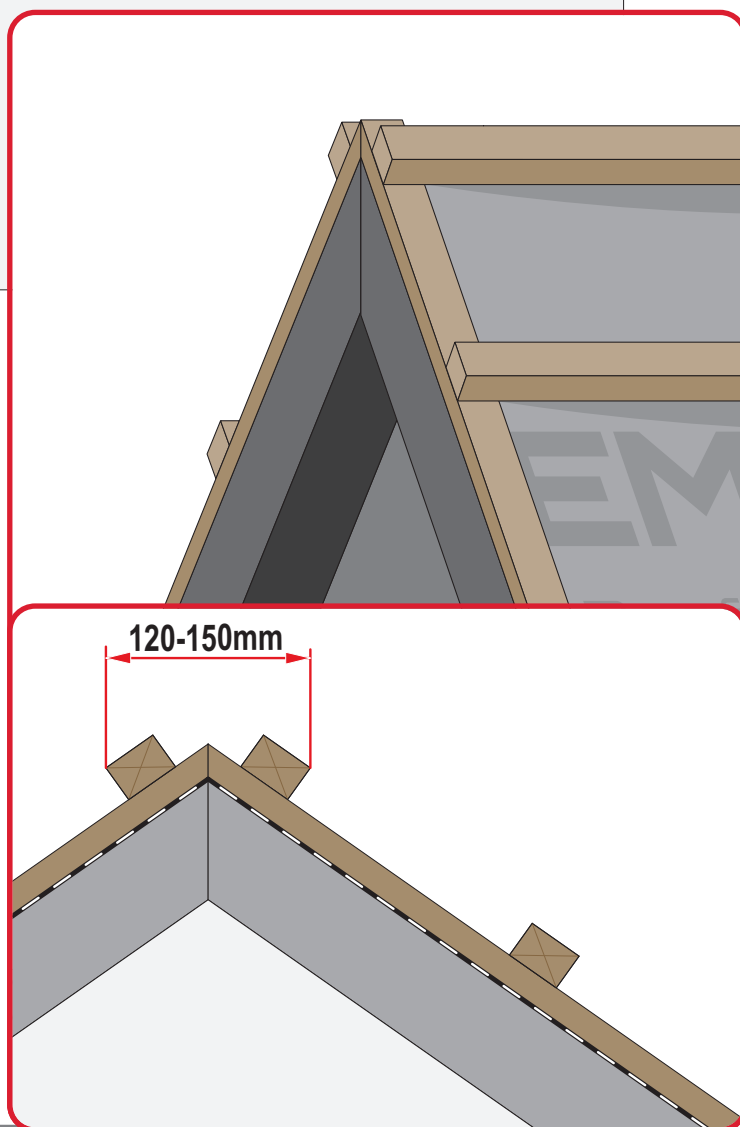
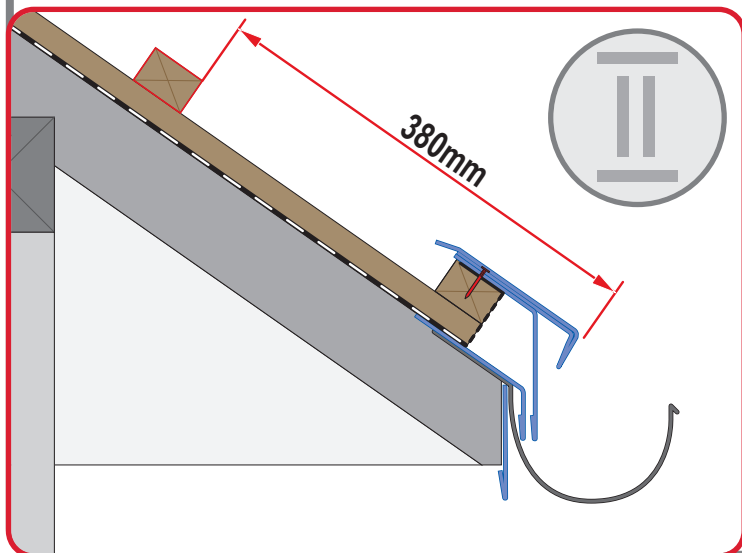
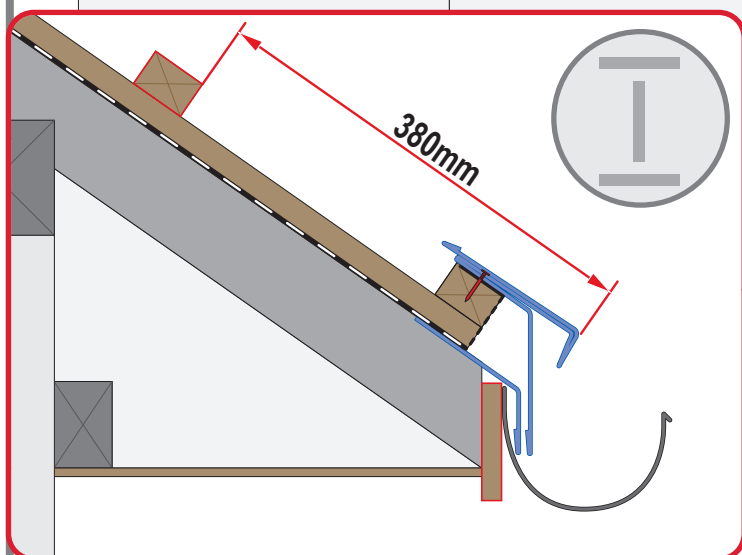
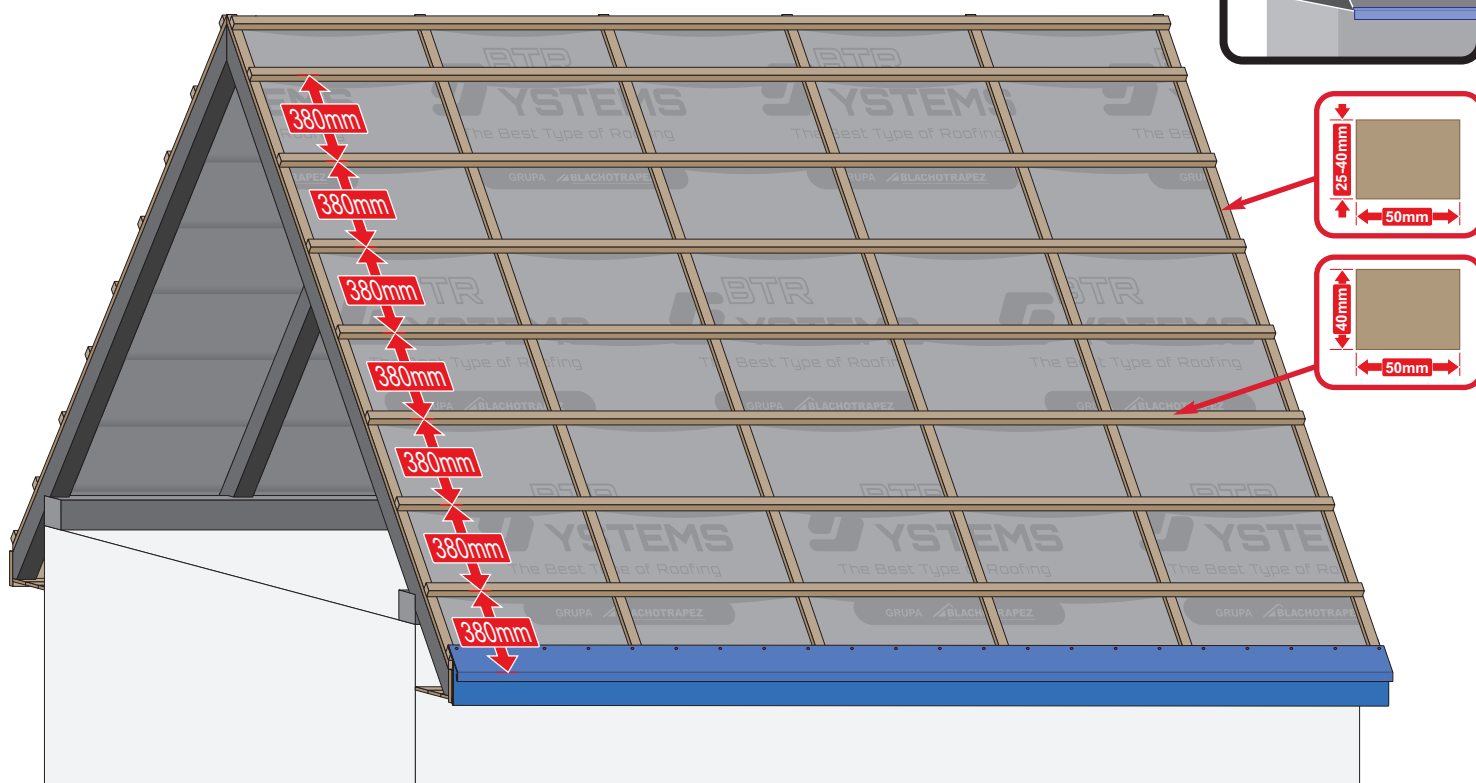

5a

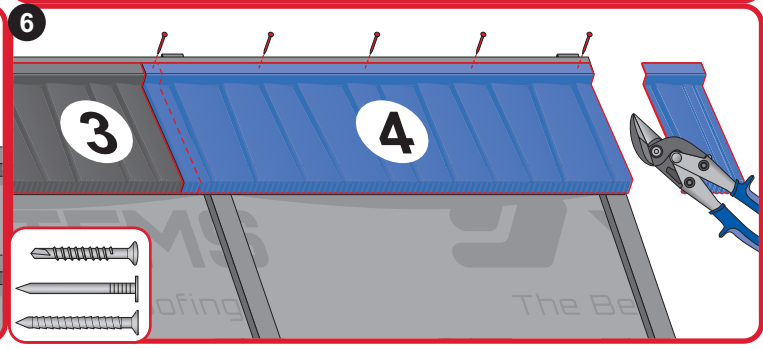
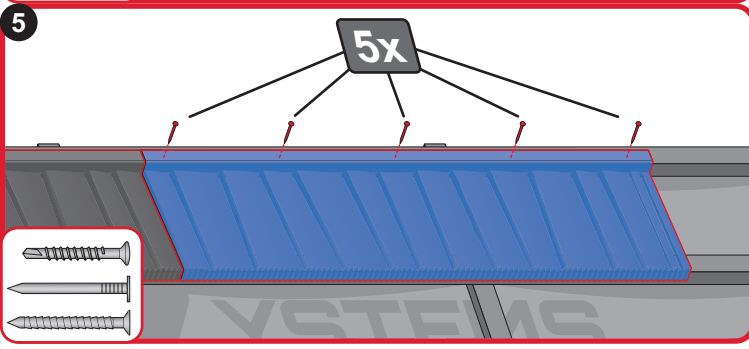
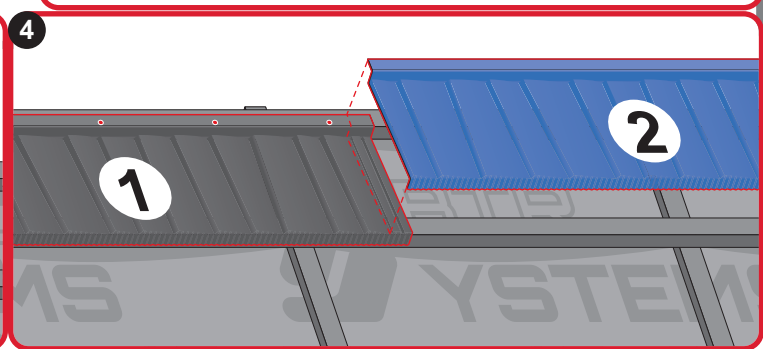
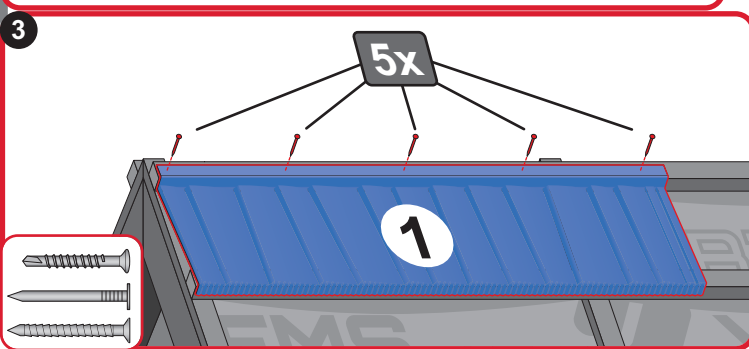
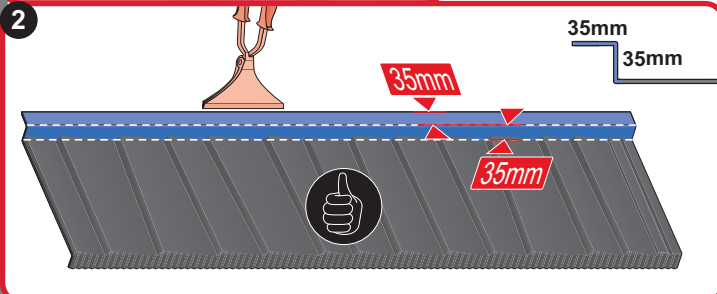
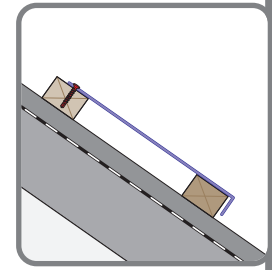
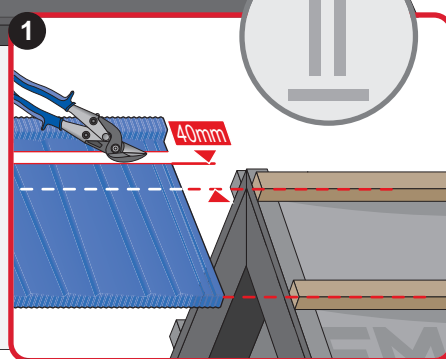
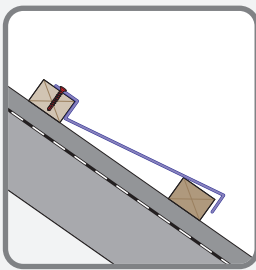
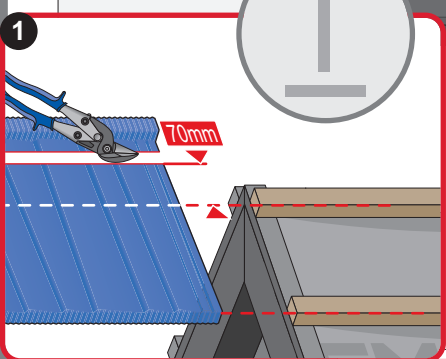
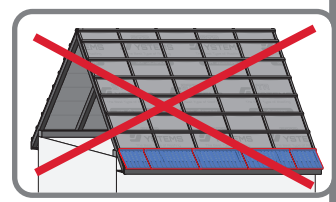
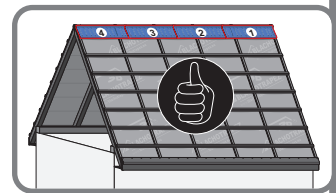
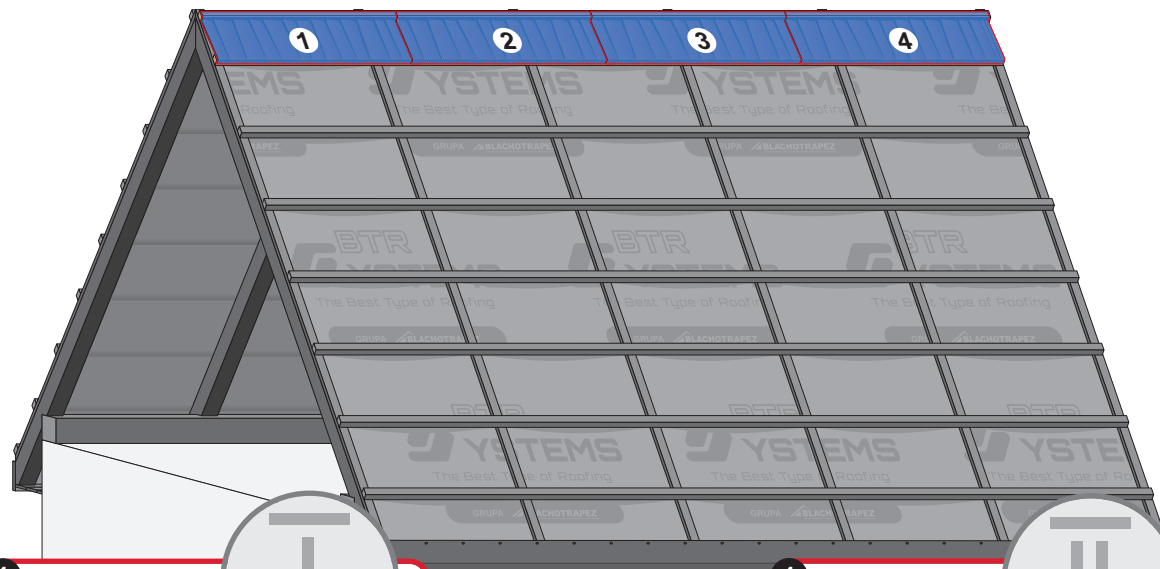
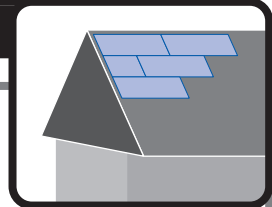

5b

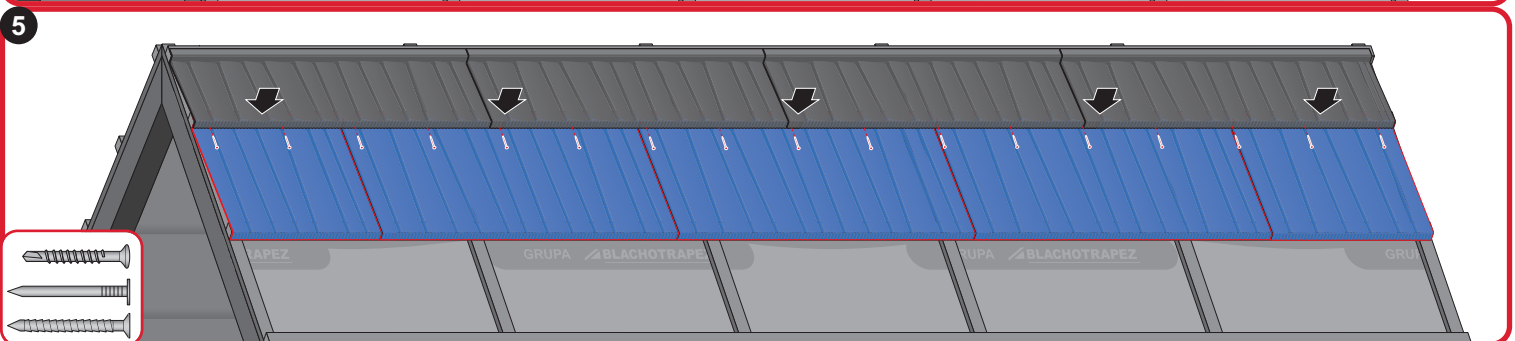
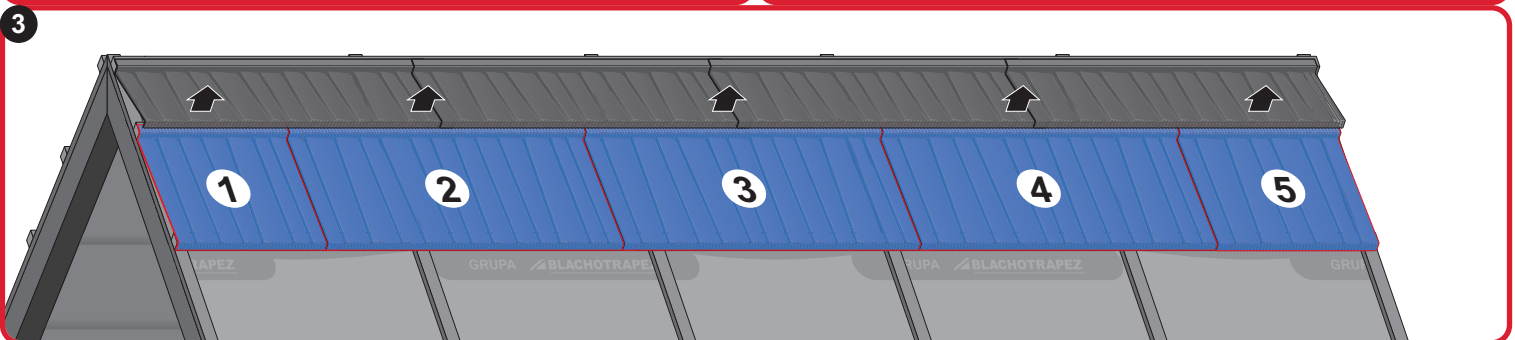
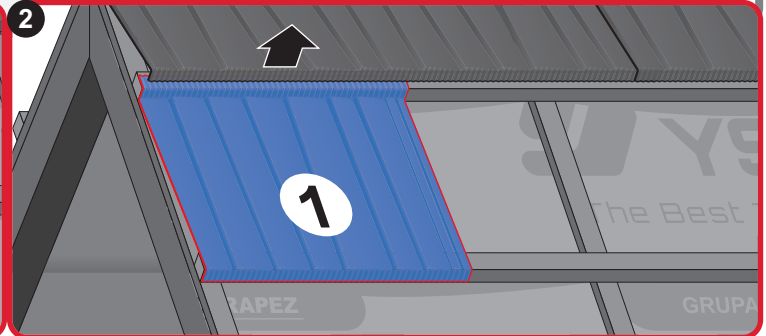
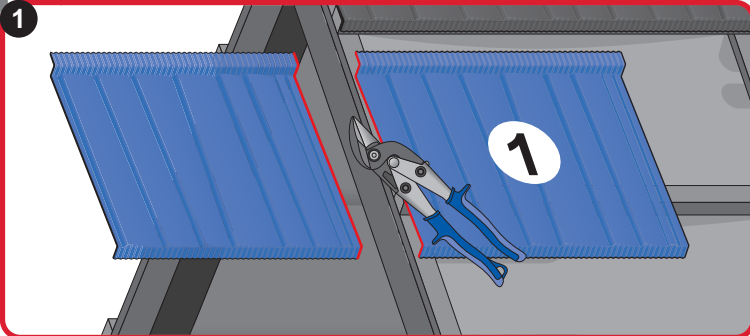
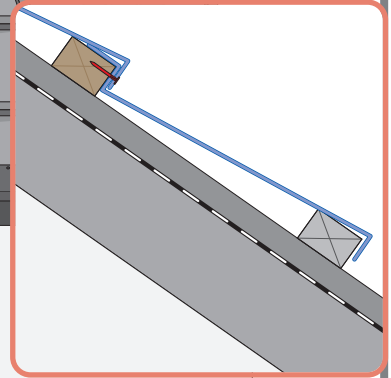
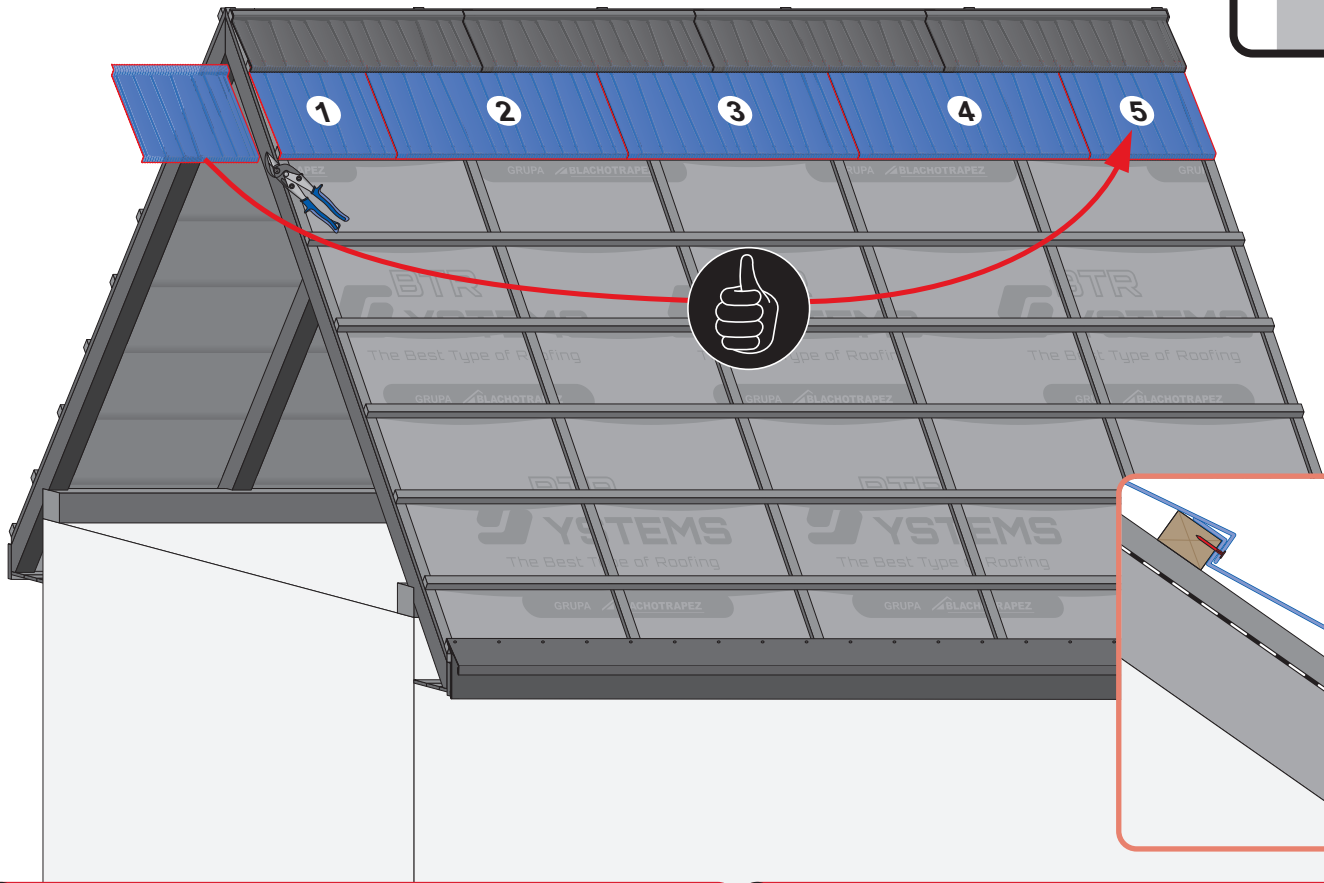
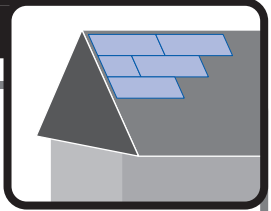

5c

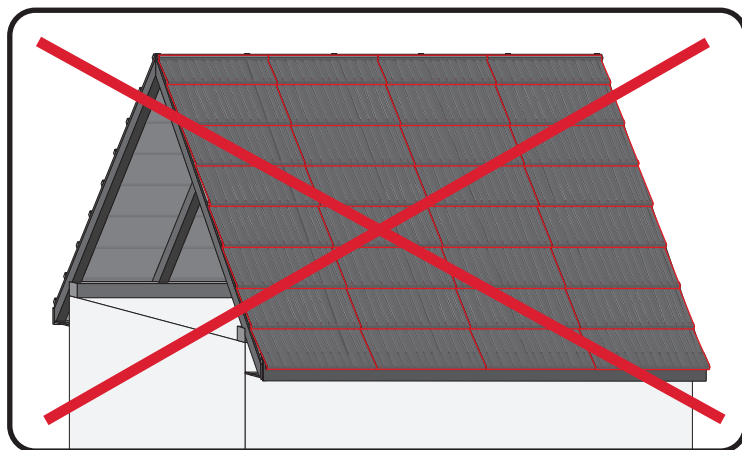
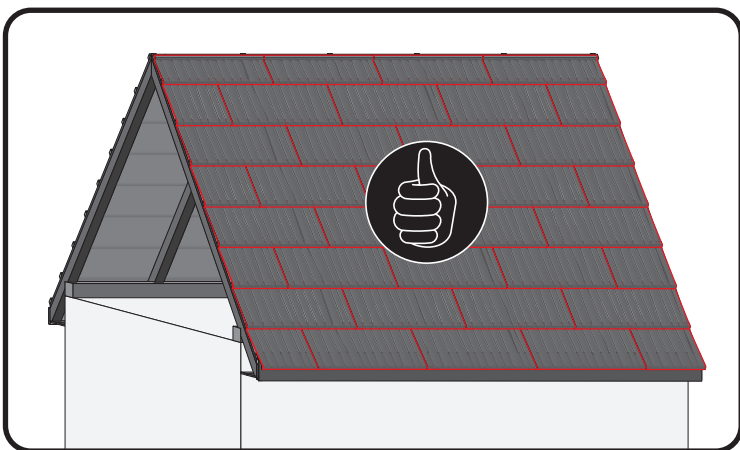
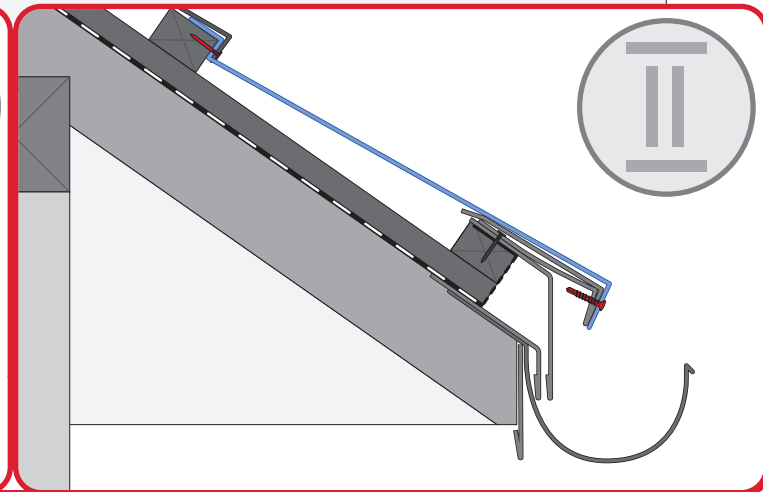
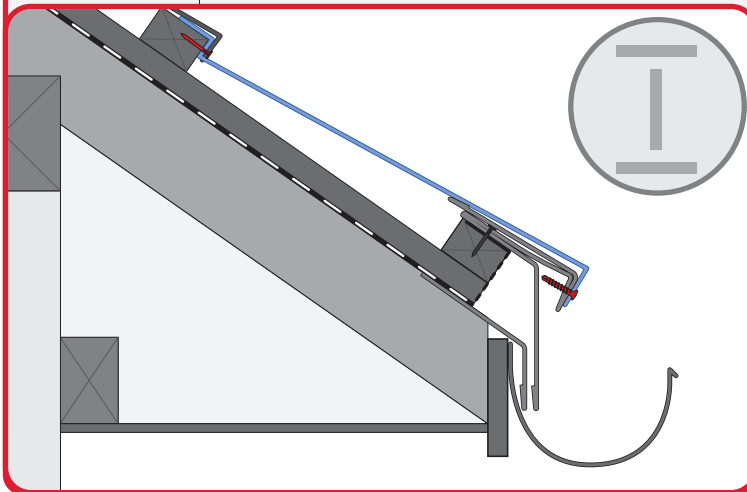
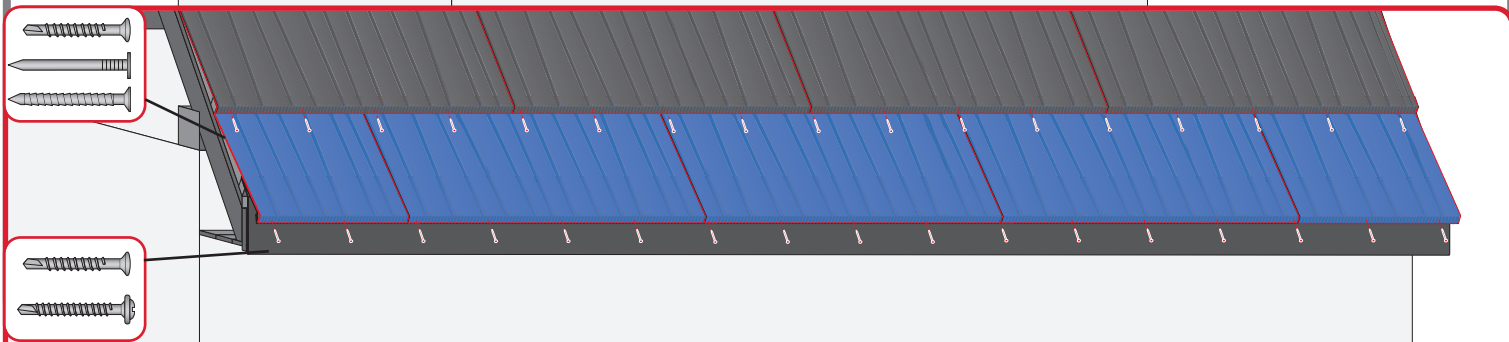
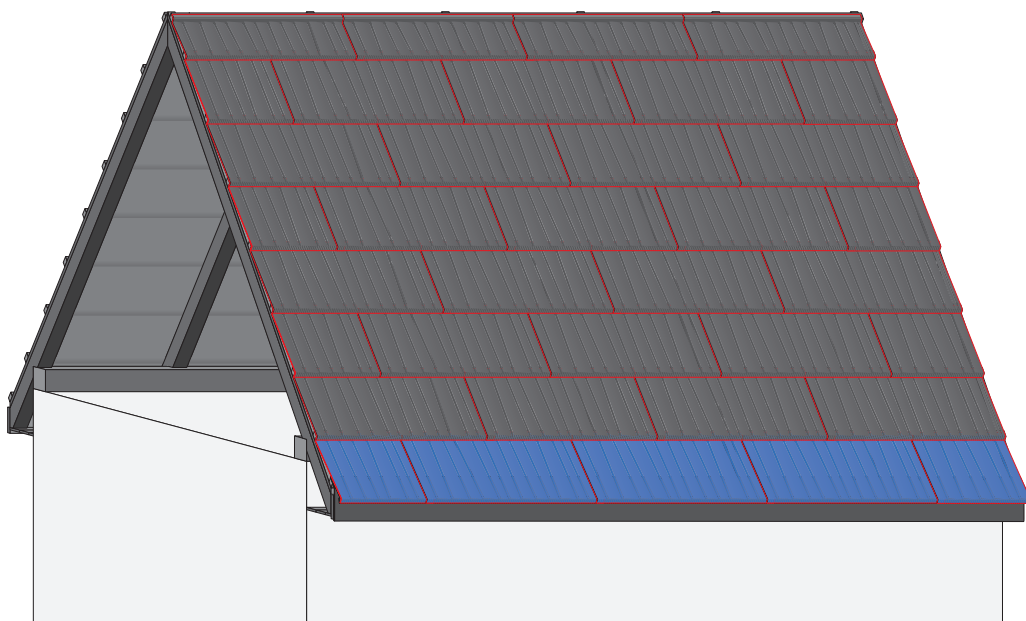
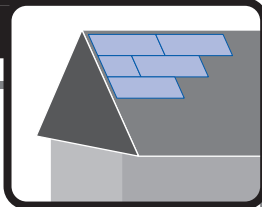

6a

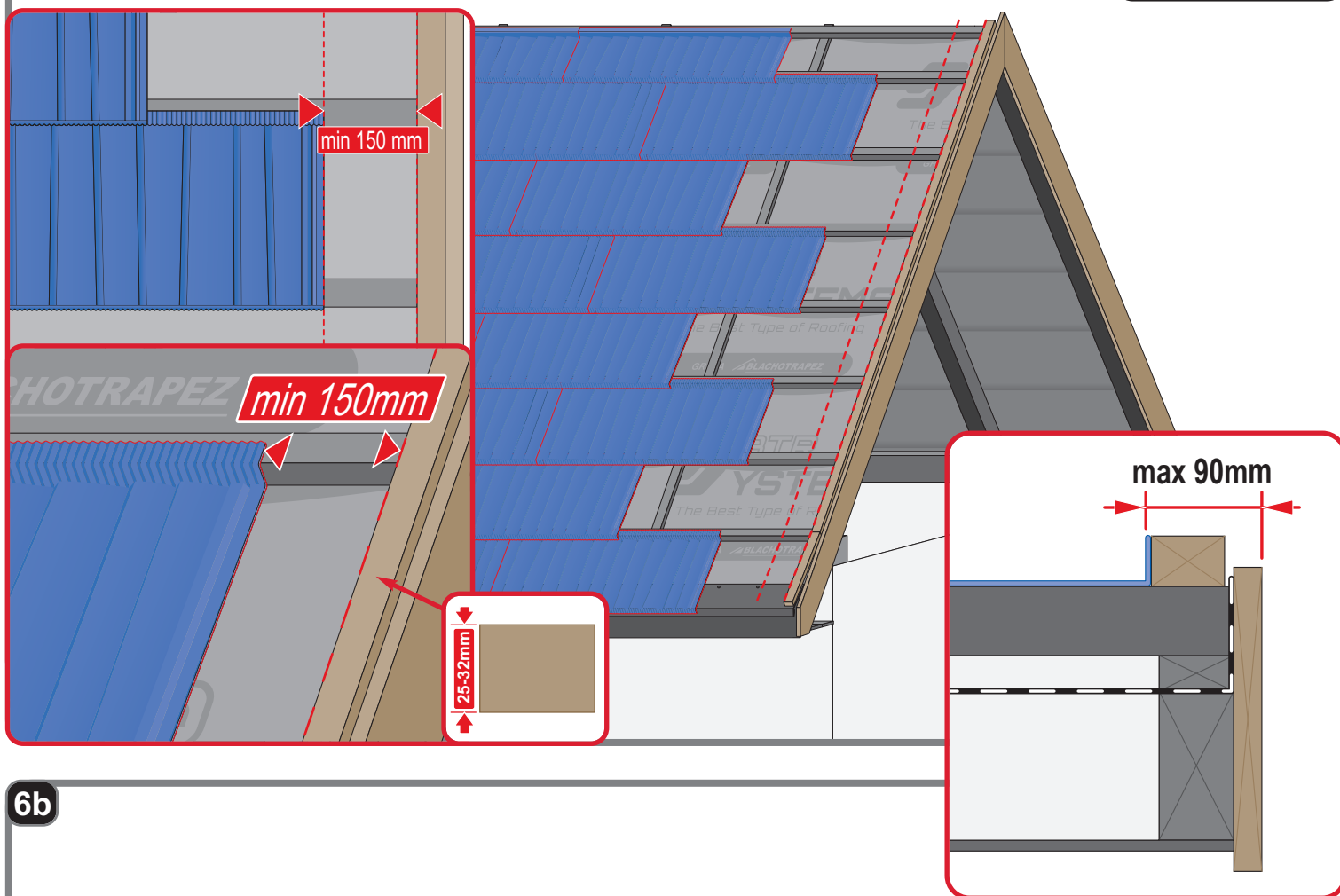

6b

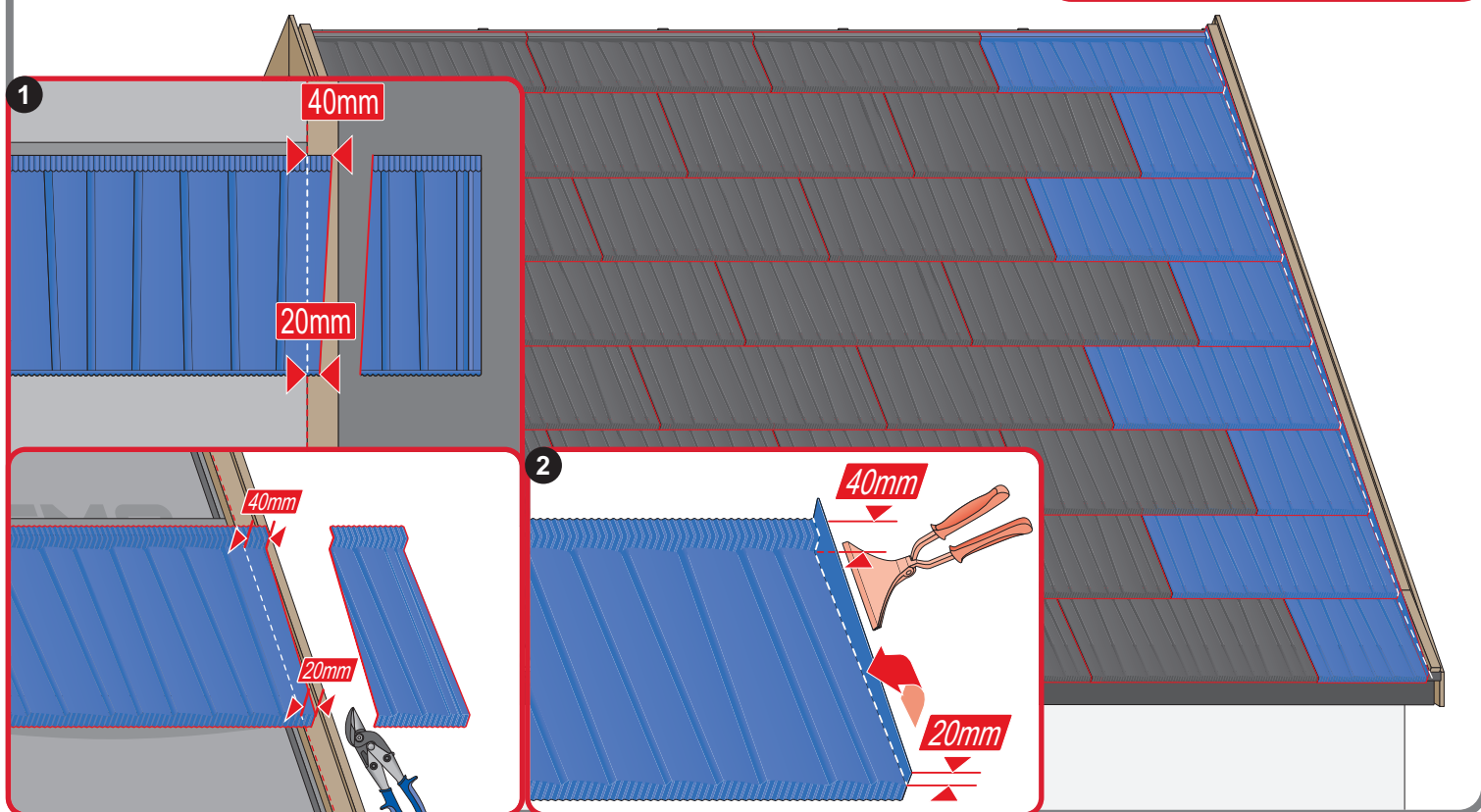



7a

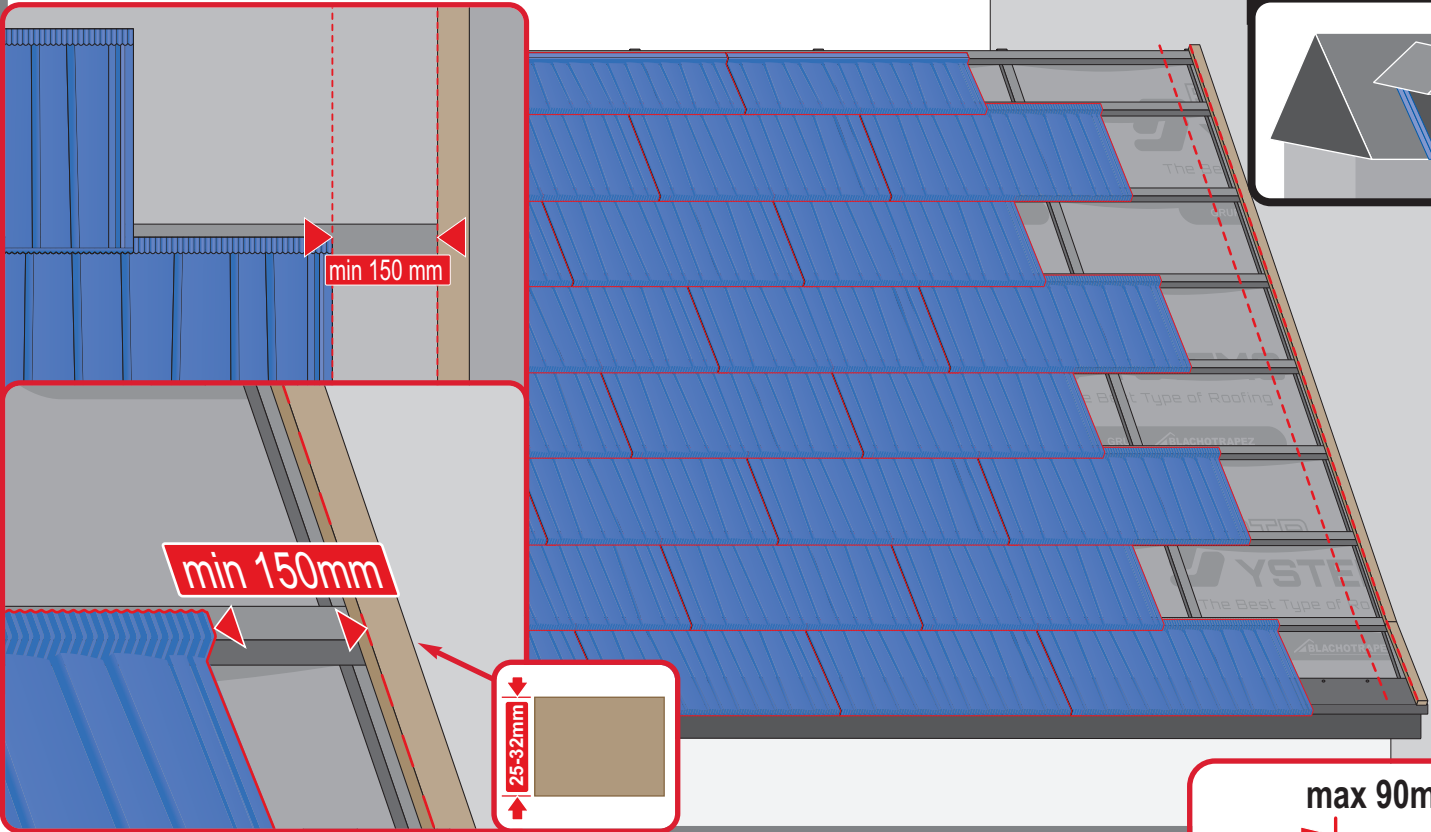

7b

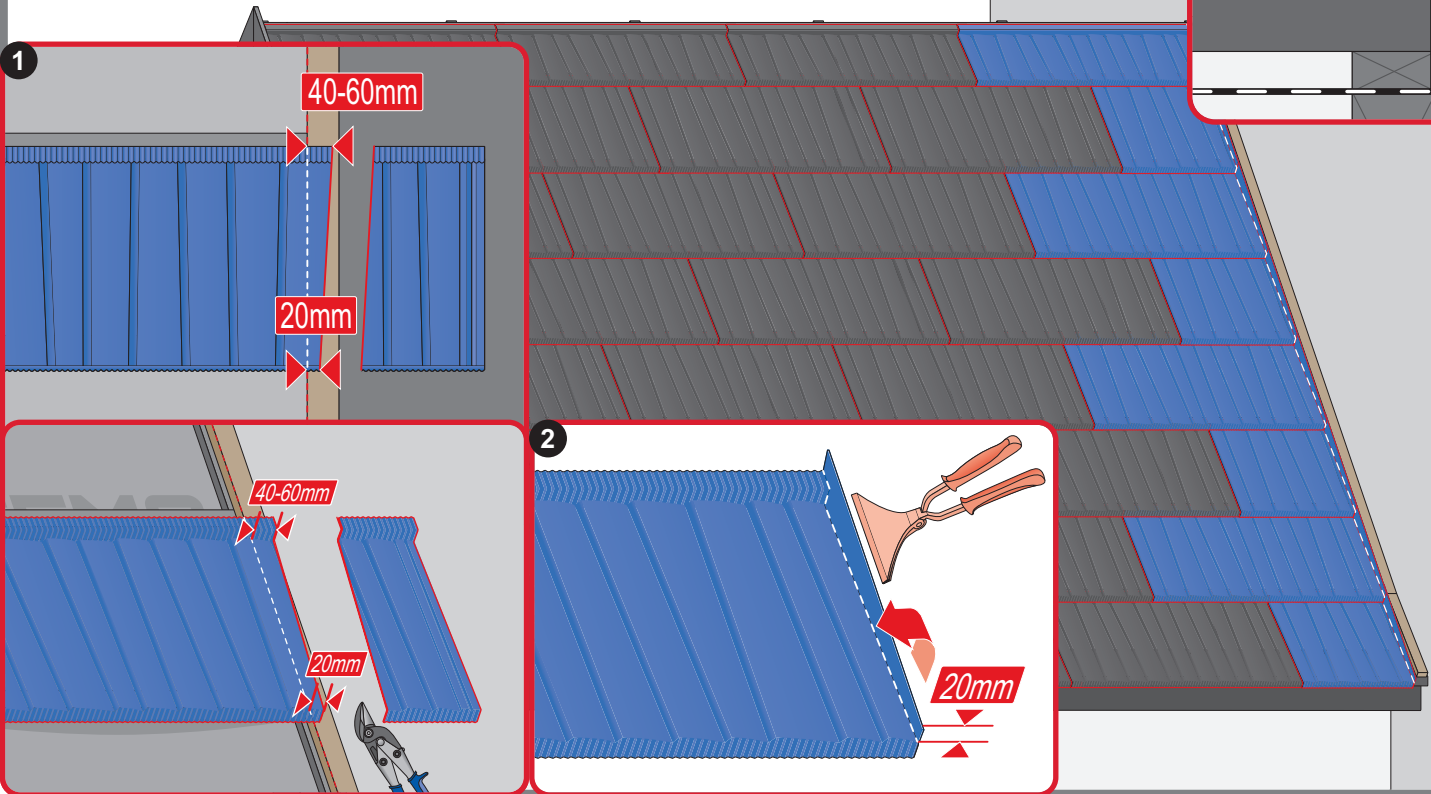

7c

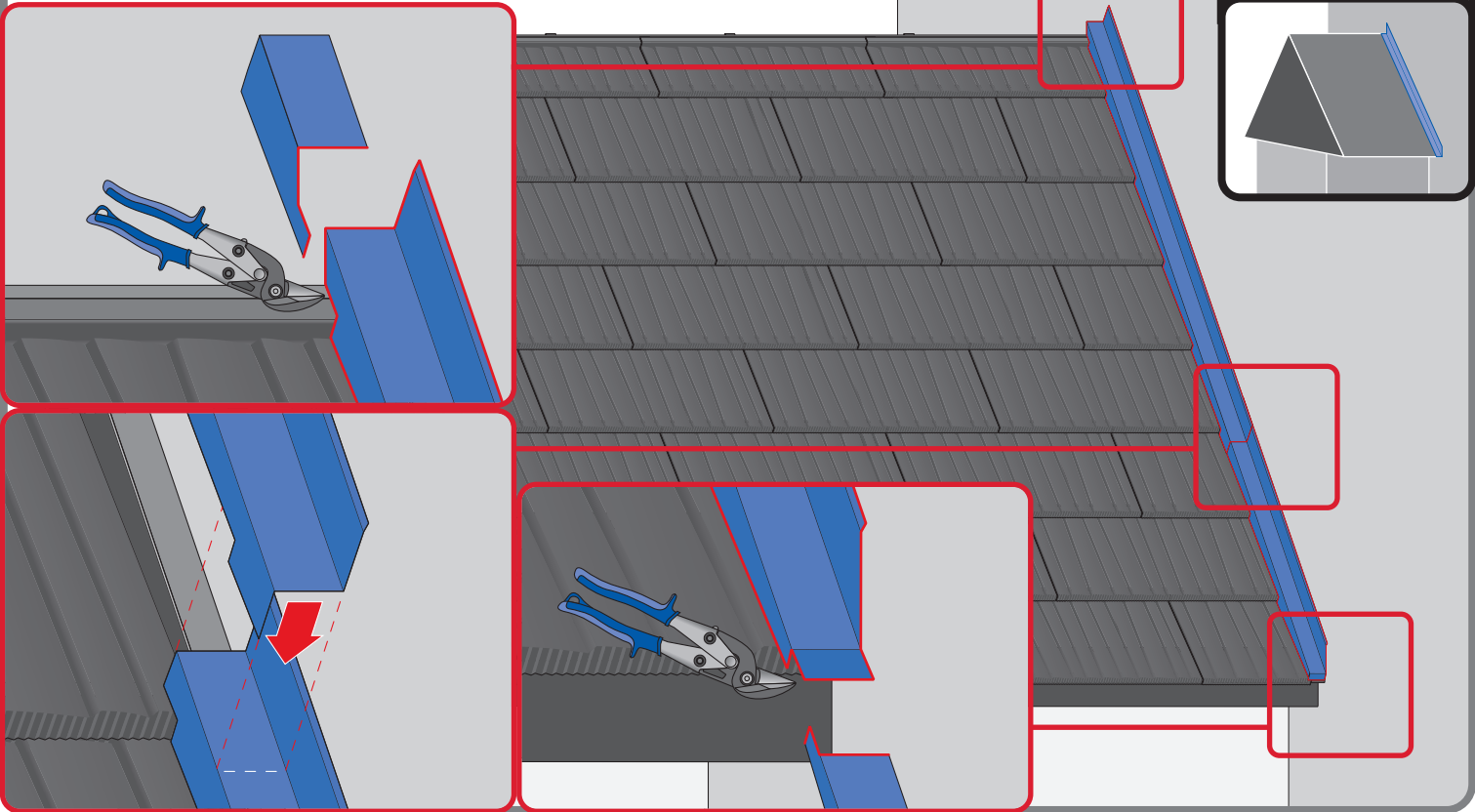

7d

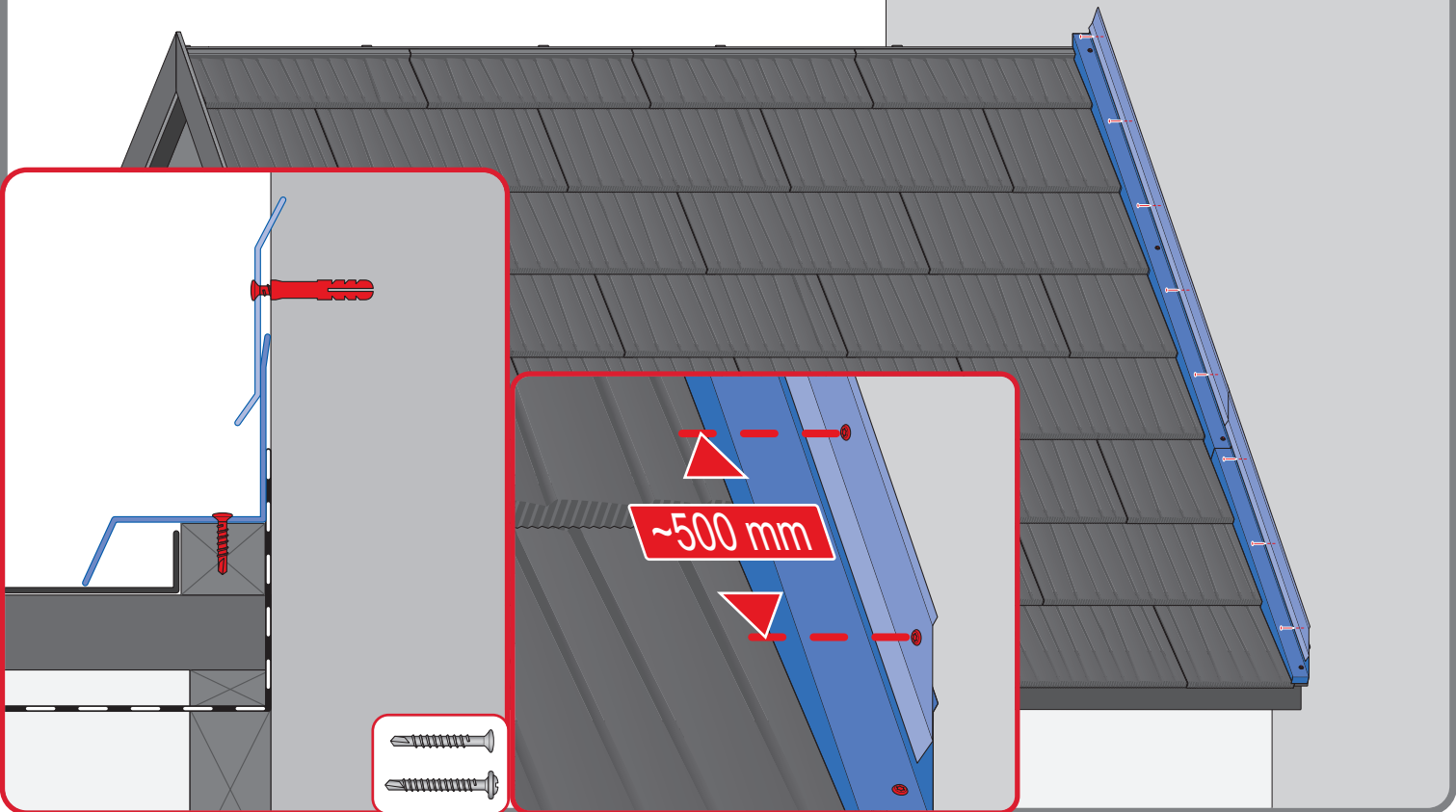

8a

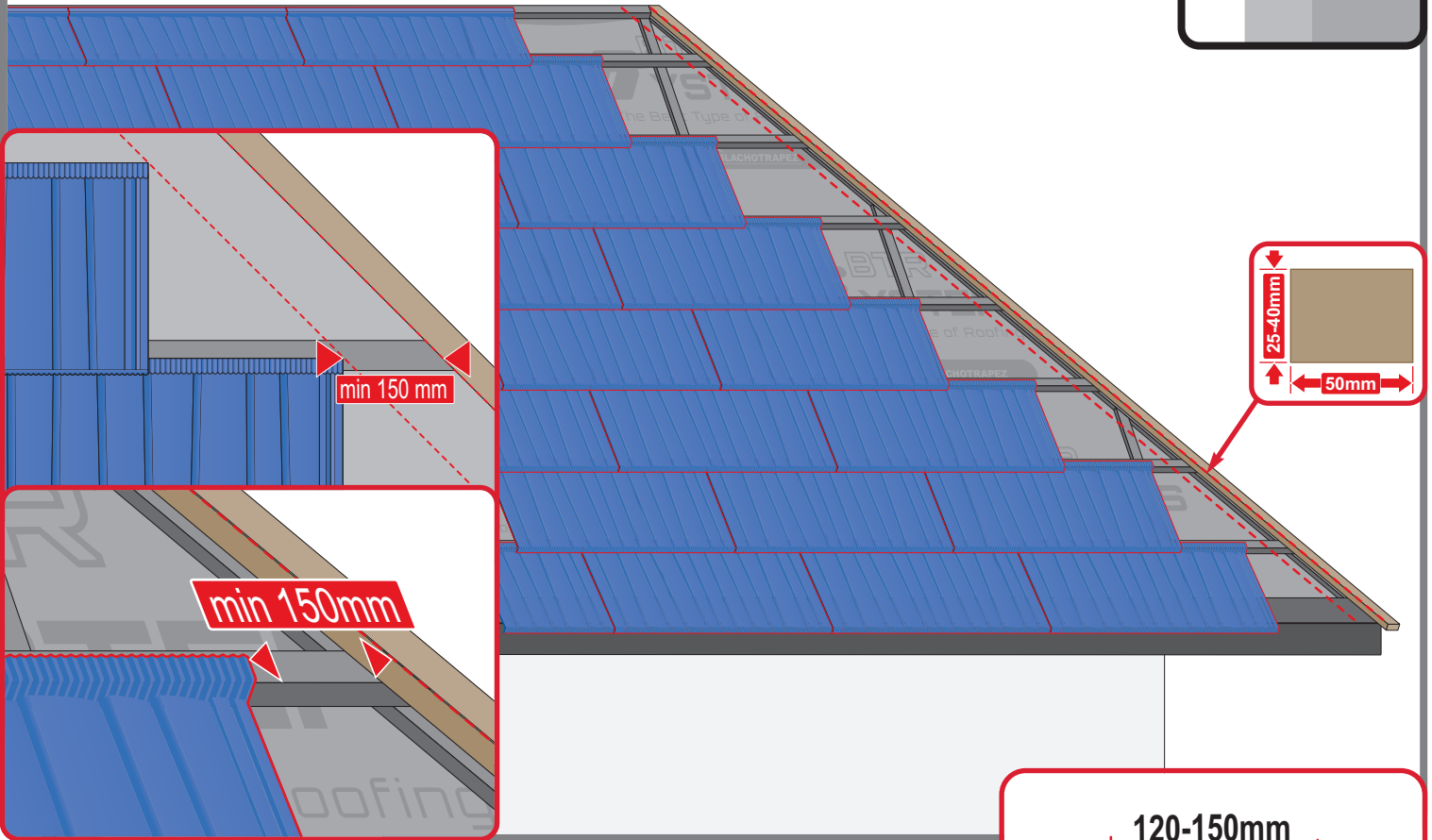

8b

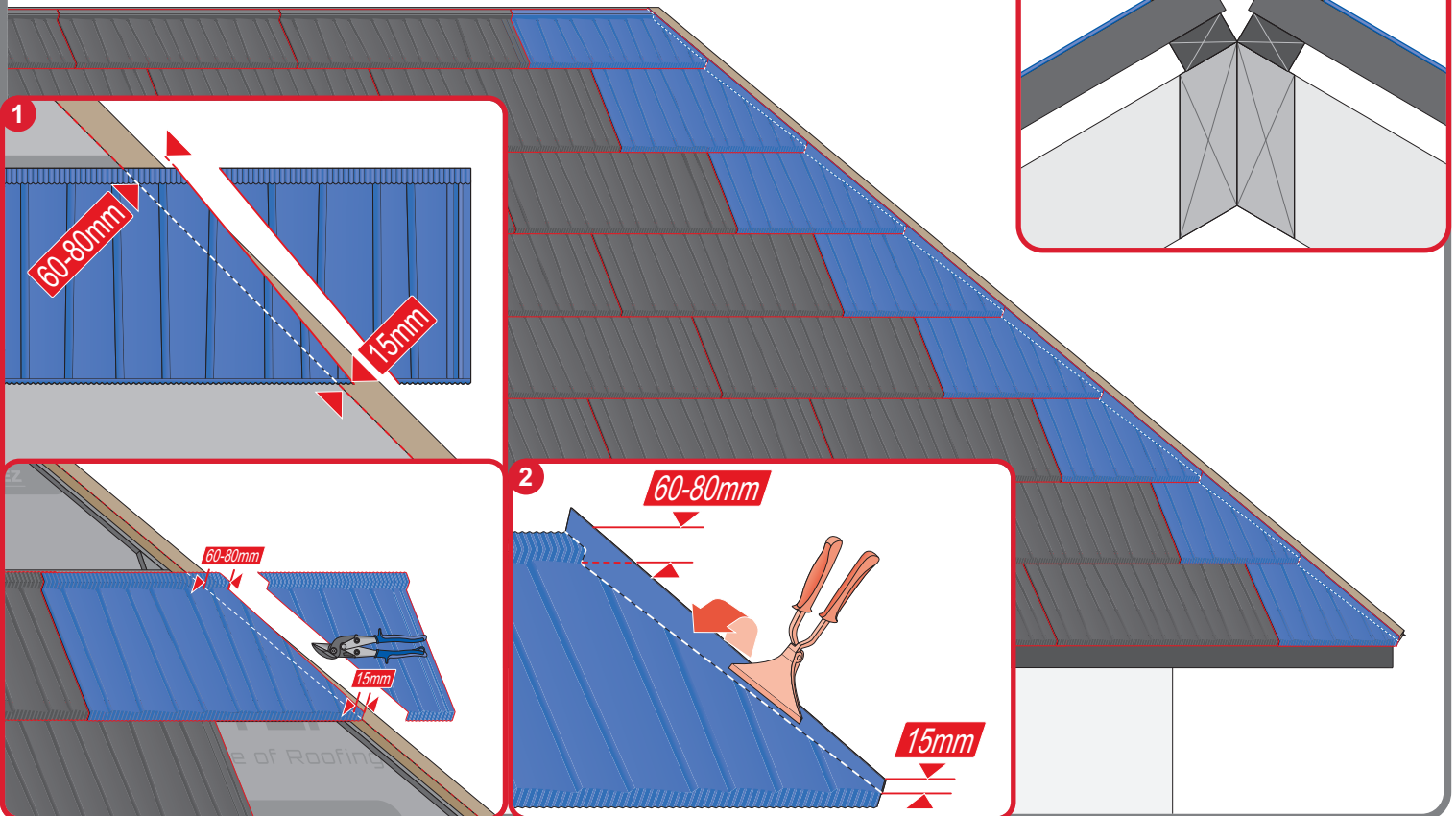

8c

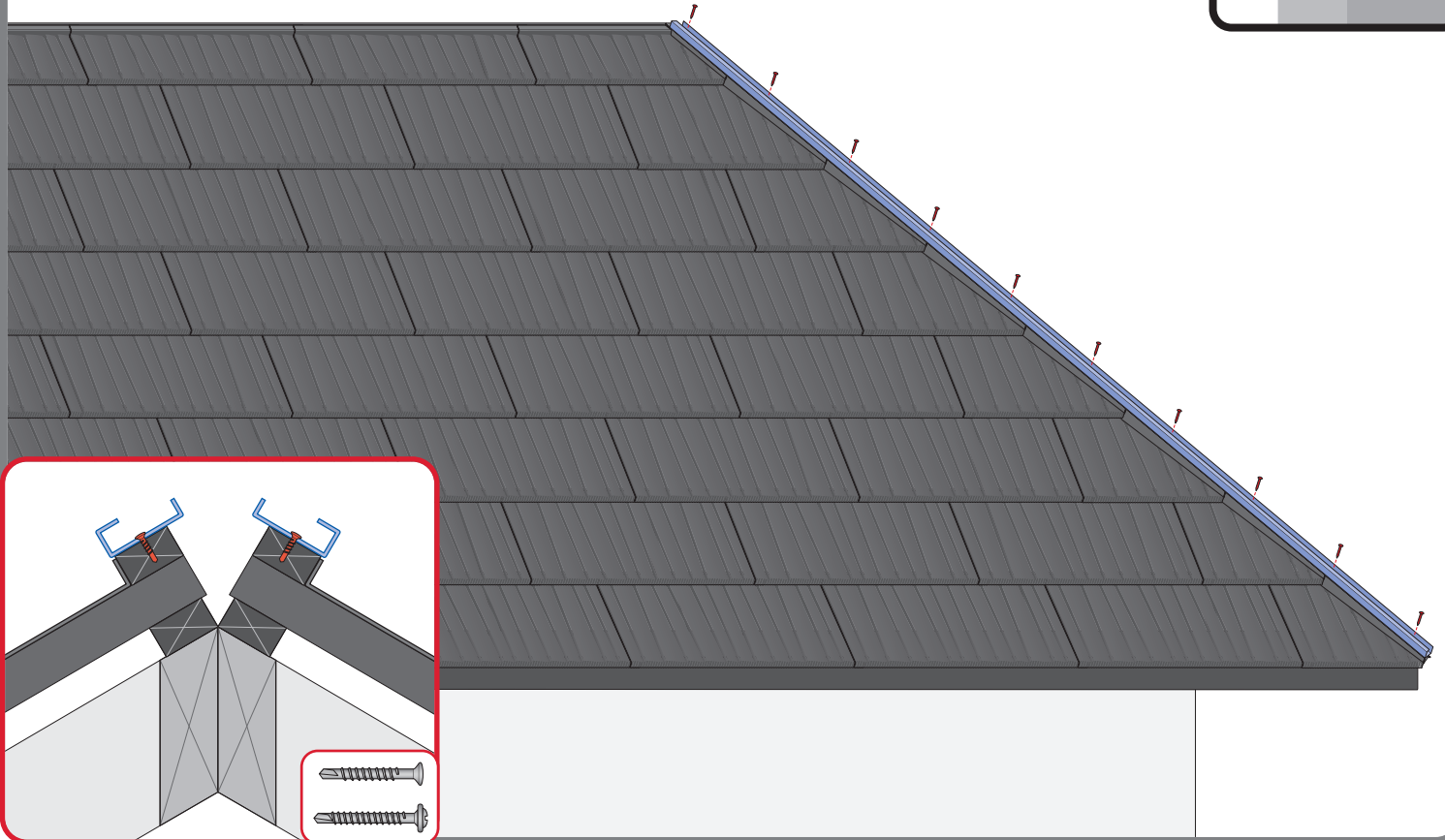
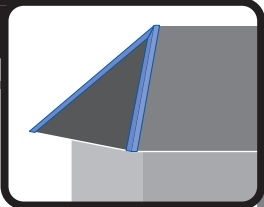

8d

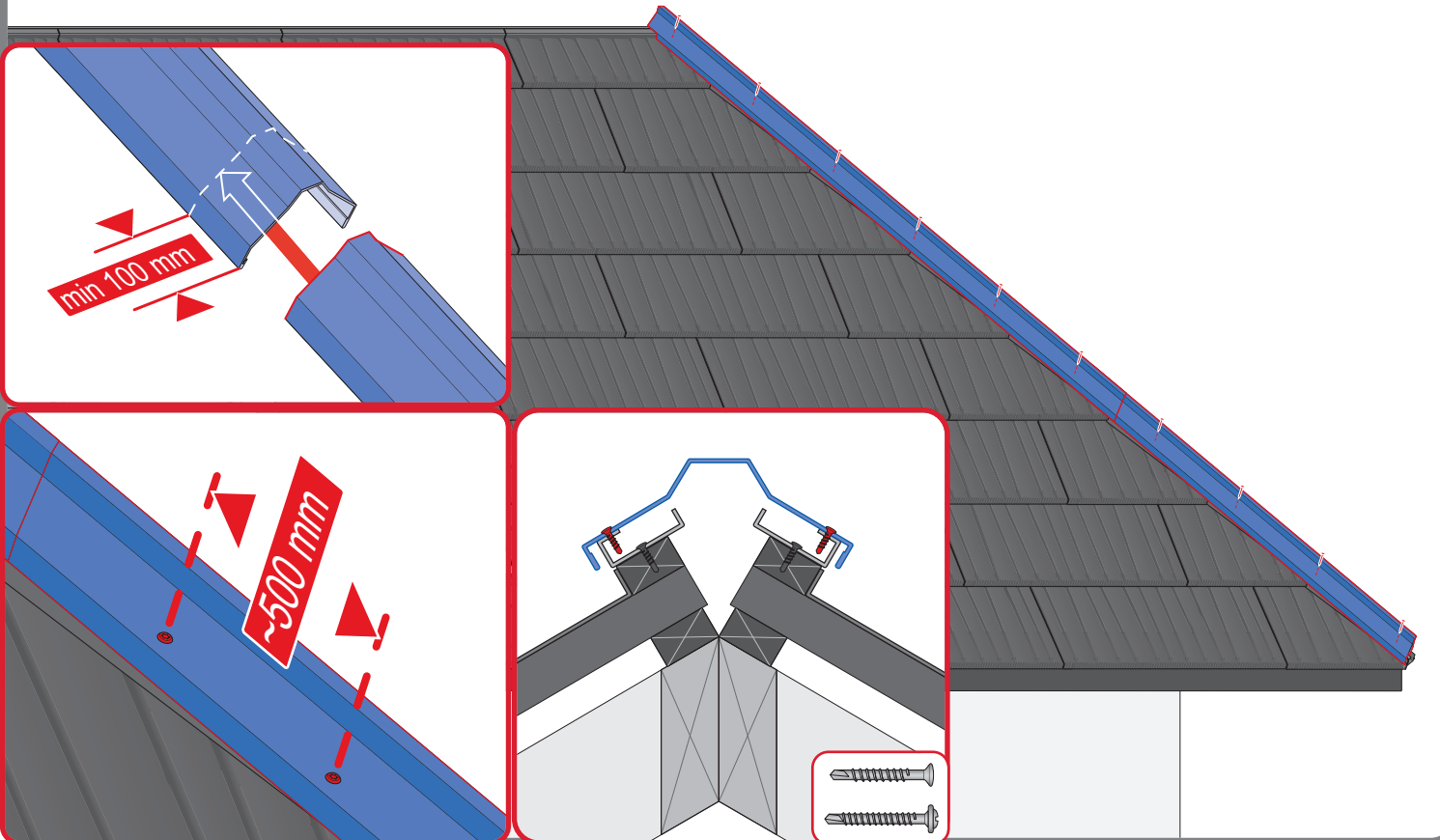

9a

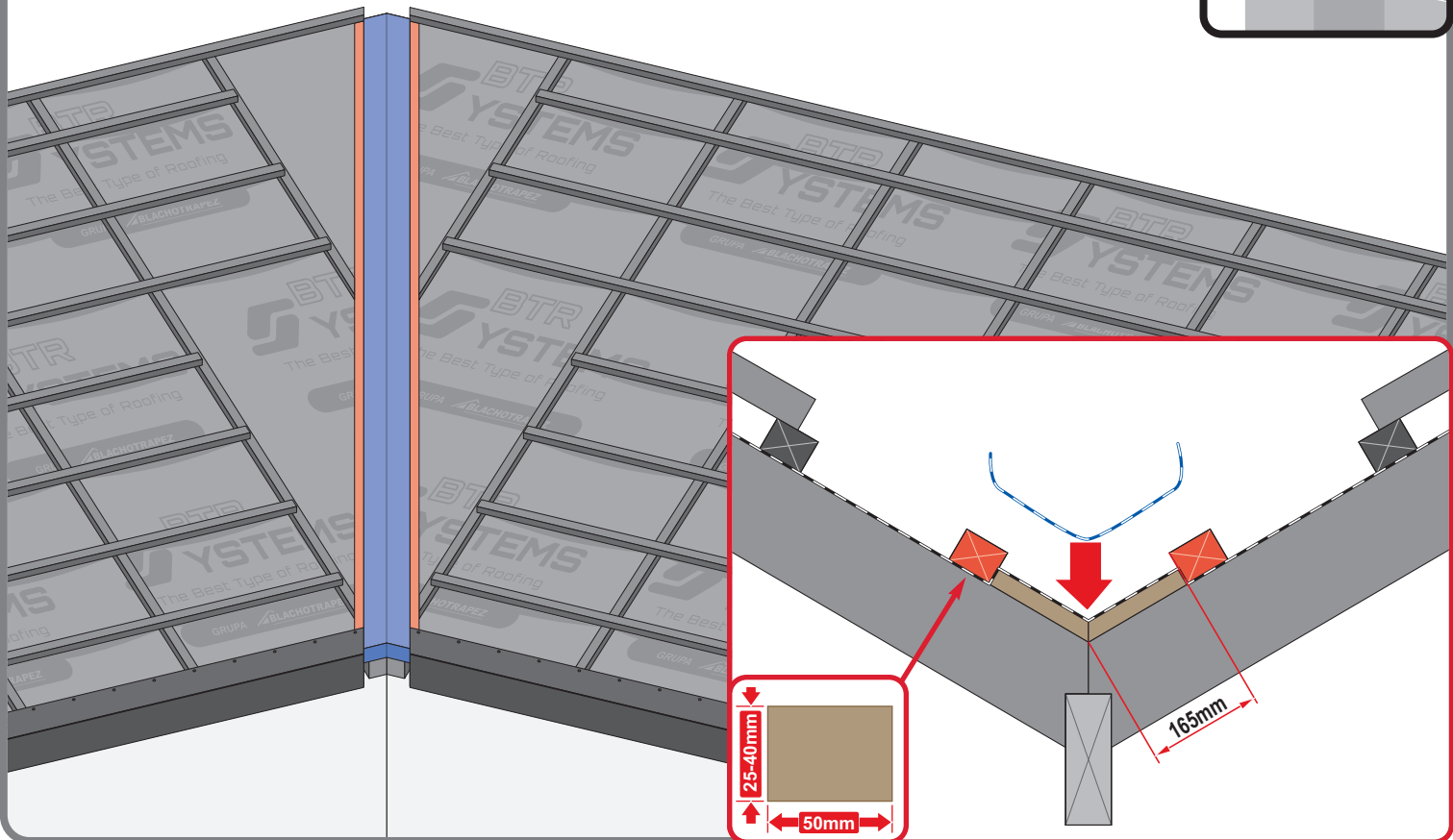

9b

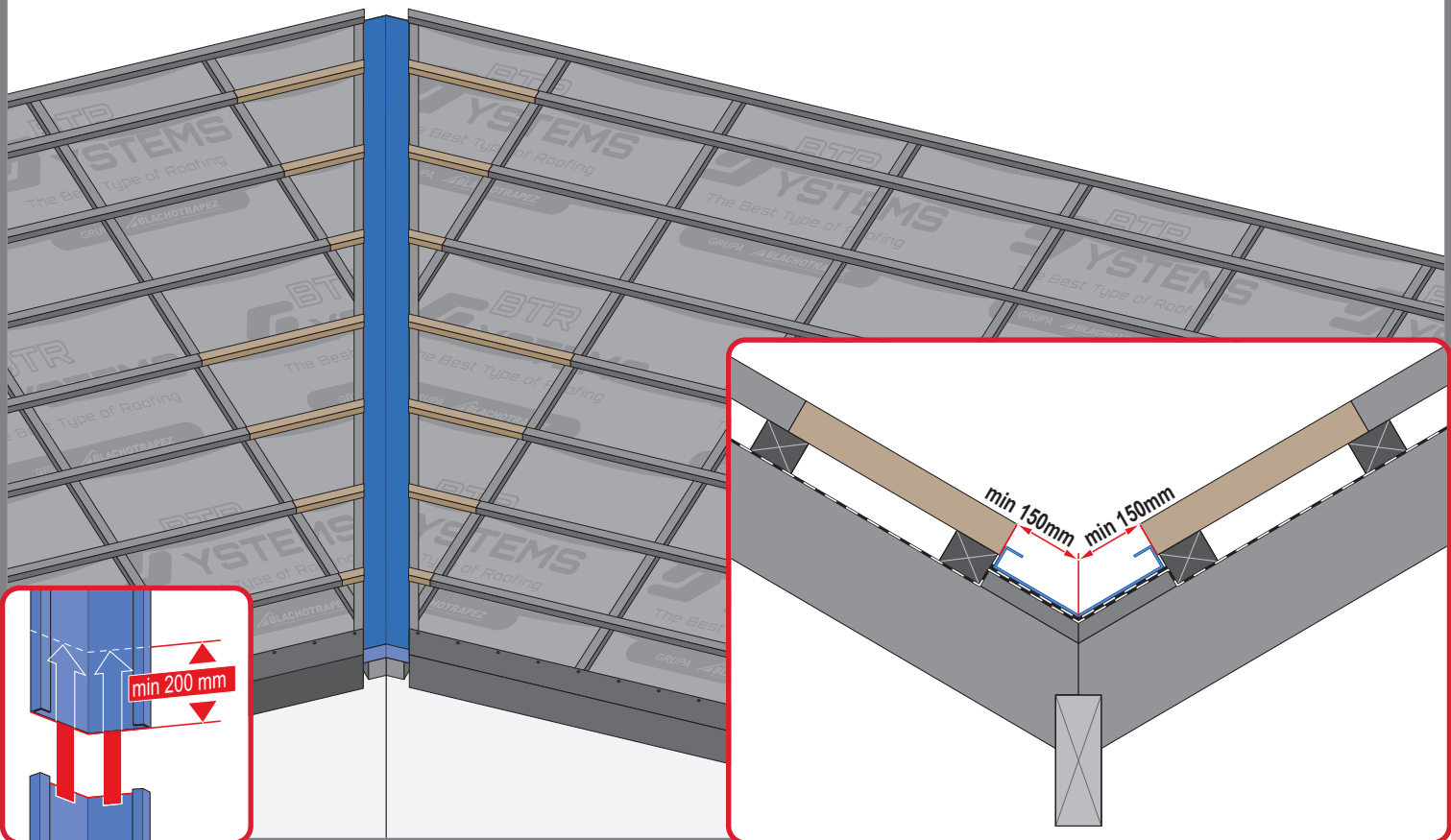

9c

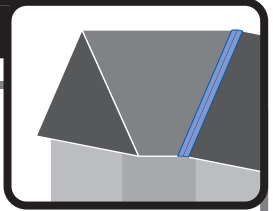
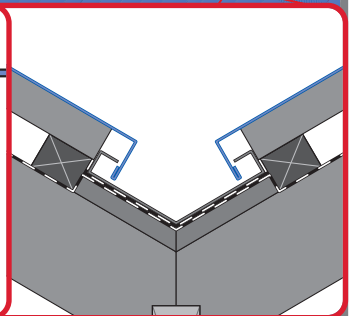
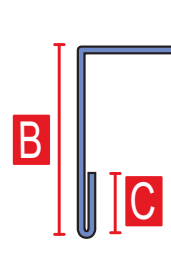
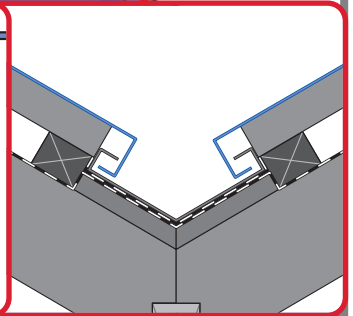
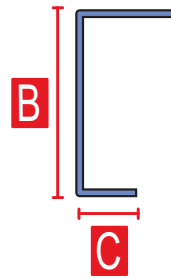
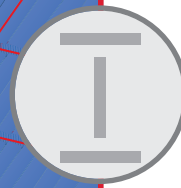
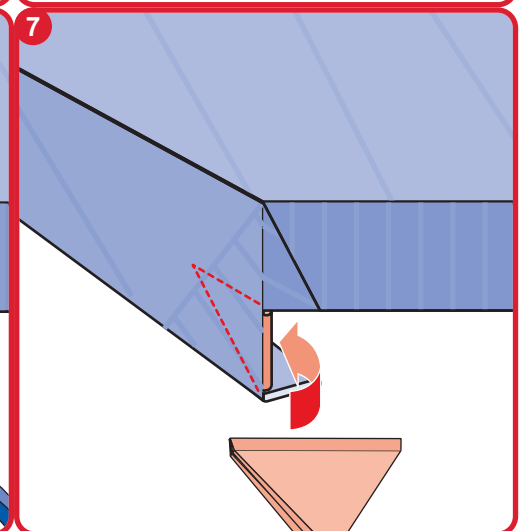
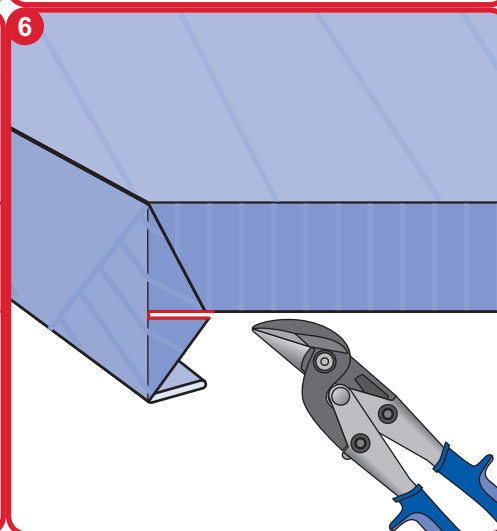
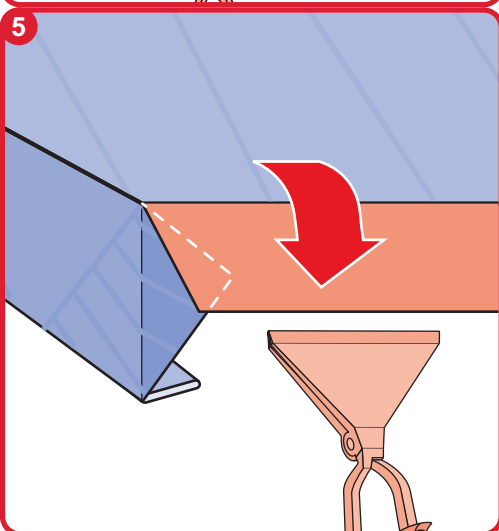
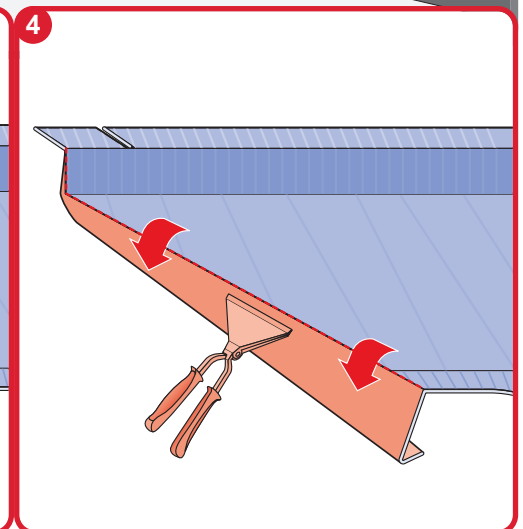
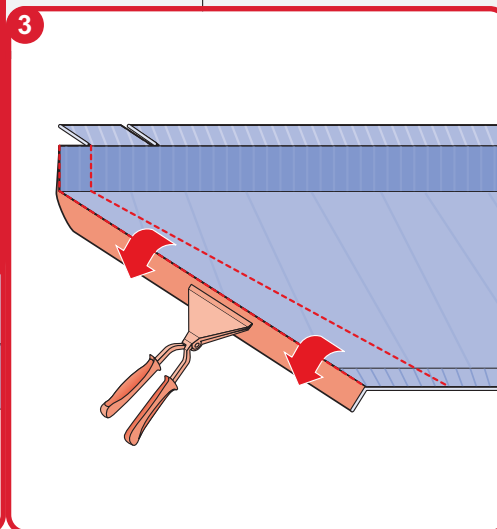
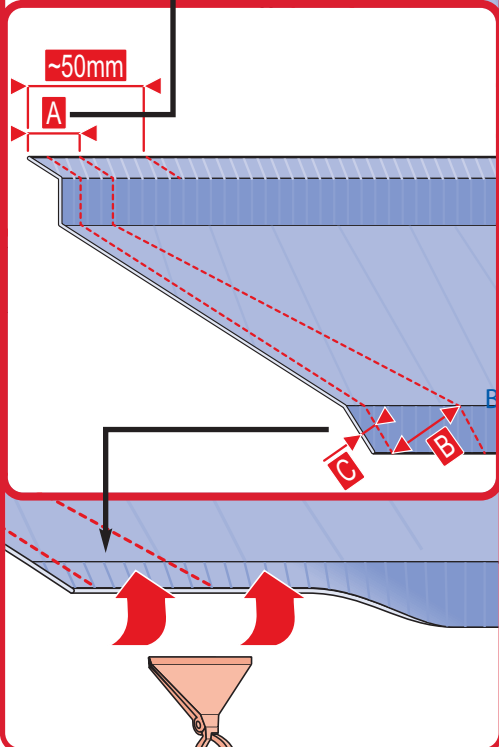
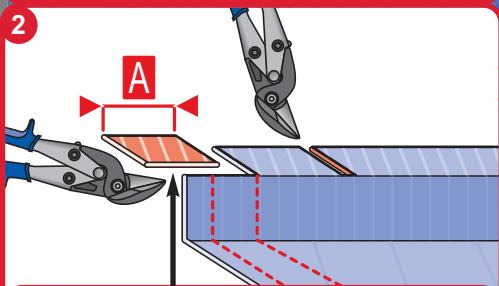
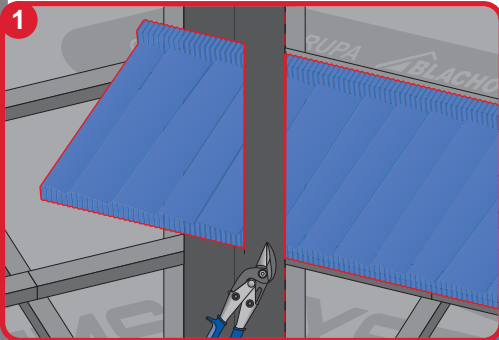

10a

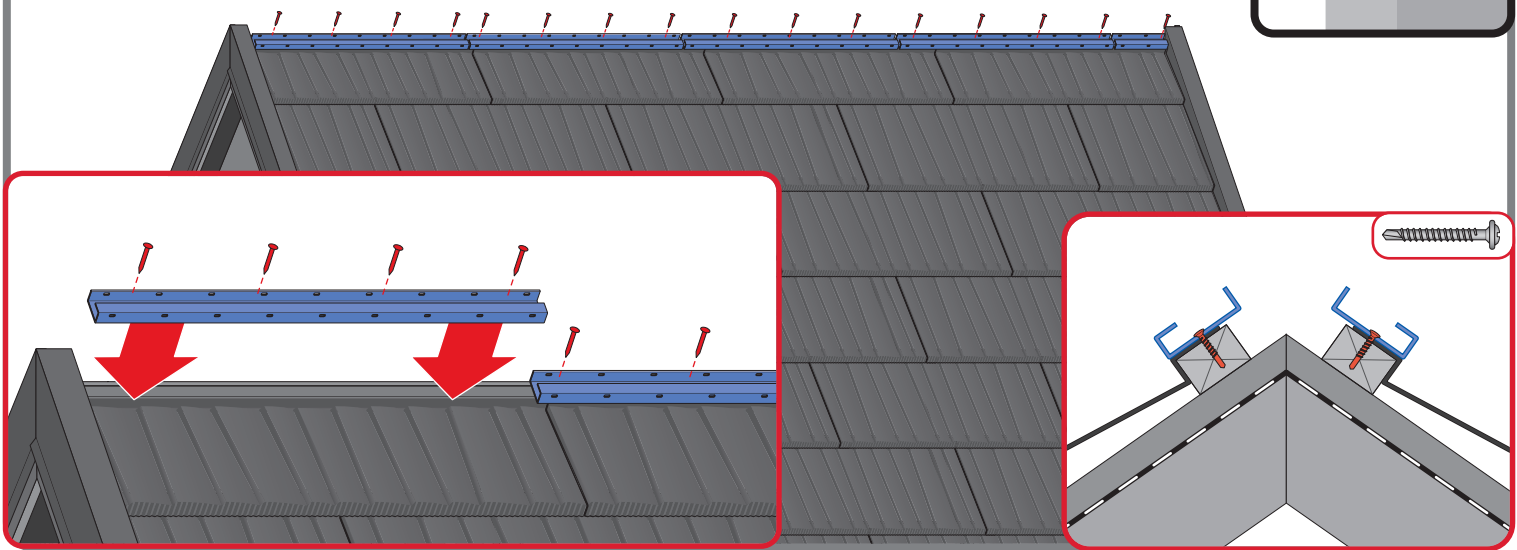

10b

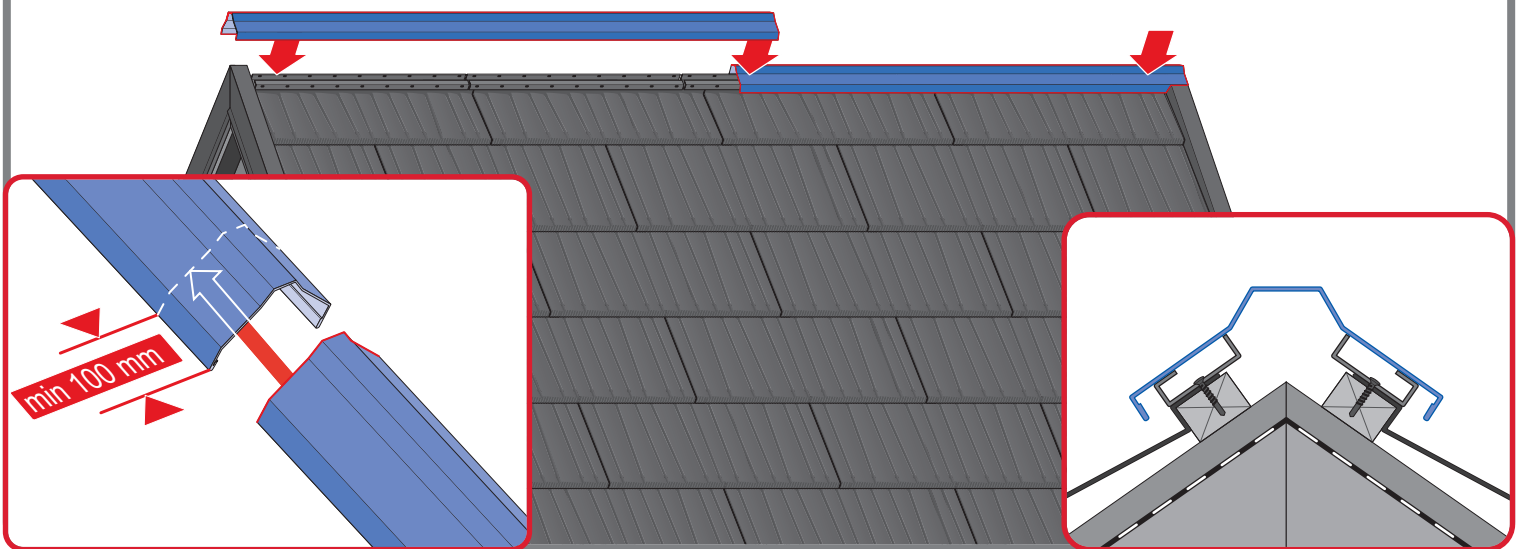

10c

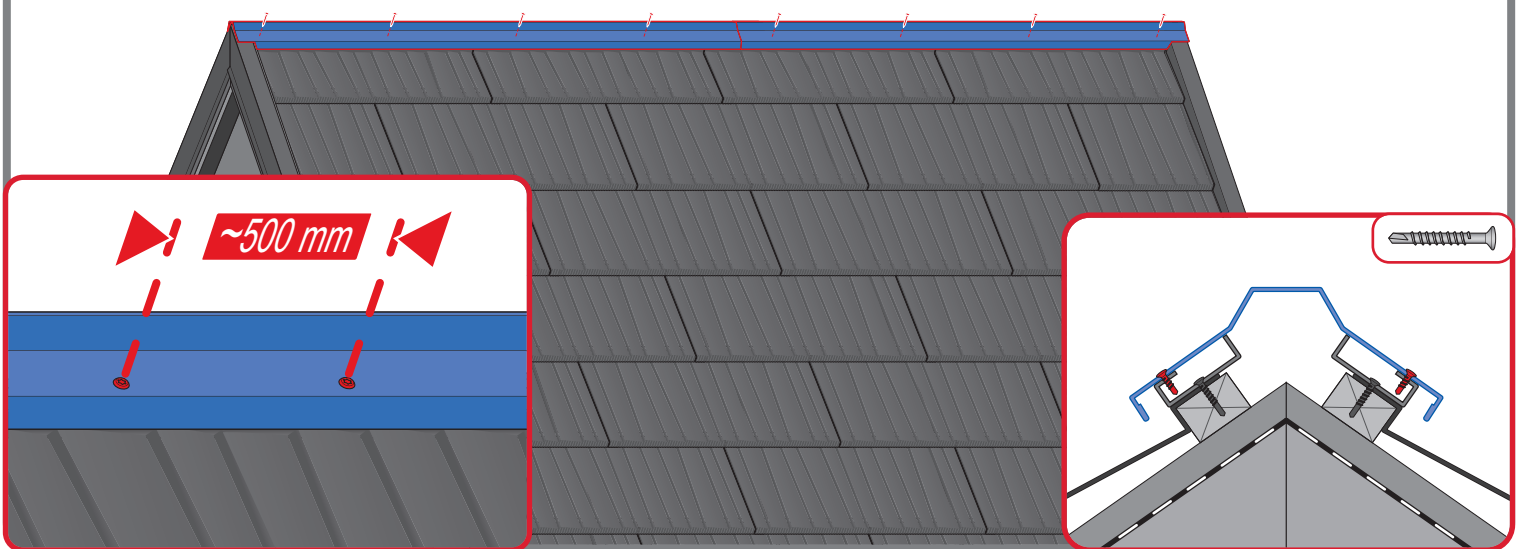

11a

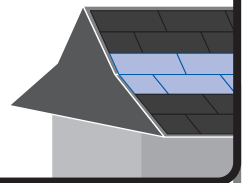

11b

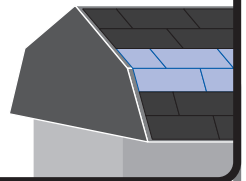

12a

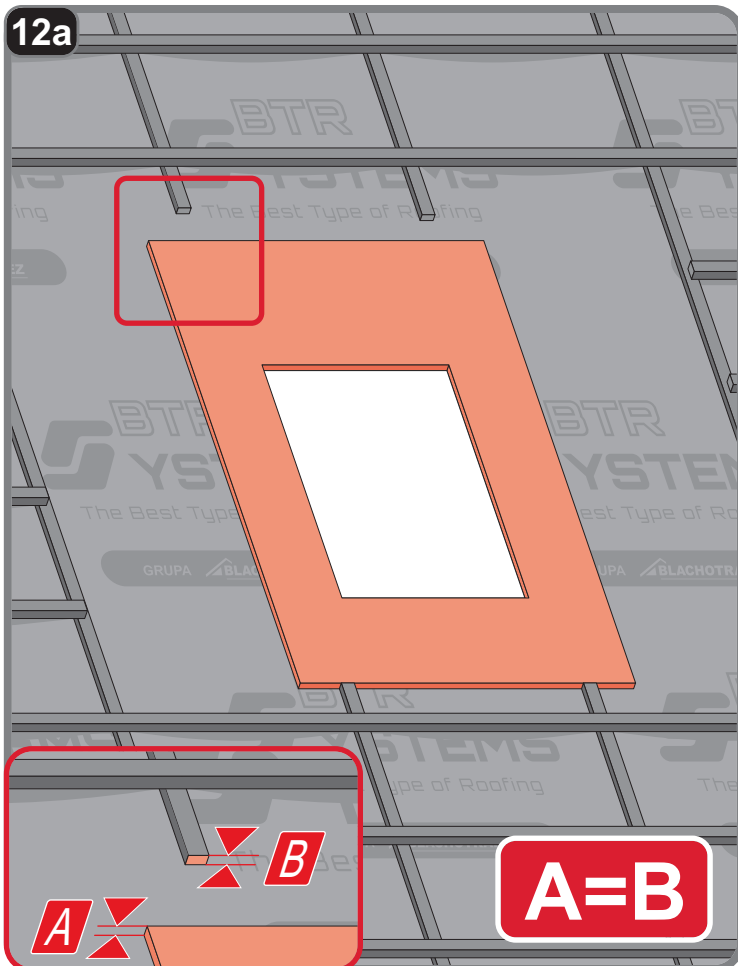

12b

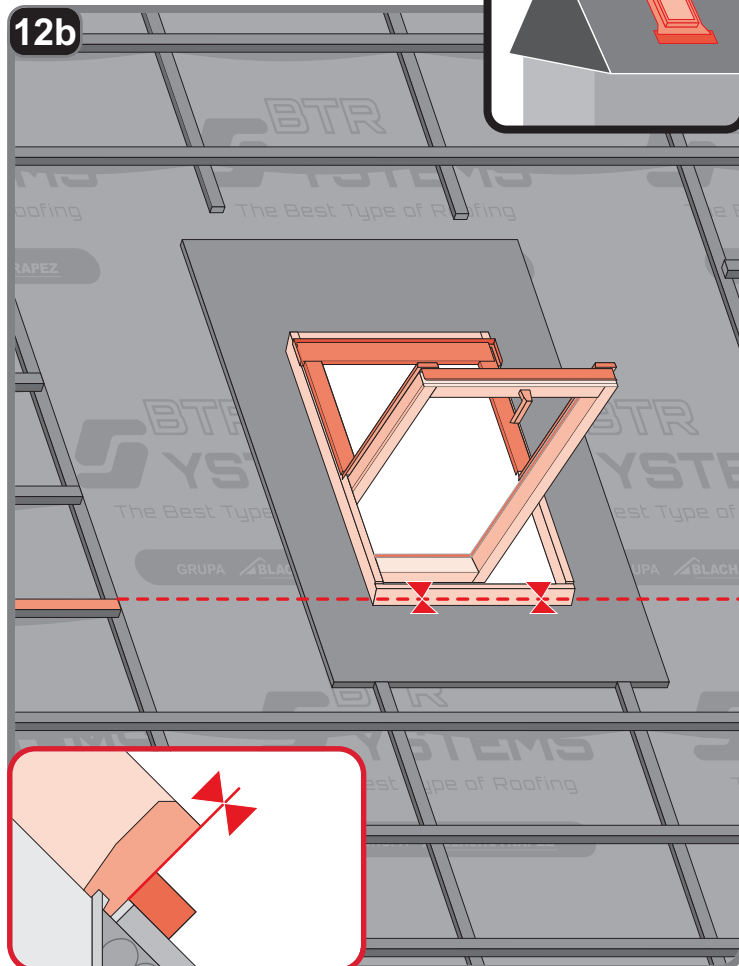

12c

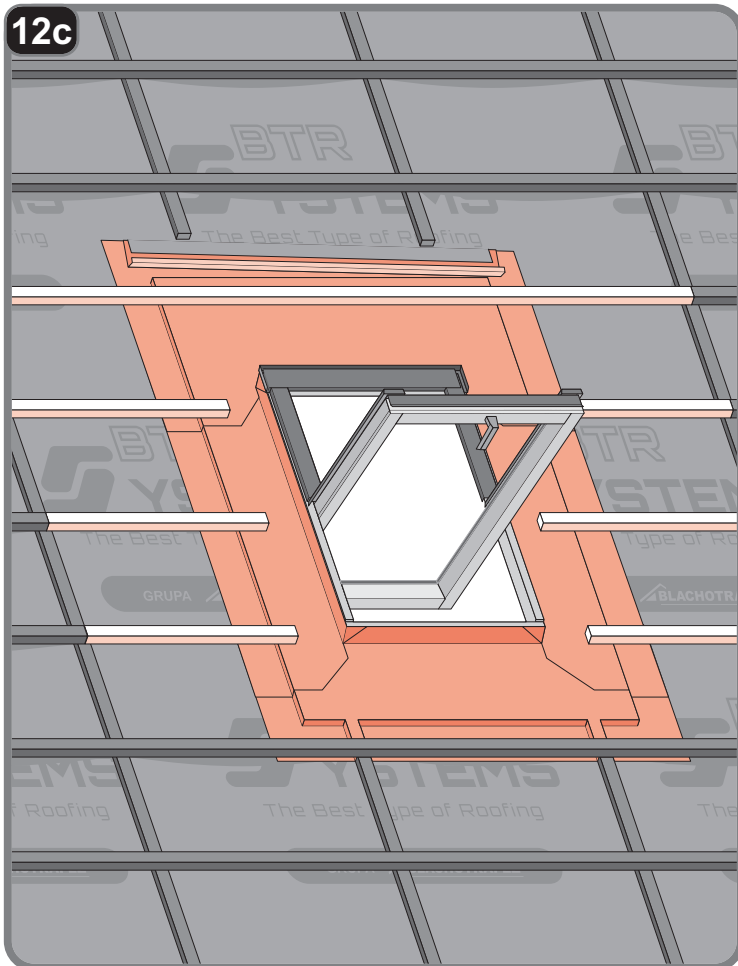

12d

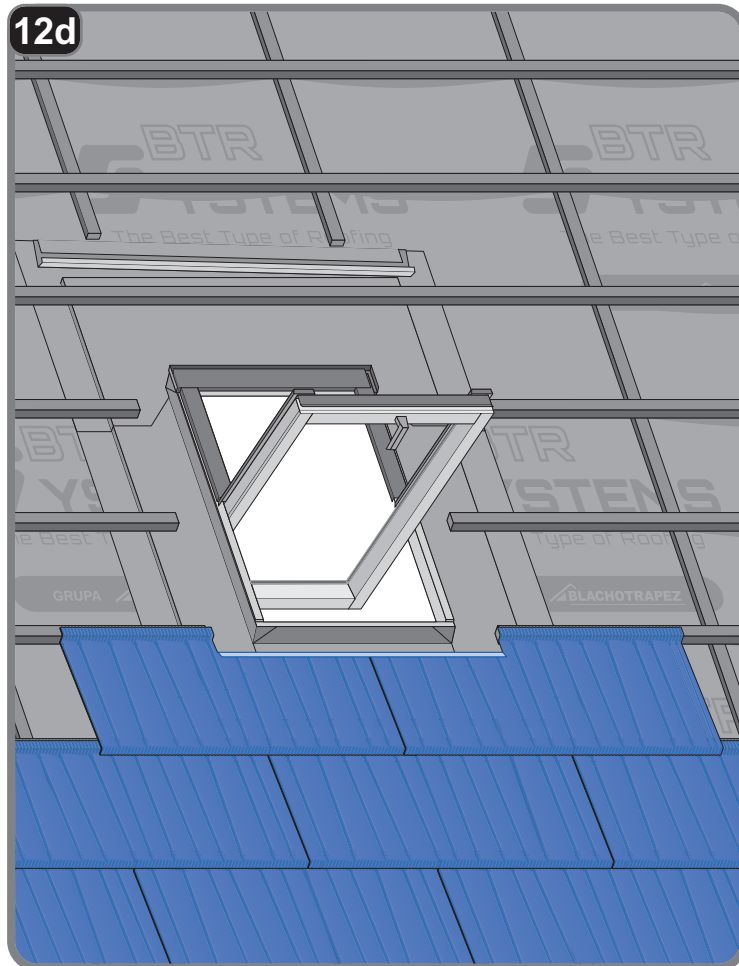

12e

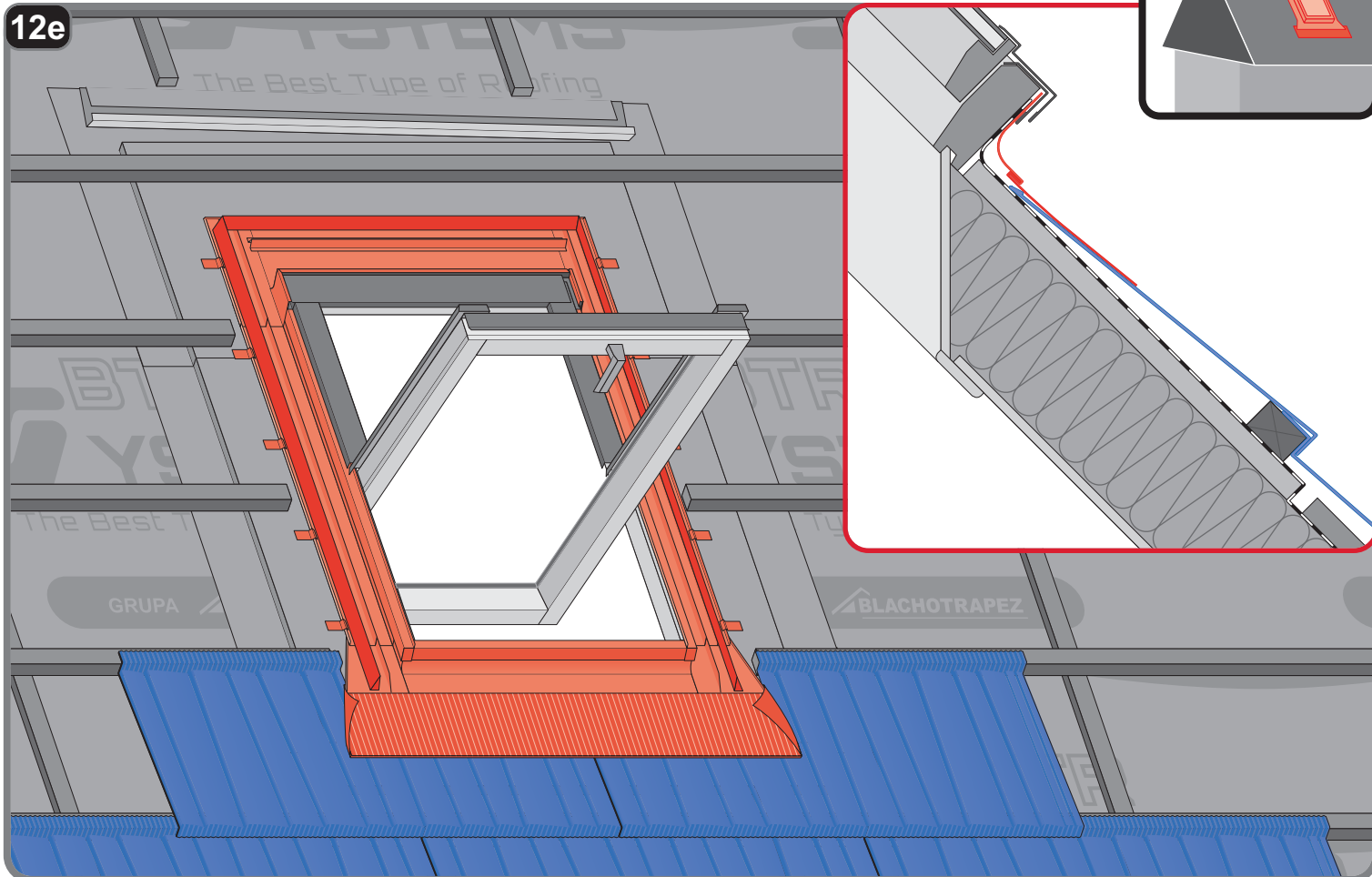

12f

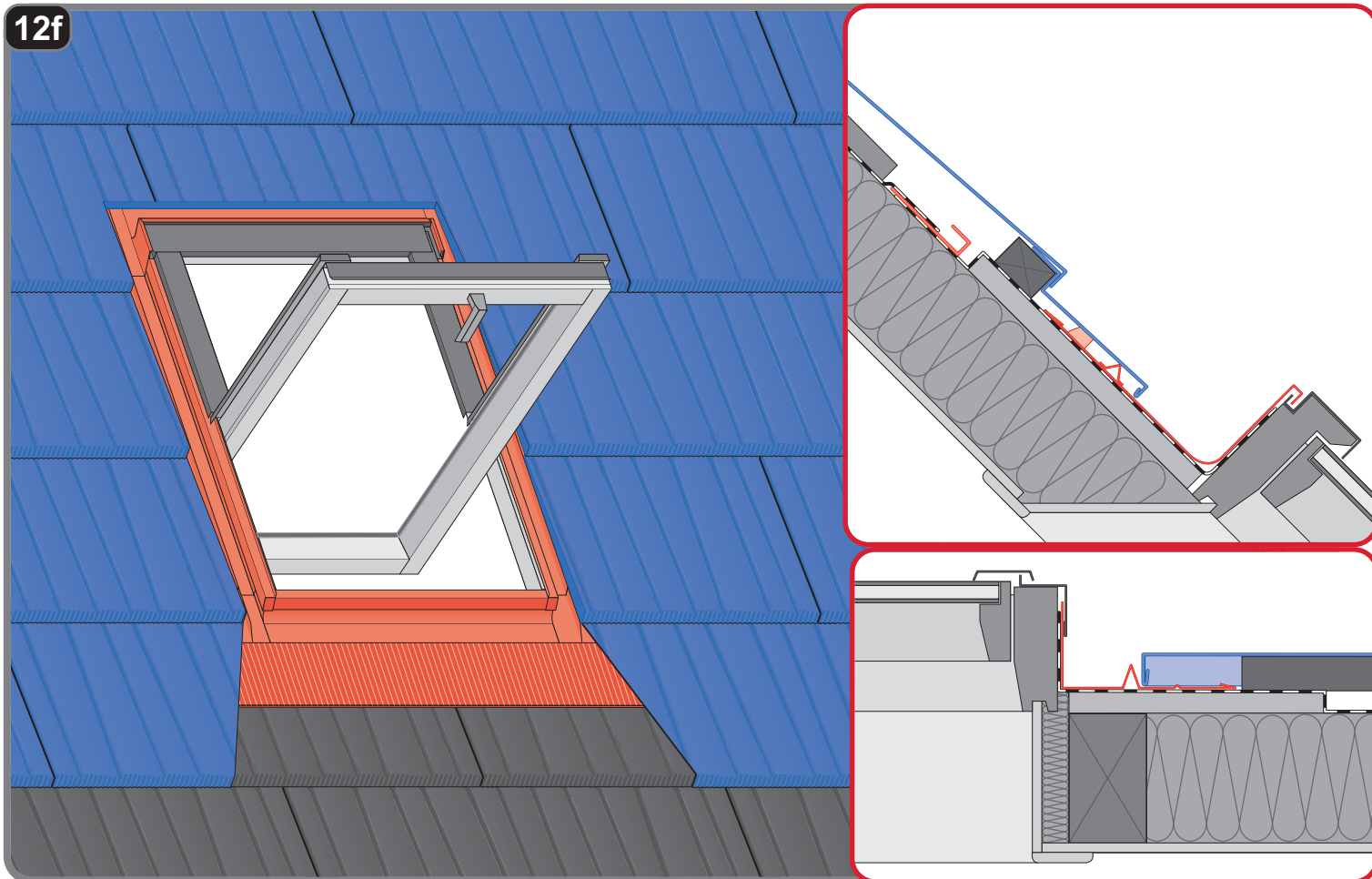



GRUPA



0224

Montaż blach dachowych wymaga wiedzy fachowej, specjalistycznej i doświadczenia. Niniejsza instrukcja jest materiałem poglądowym i nie zwalnia wykonawców z obowiązku przestrzegania zasad sztuki dekarzkiej i norm. Sposoby montażu przedstawione w niniejszej instrukcji mają charakter wskazówek ogólnych. Wymagana metoda montażu może różnić się od wskazanej w instrukcji w zależności od typu dachu lub rozwiązań regionalnych. Aby skorzystać z ogólnych instrukcji i wskazówek montażu, postępuj zgodnie z wytycznymi projektanta lub skontaktuj się z naszym działem wsparcia technicznego. Doświadczeni wykonawcy posiadają indywidualne rozwiązania, które Spółka Blachotrapez akceptuje.