

I n s t r u k c j a M o n t a ż u

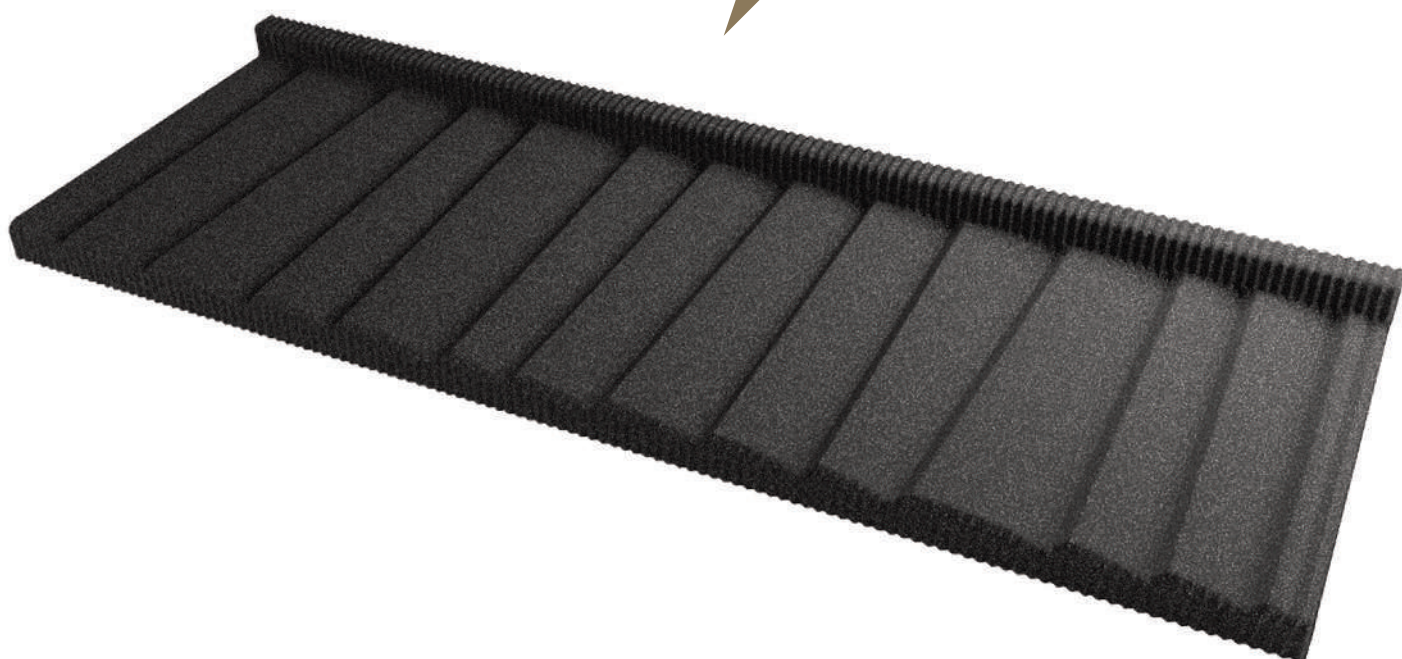

GRUPA  **BLACHOTRAPEZ**

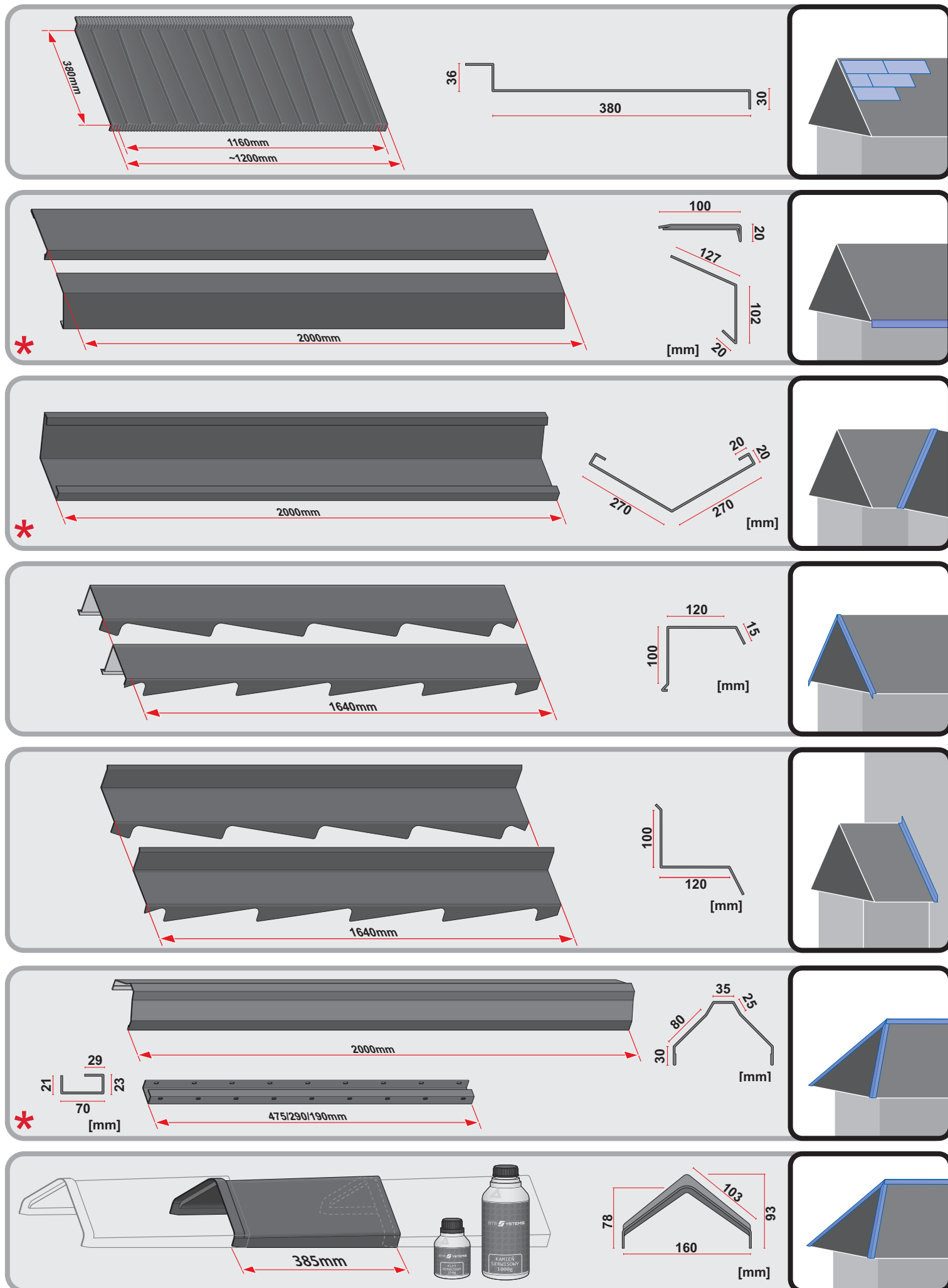



* Obróbki z gwiazdką wykonane na zamówienie z blachy Pladur® Relief Textured Wood.

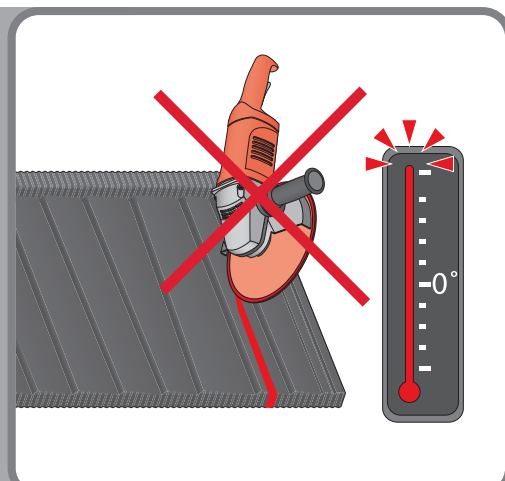
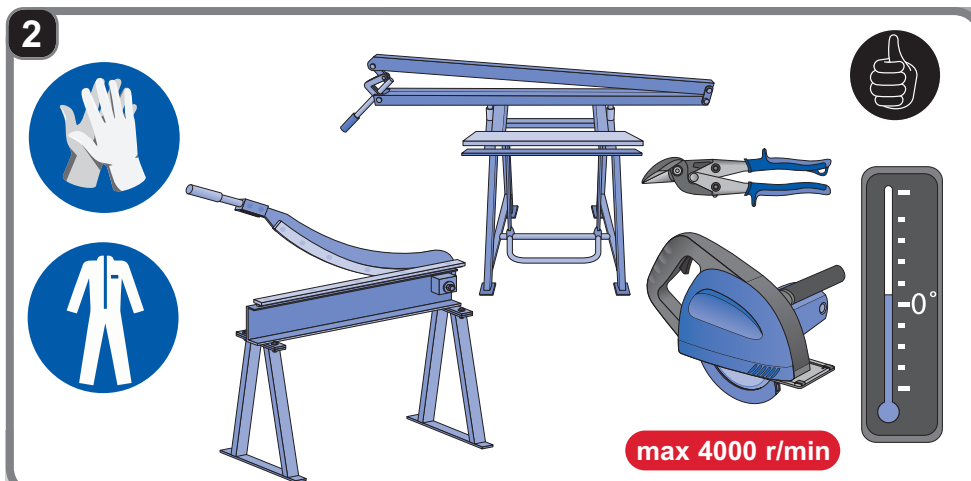
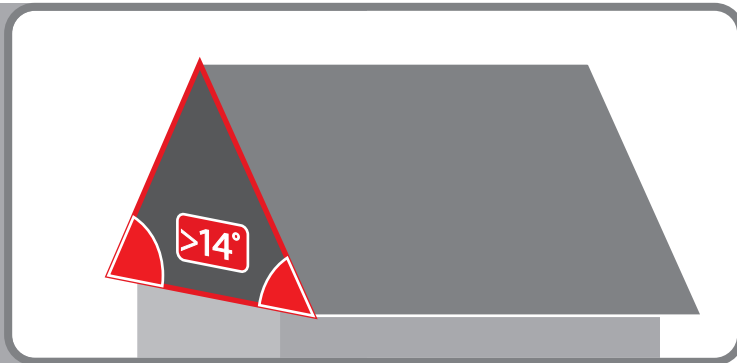
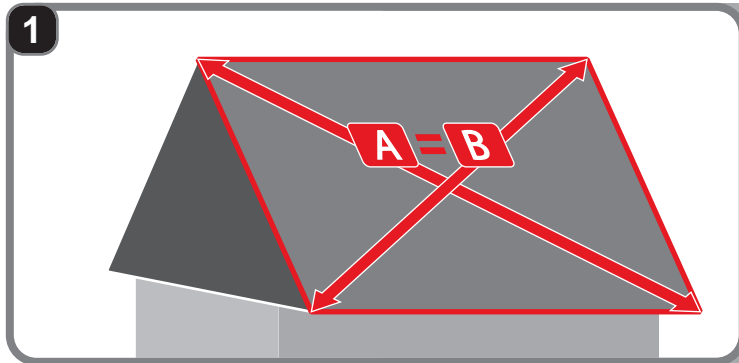

Nie zaleca się montażu w temperaturze poniżej 5°C. Nie należy montować, wyginać ani chodzić po arkuszach, gdy są zawilgocone. Powłoki paneli oraz akcesoriów BTR SYSTEMS są bardziej narażone na pęknięcia podczas pracy w niskich temperaturach otoczenia. Dlatego też wszelkie prace związane z cięciem i wyginaniem najlepiej wykonywać z produktów składowanych w suchym i ciepłym miejscu.

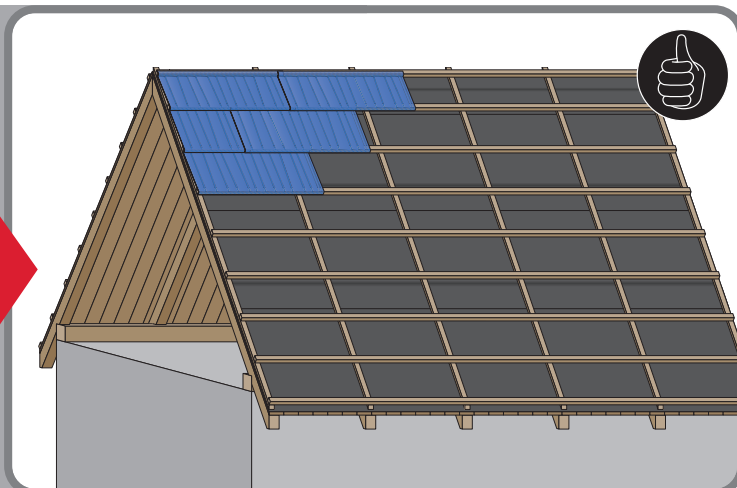
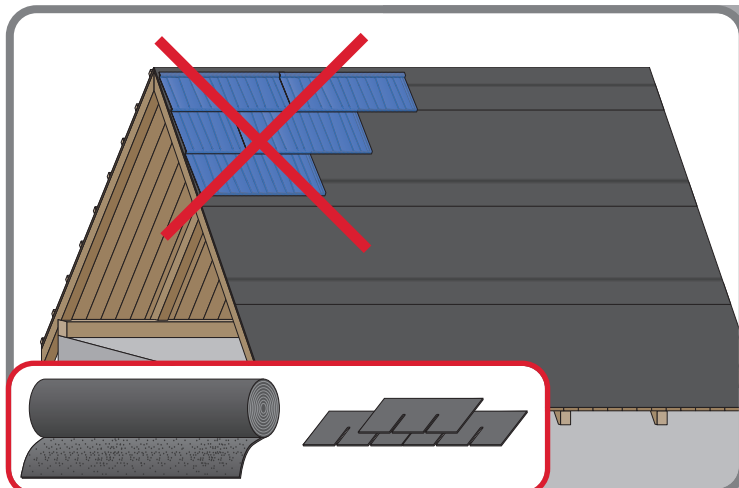
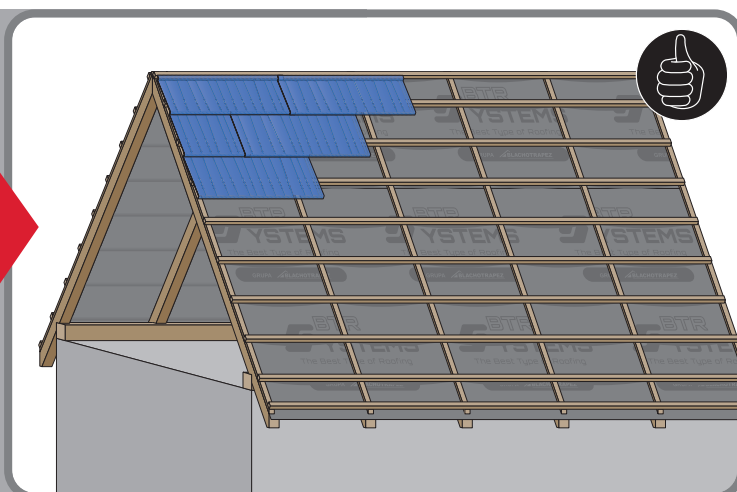
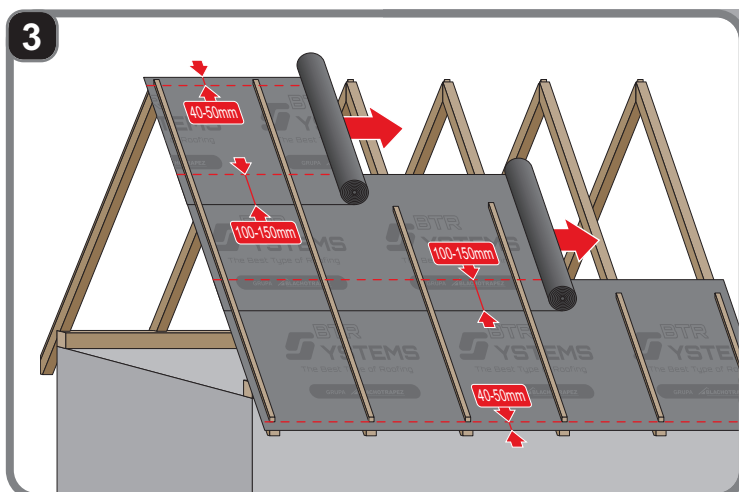

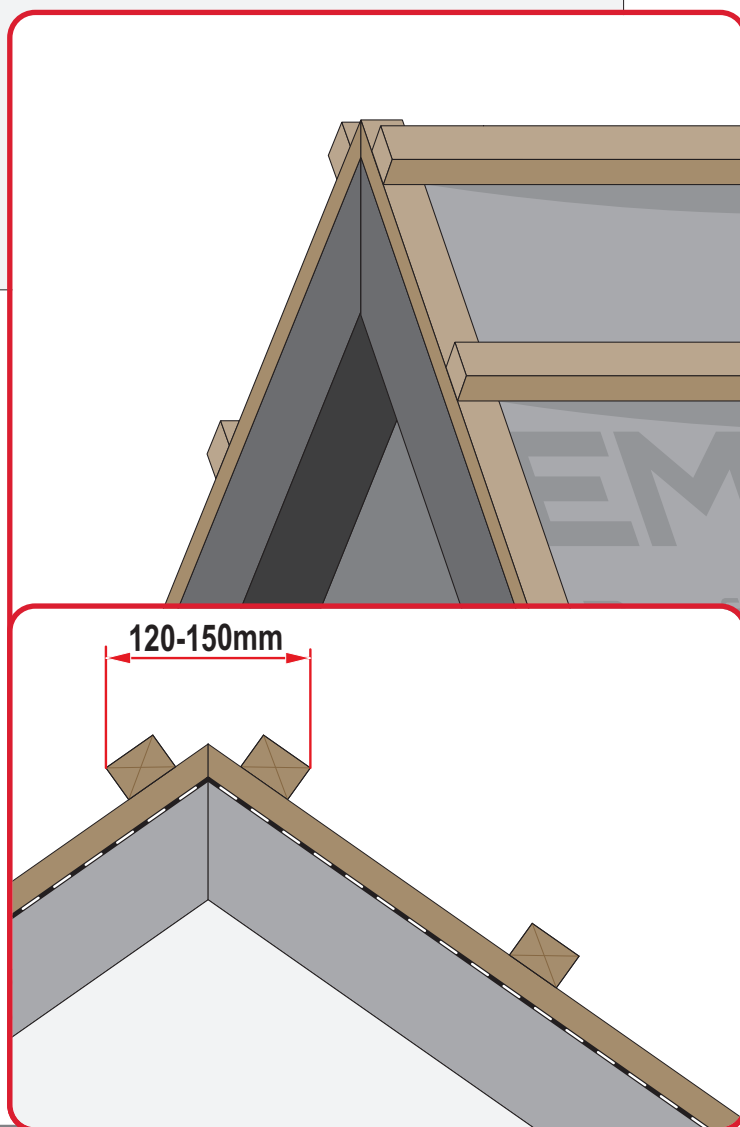
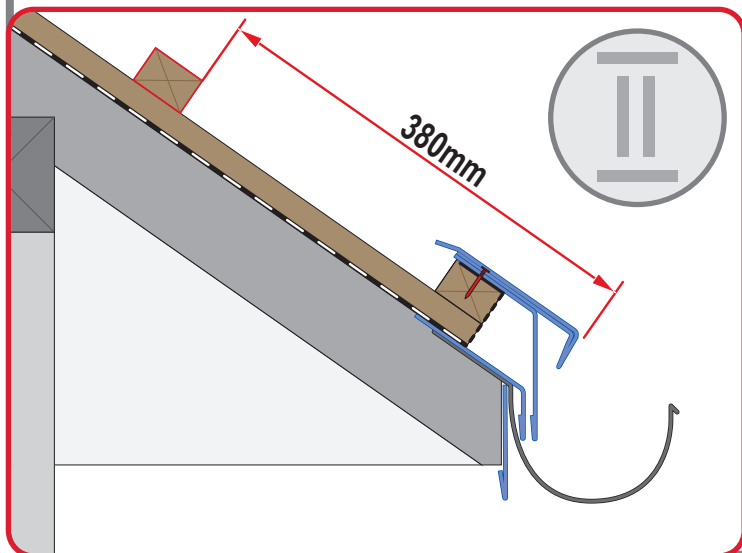
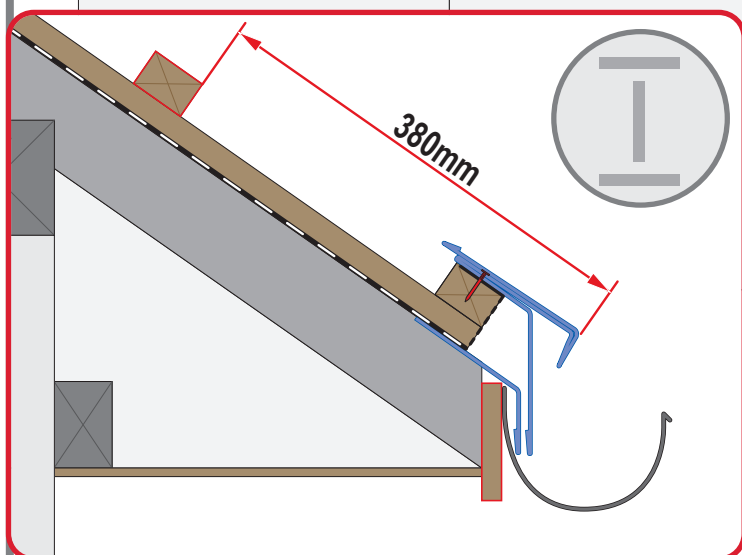
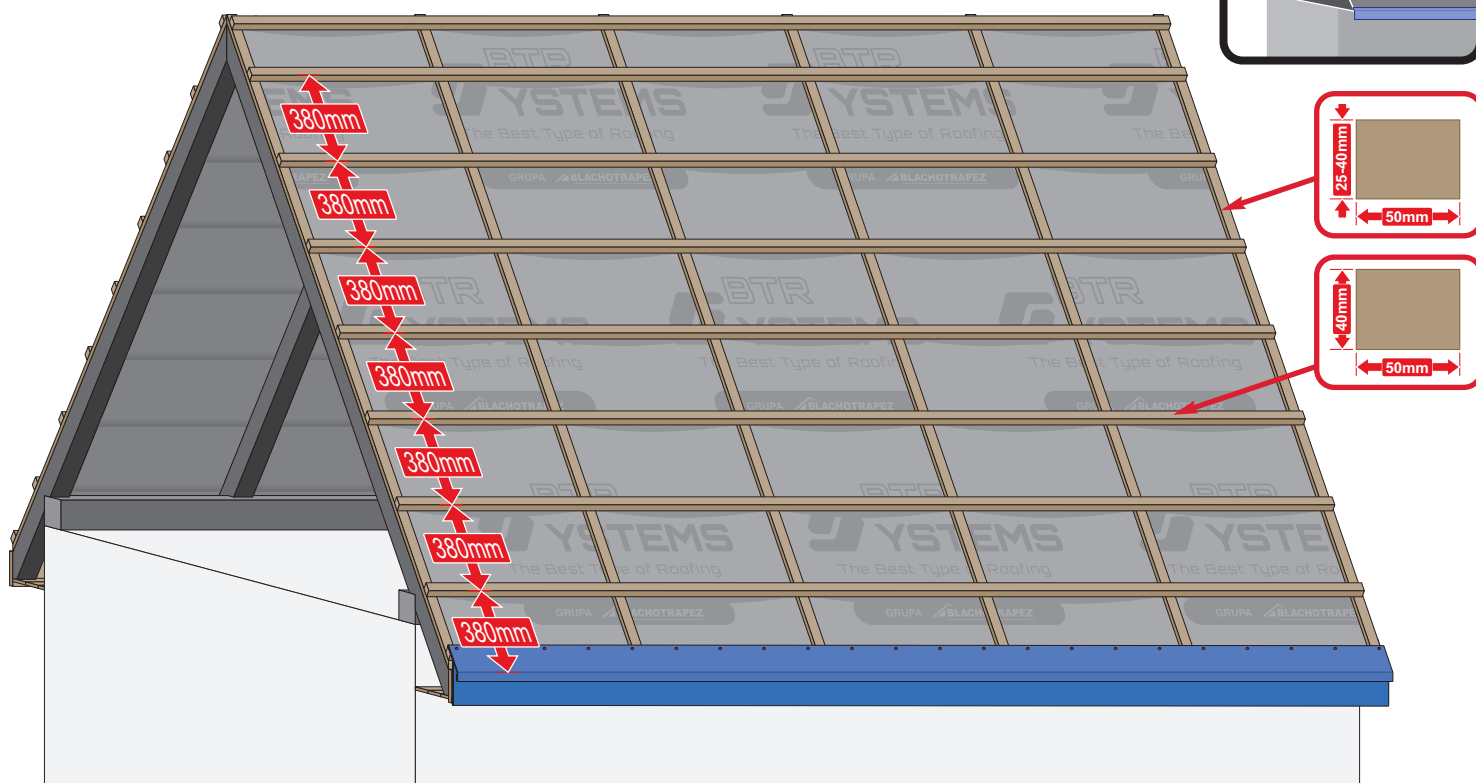

5a

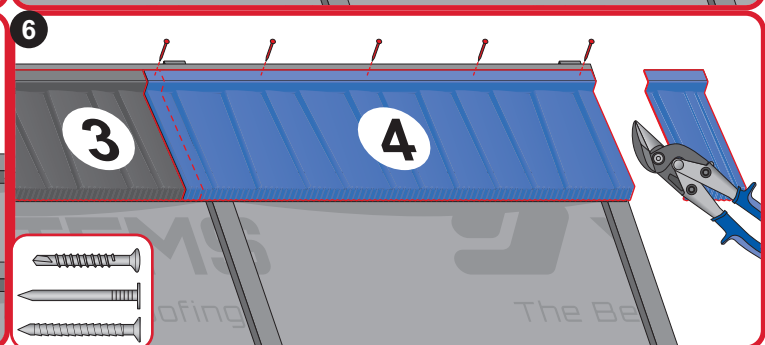
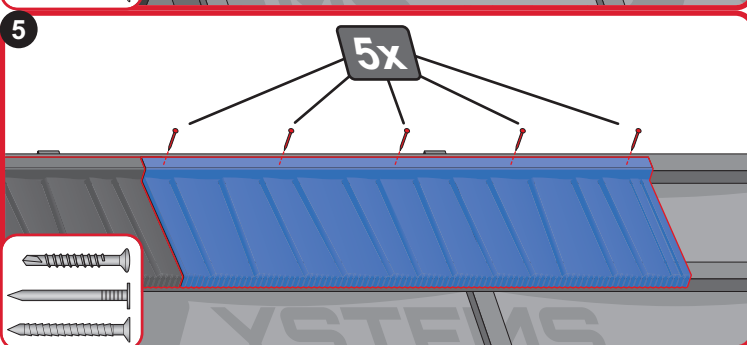
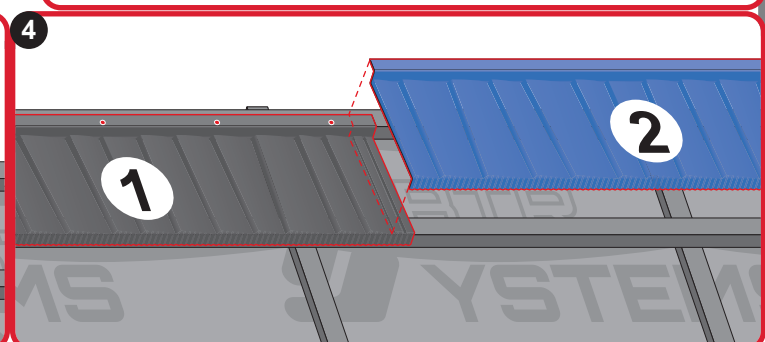
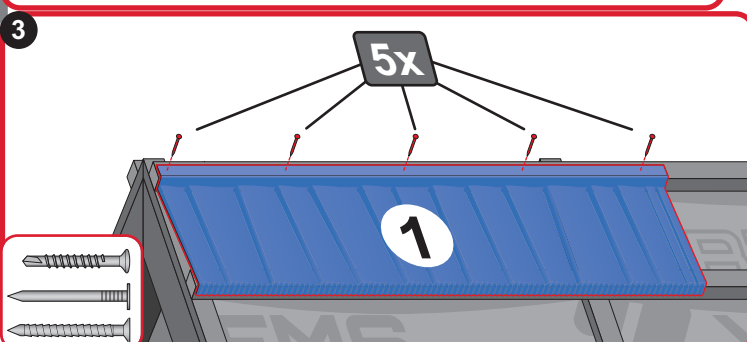
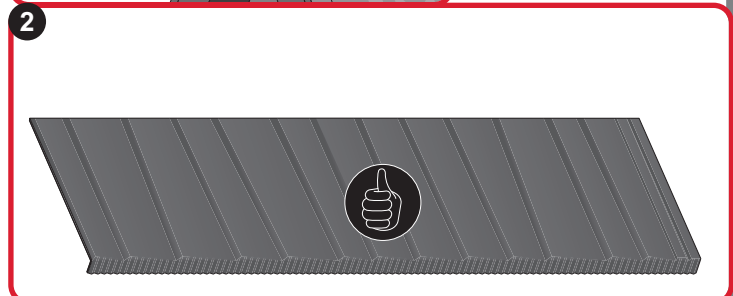
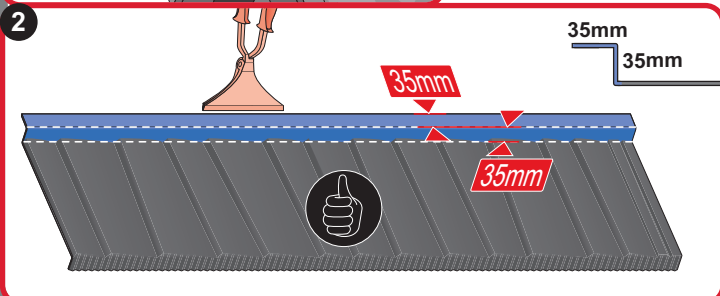
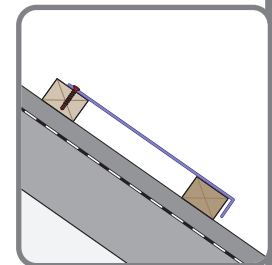
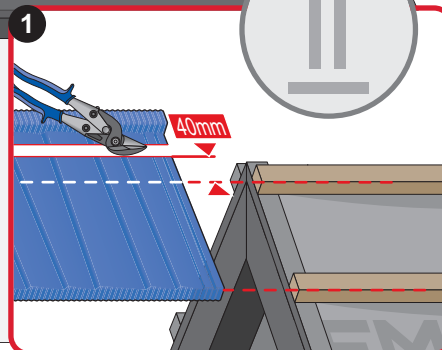
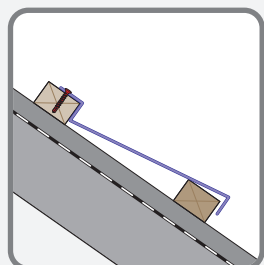
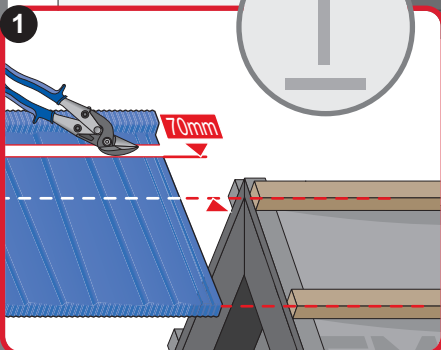
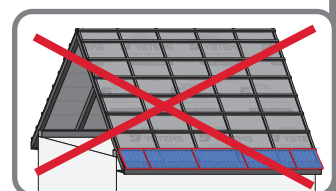
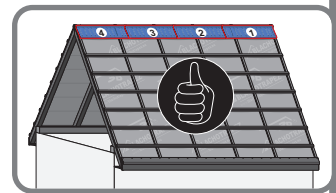
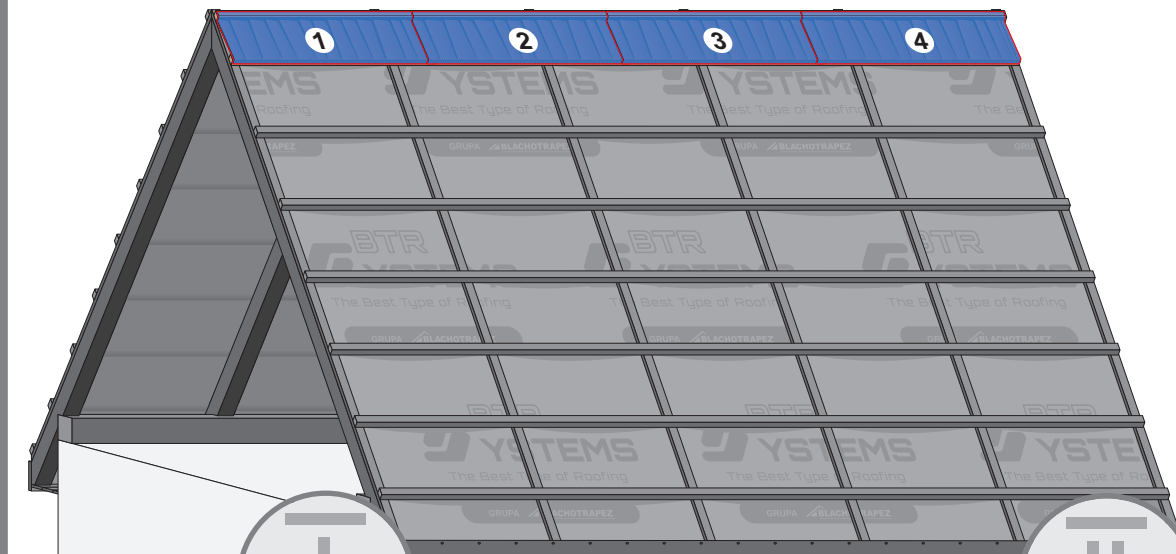
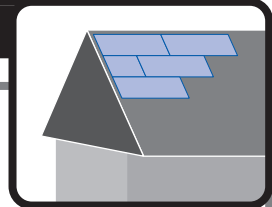

5b

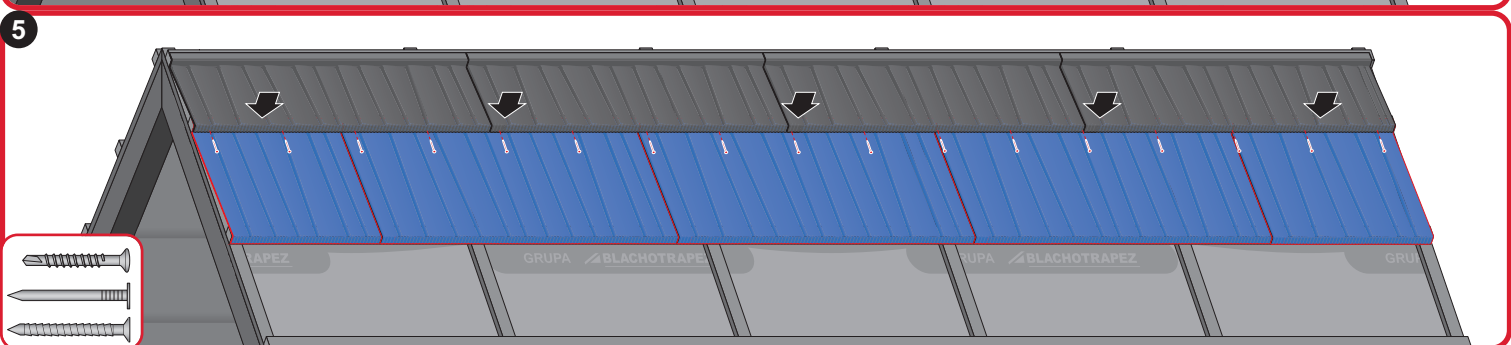
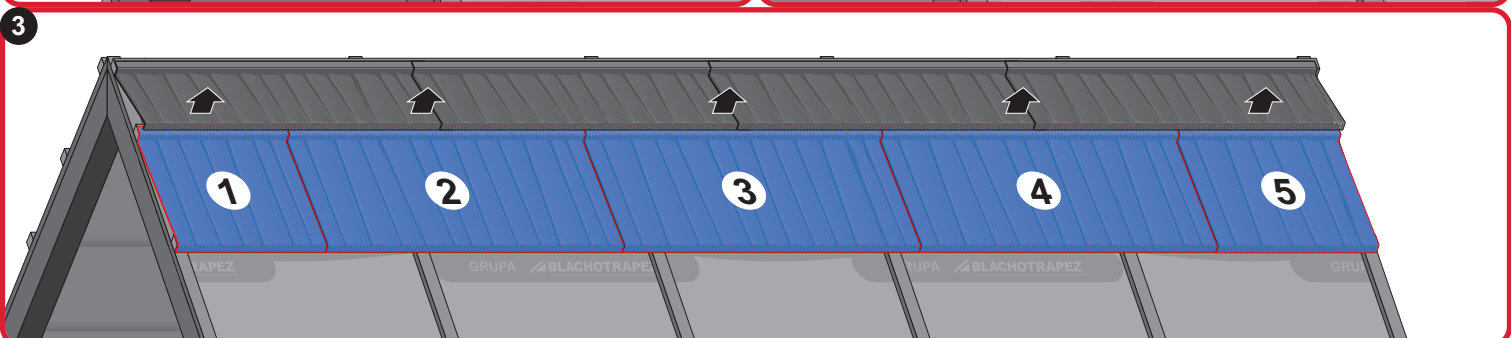
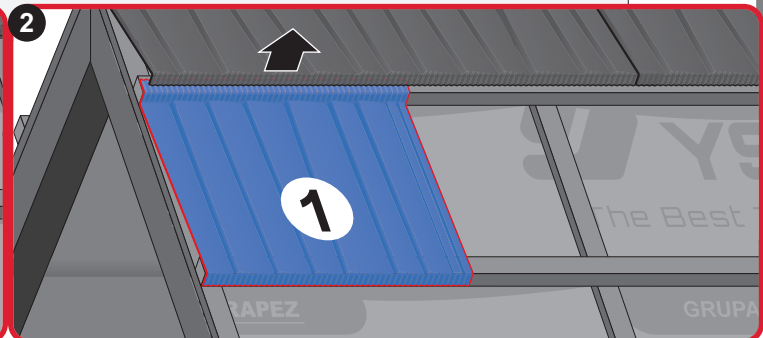
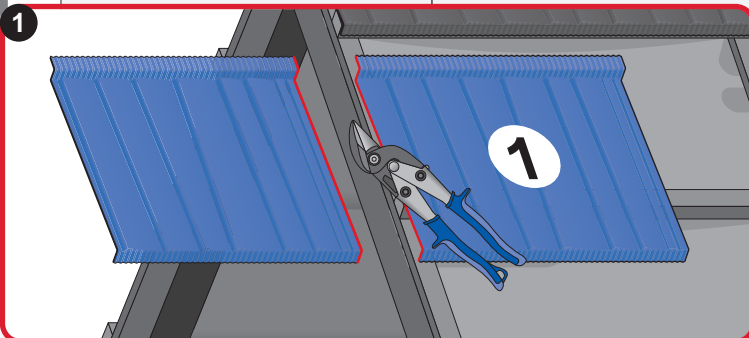
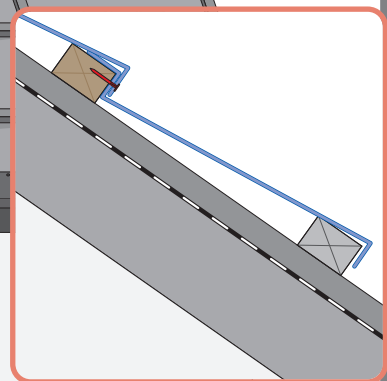
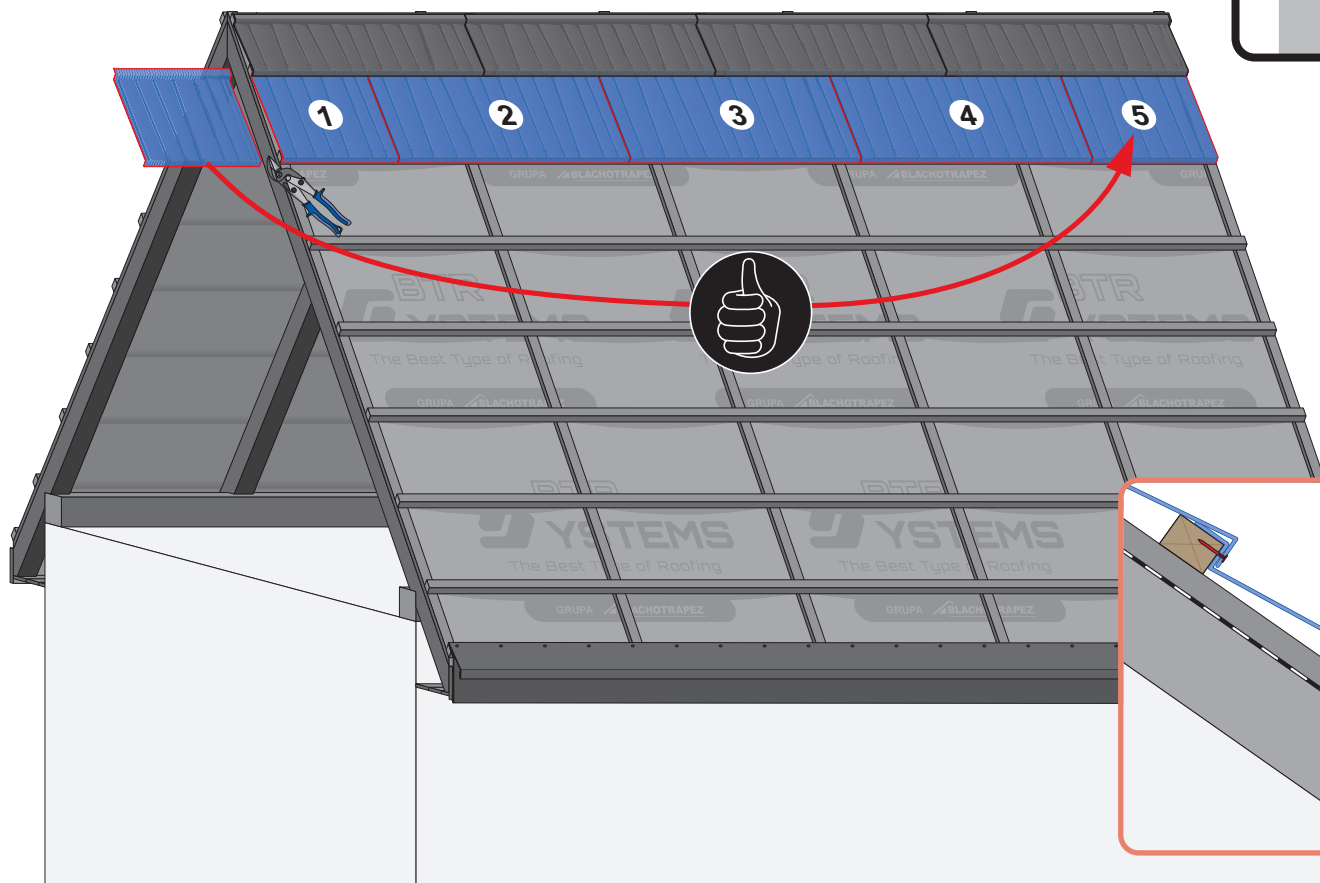
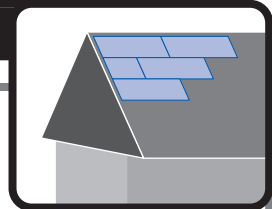

5c

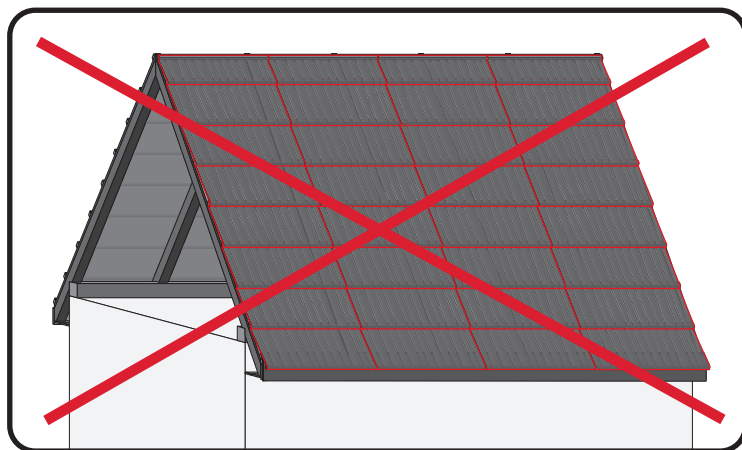
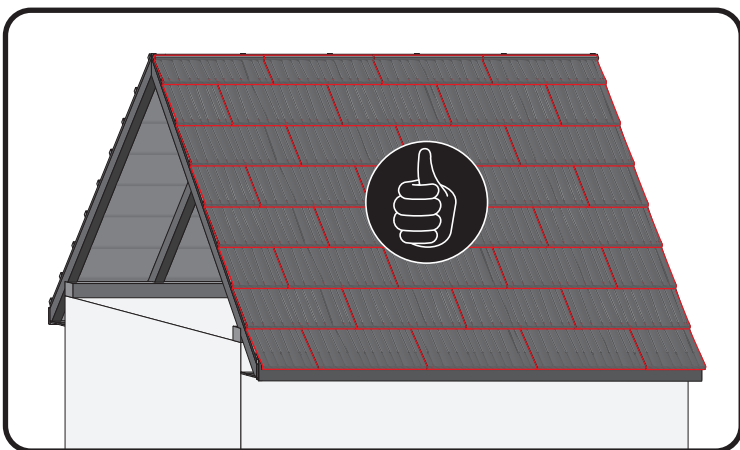
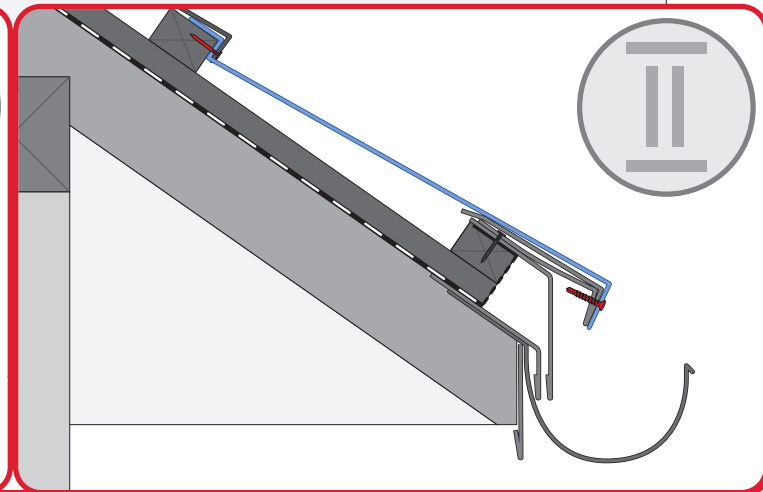
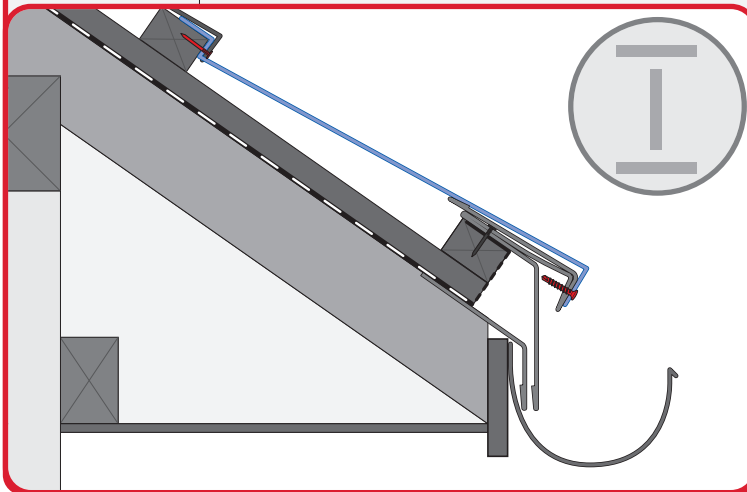
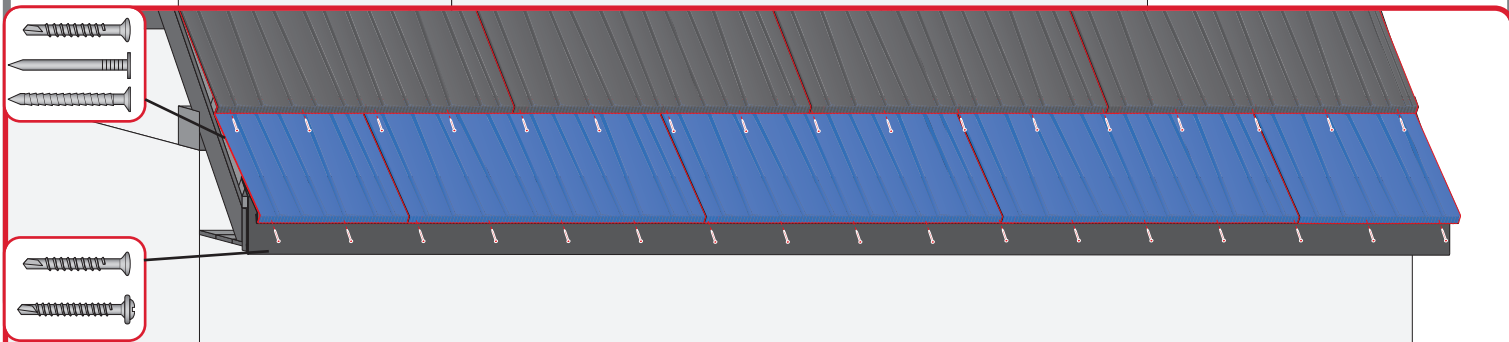
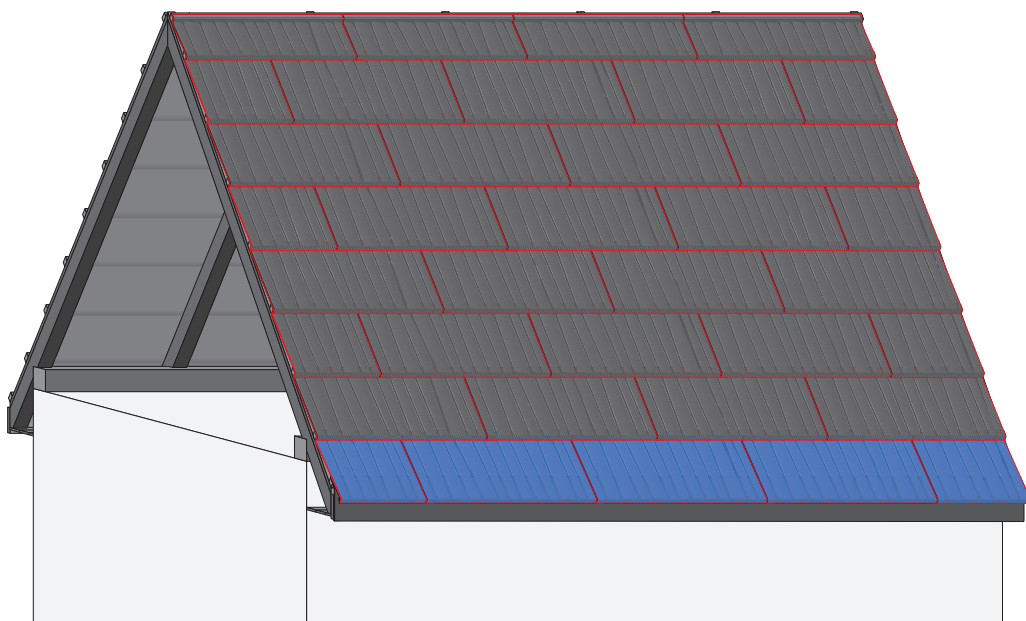
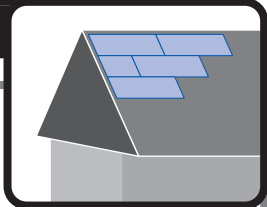

6a

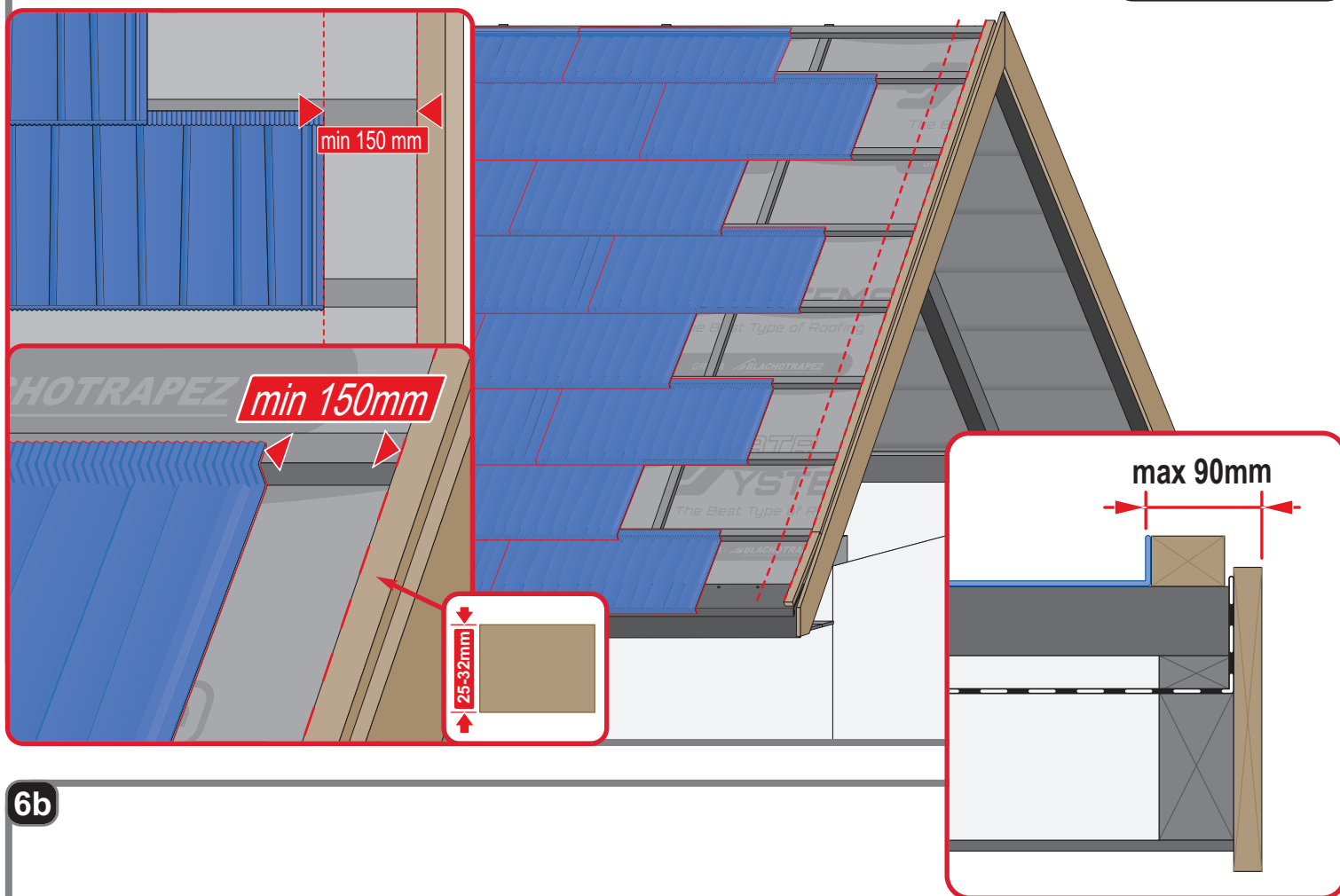

6b

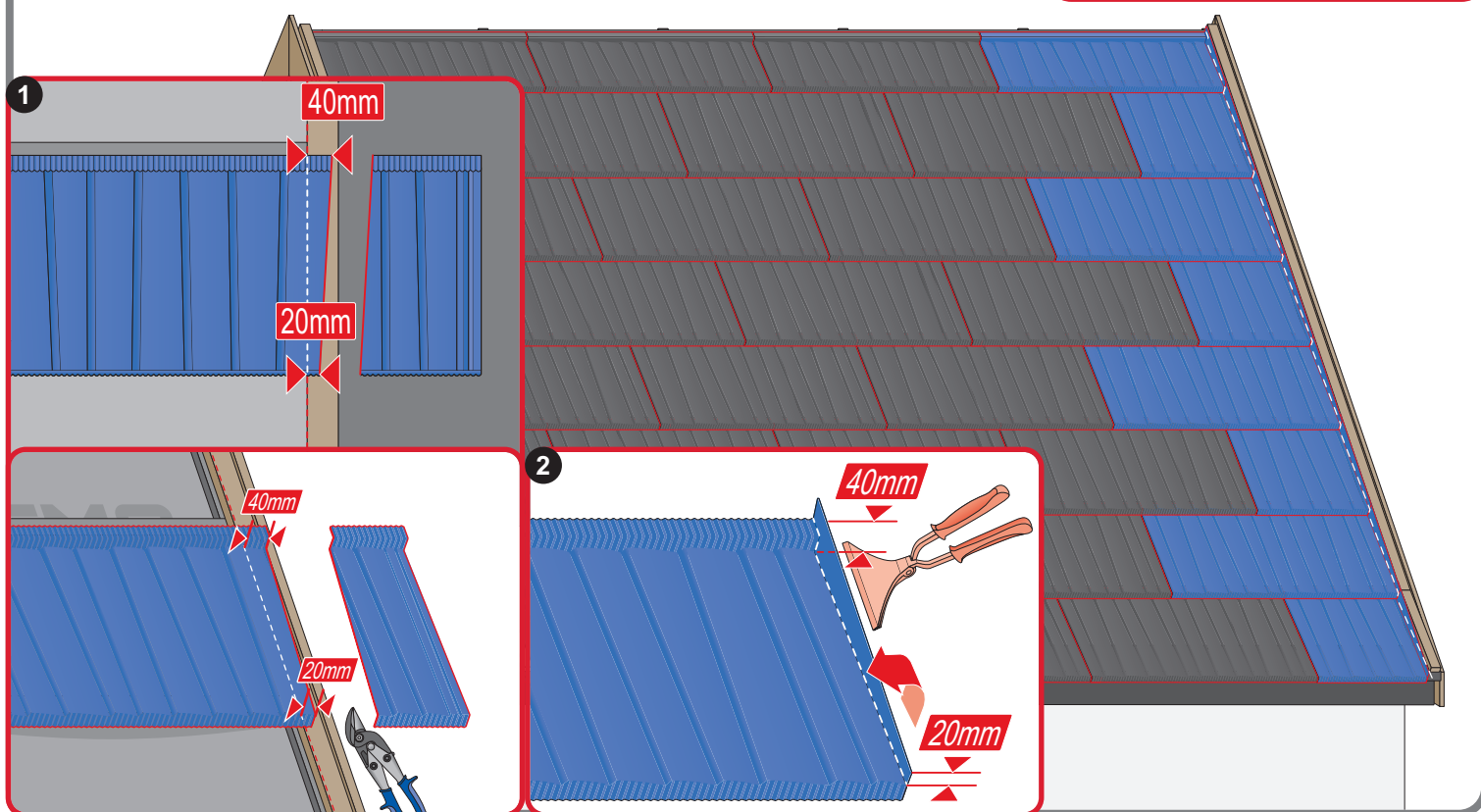

6c

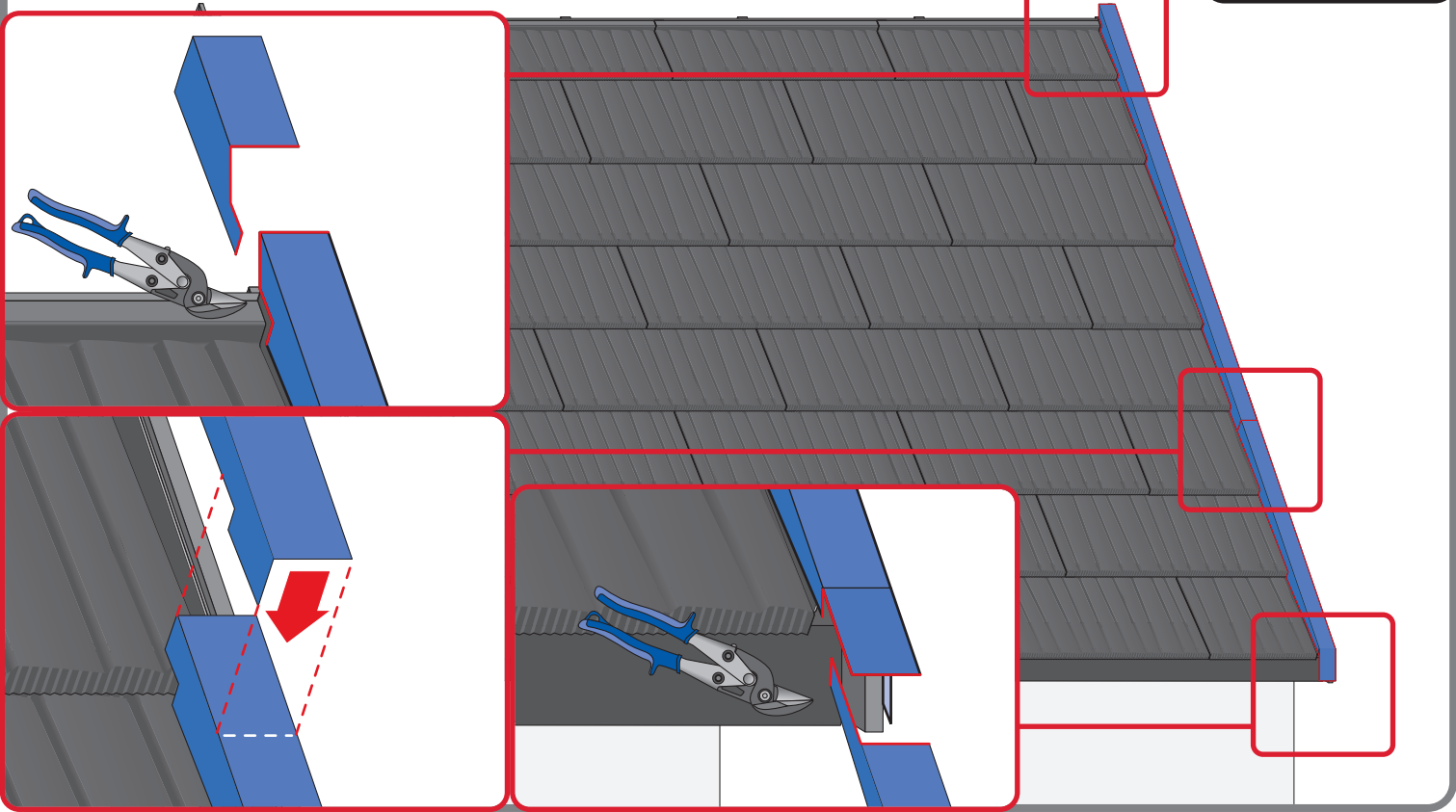
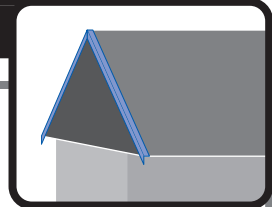

6d

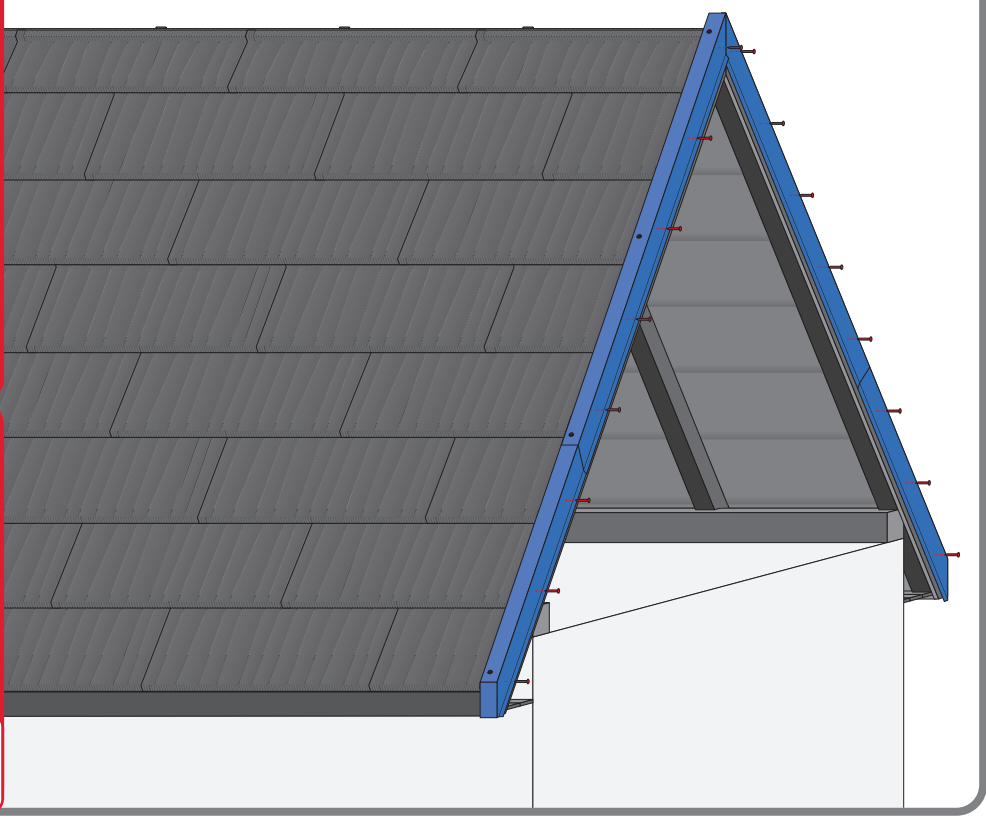
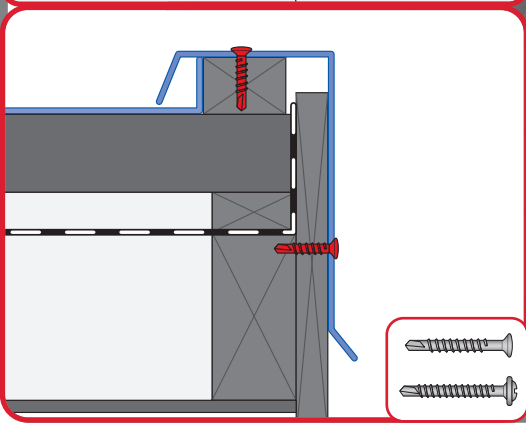
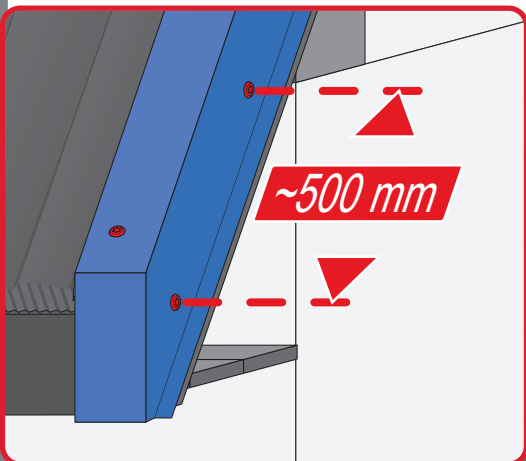

7a

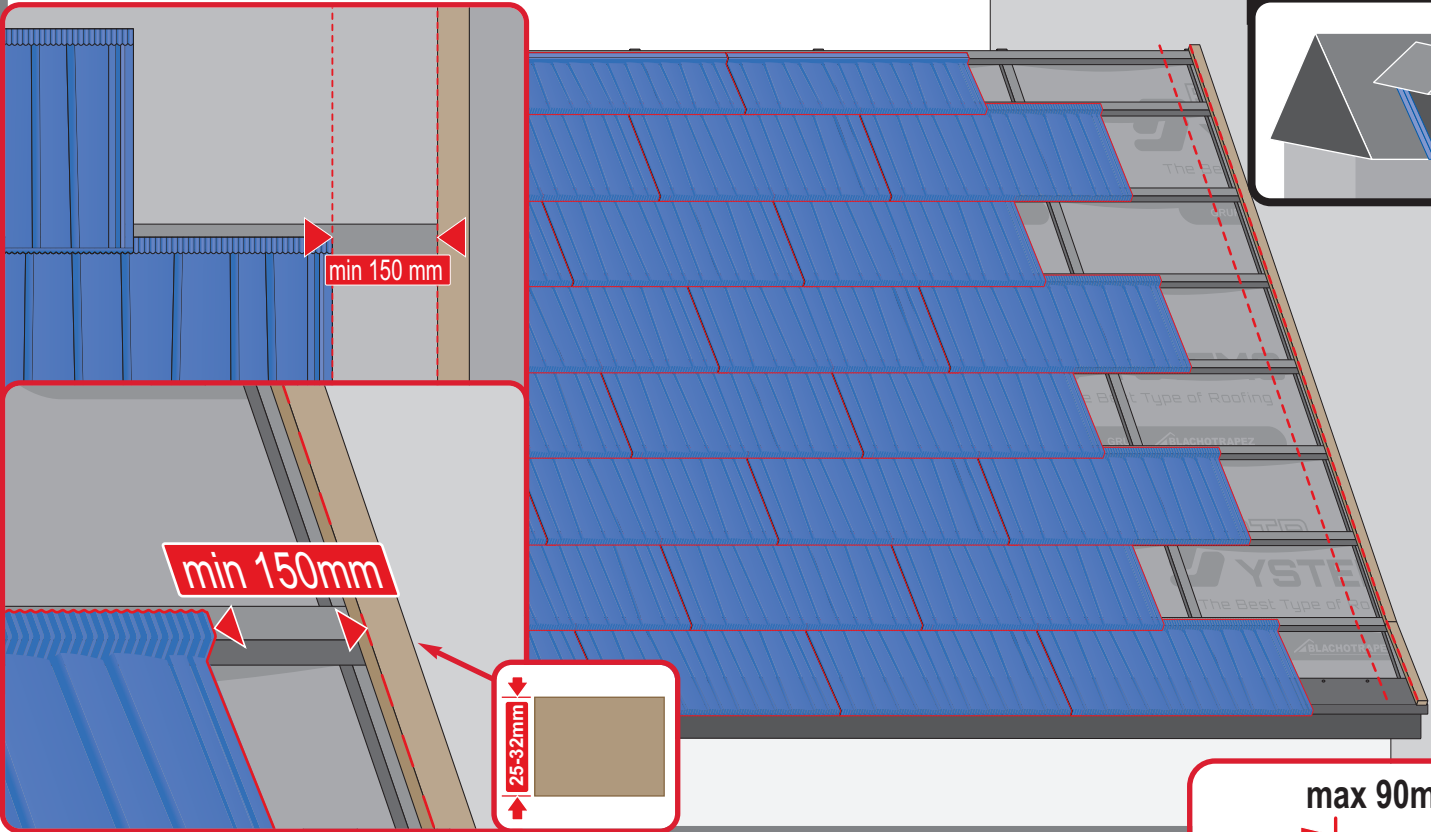

7b

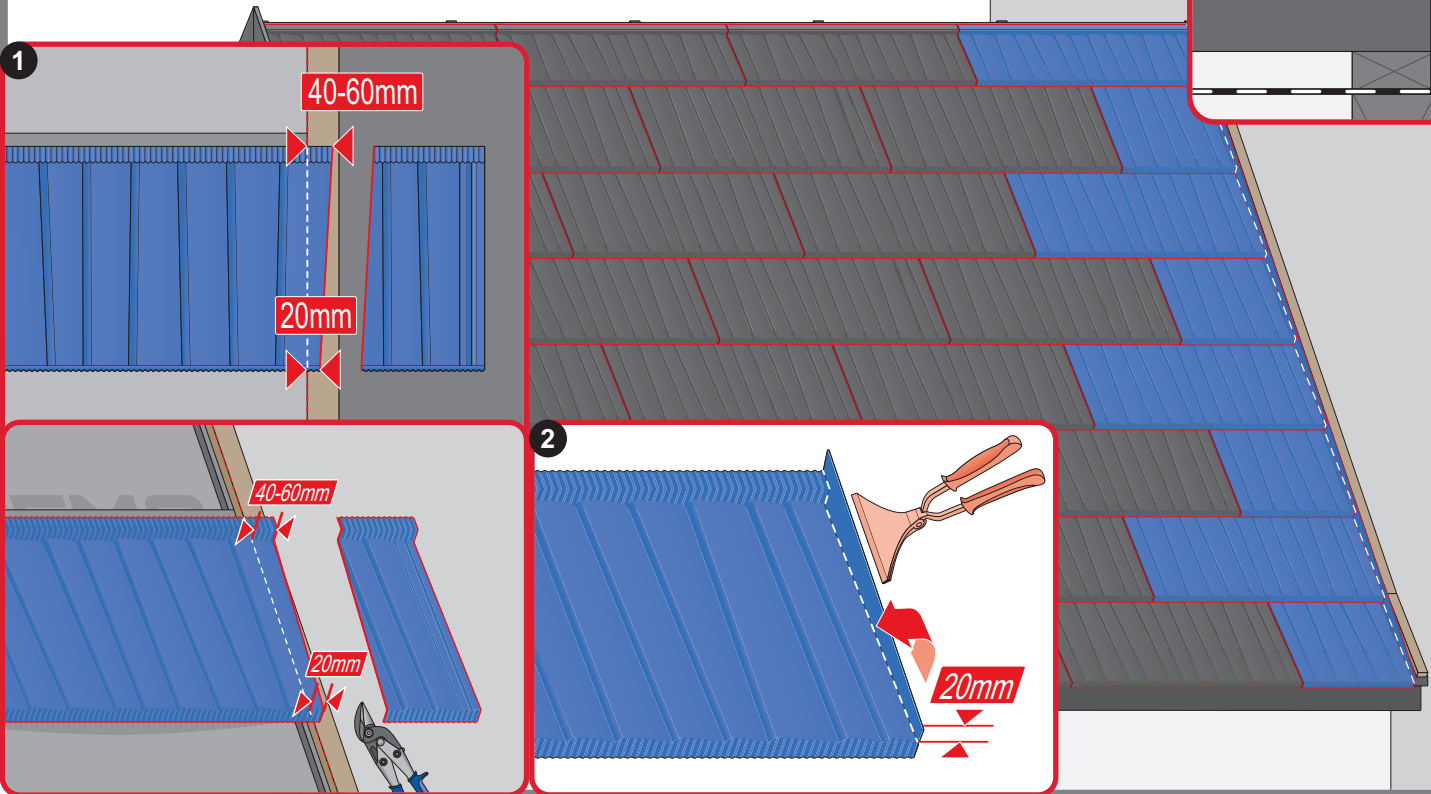

8a

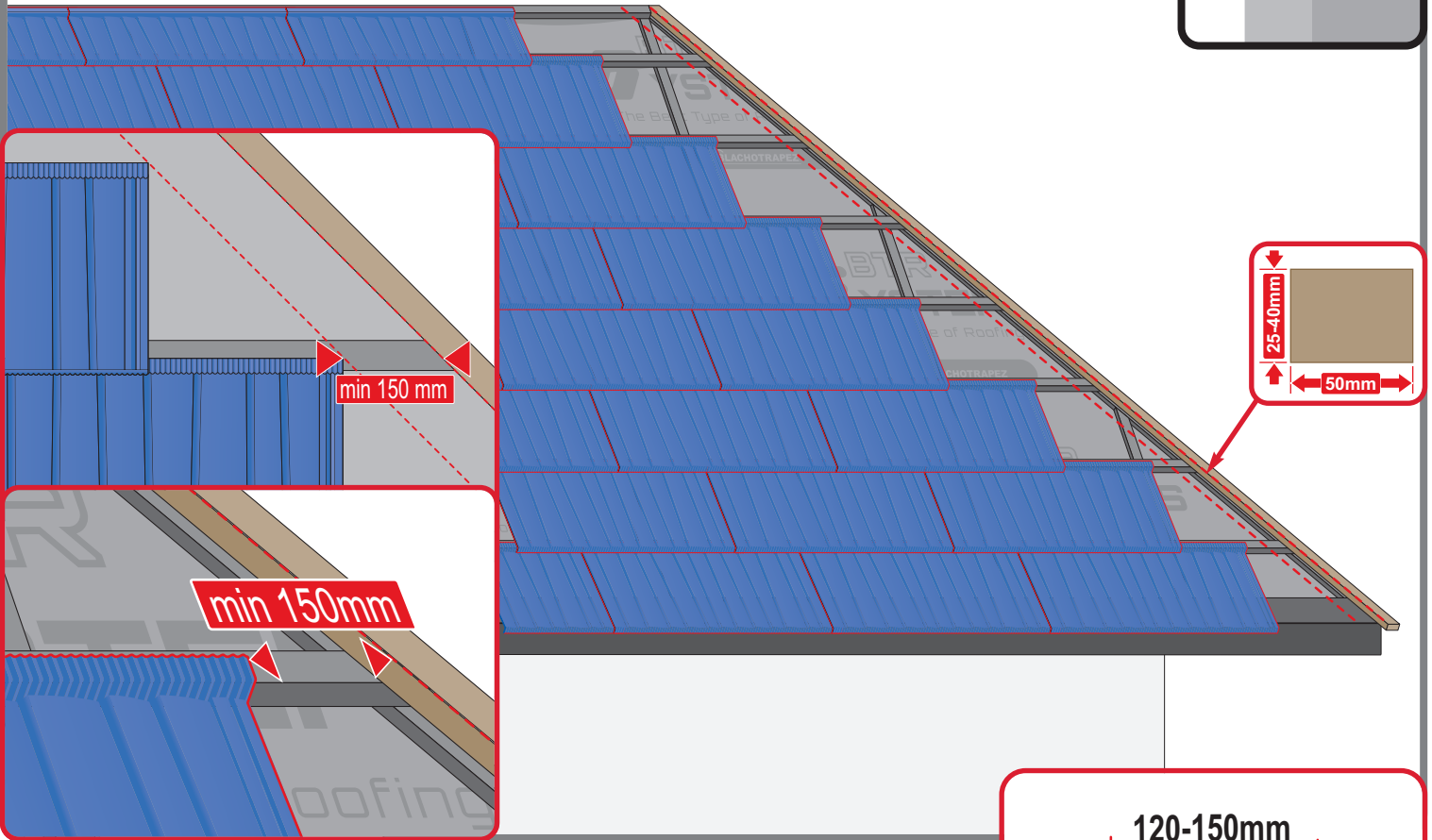

8b

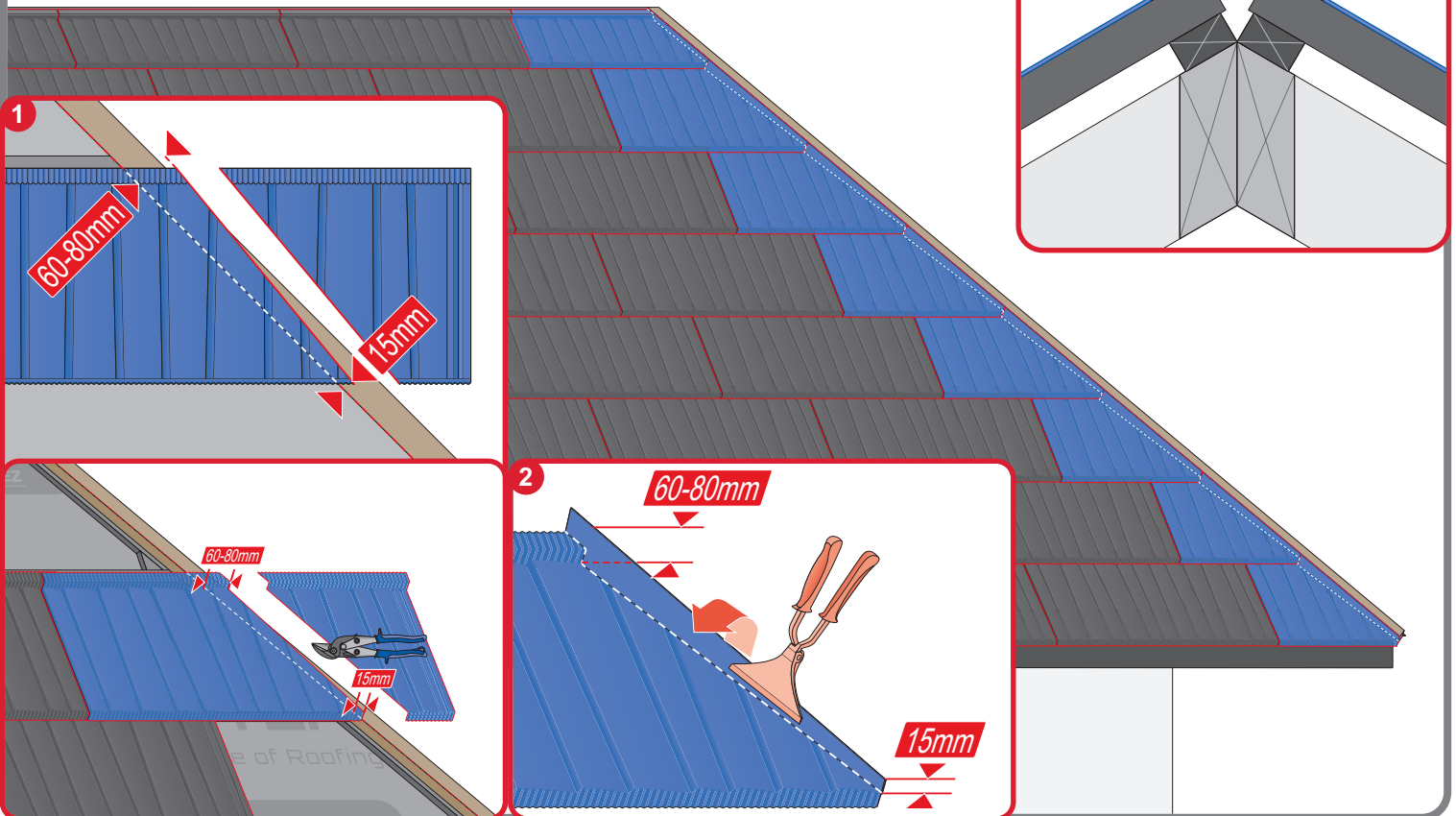

8c

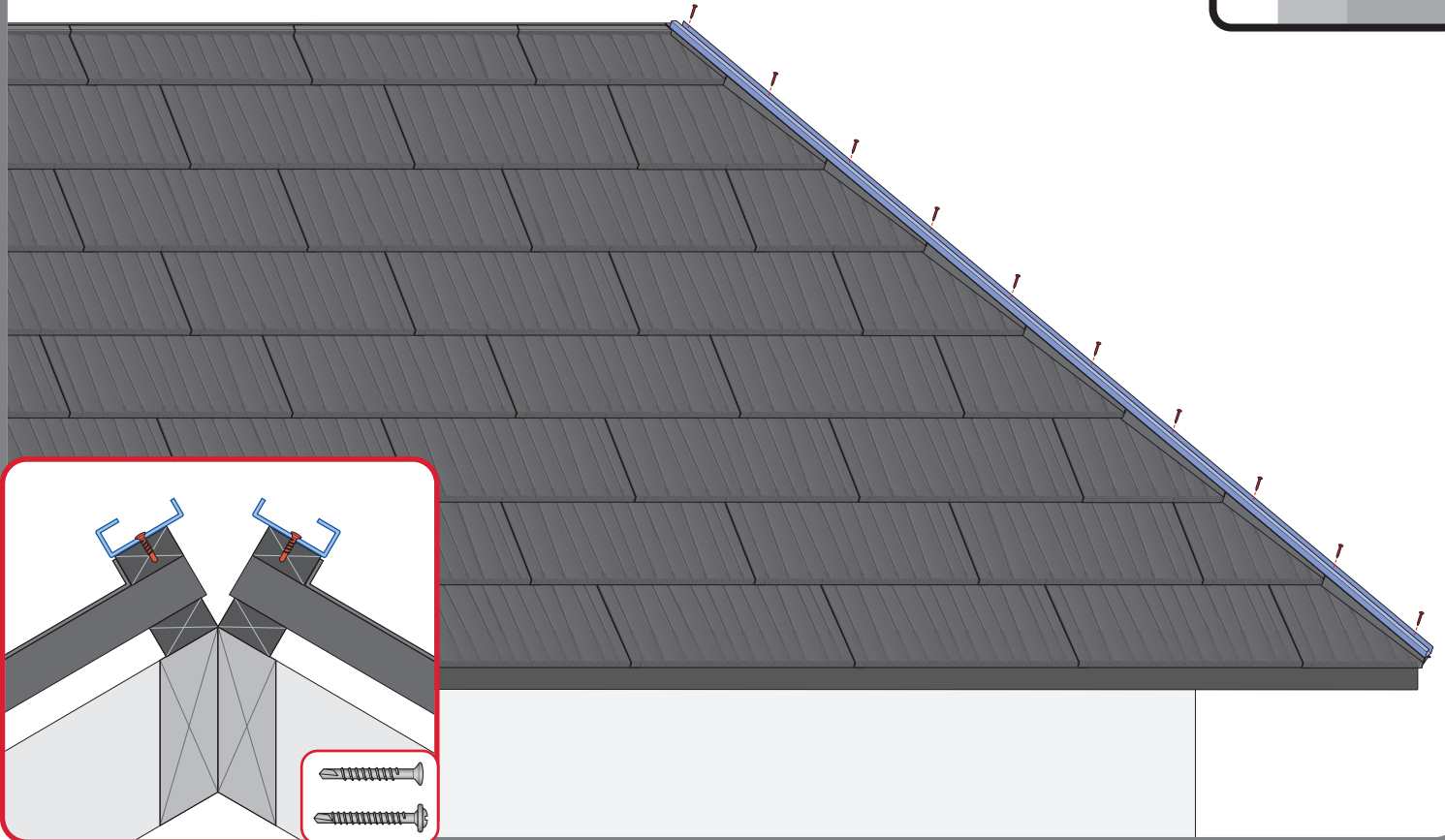
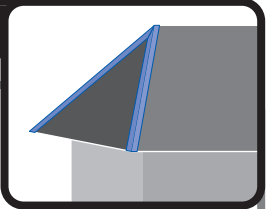

8d

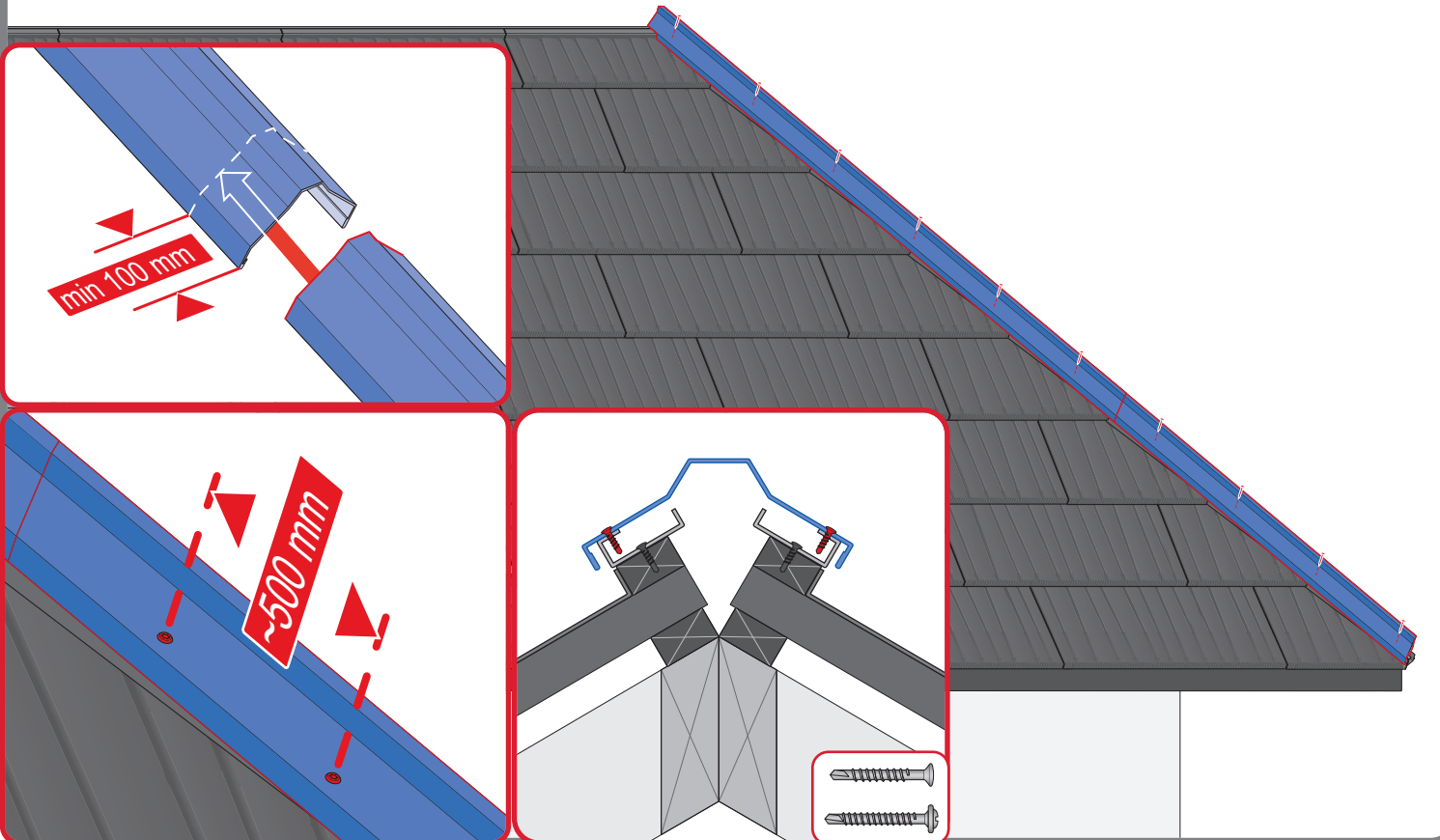

9a

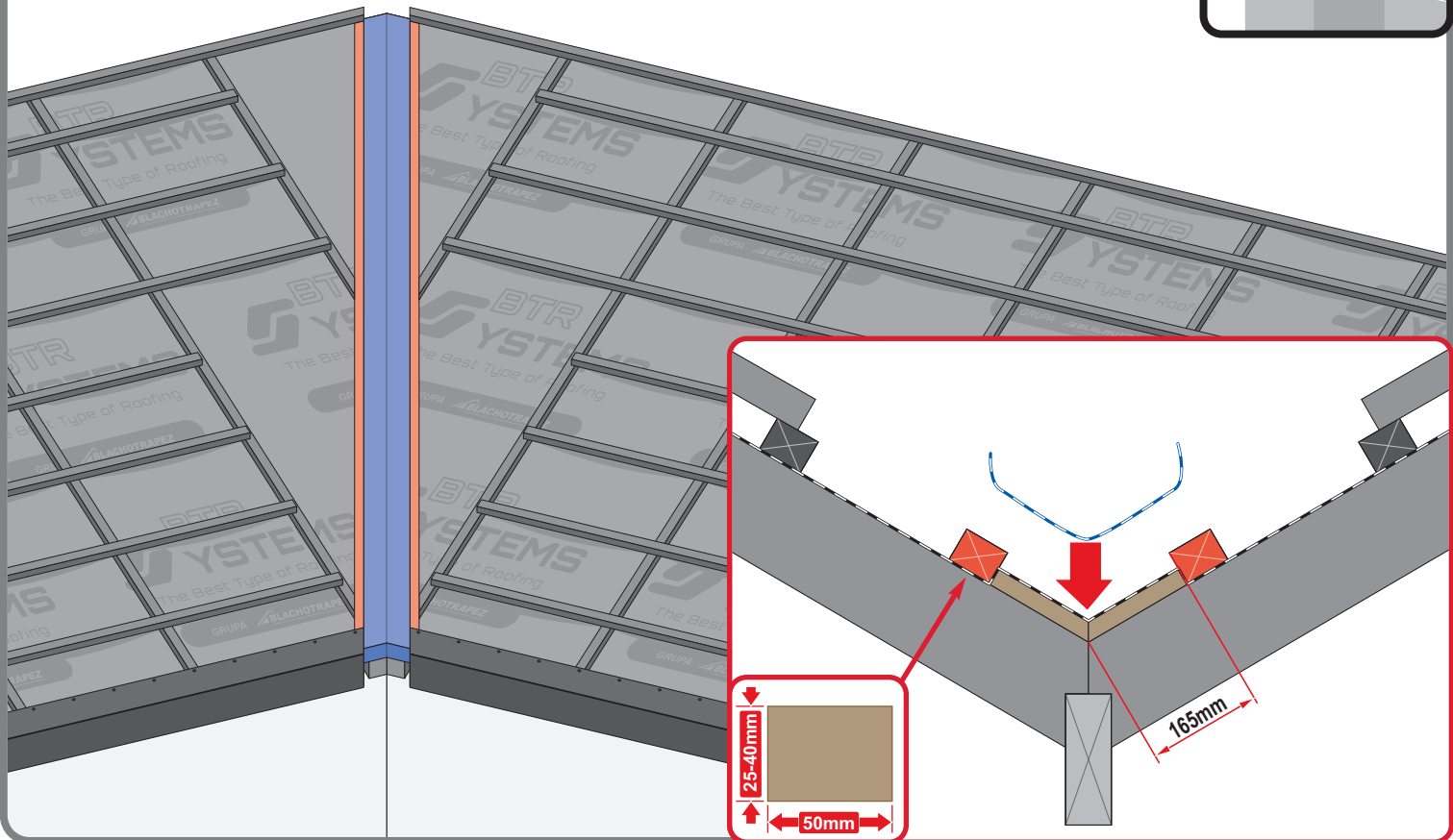

9b

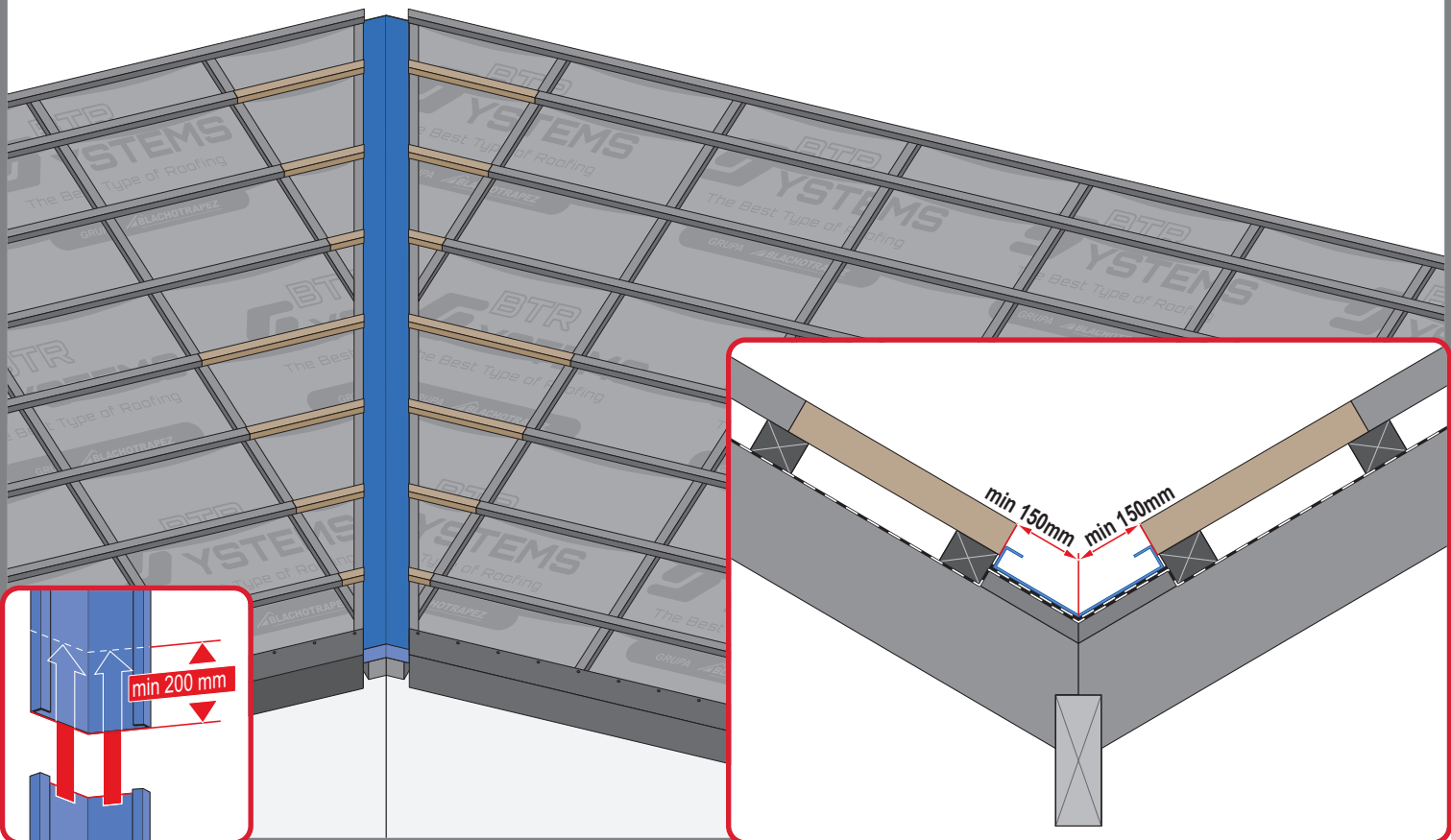

9c

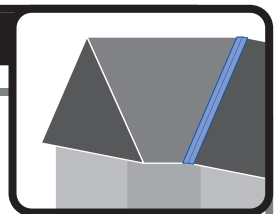
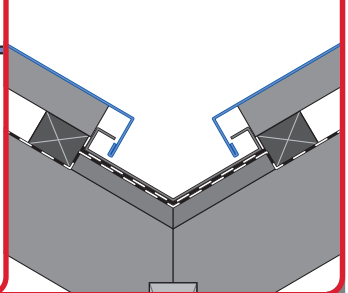
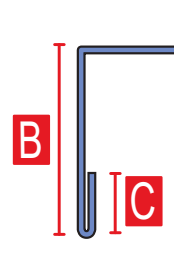
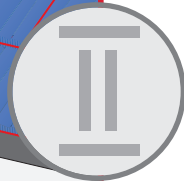
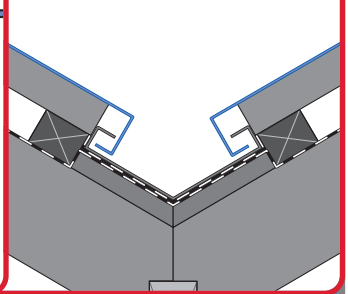
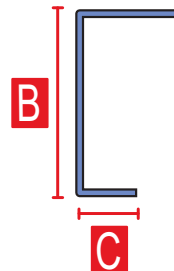
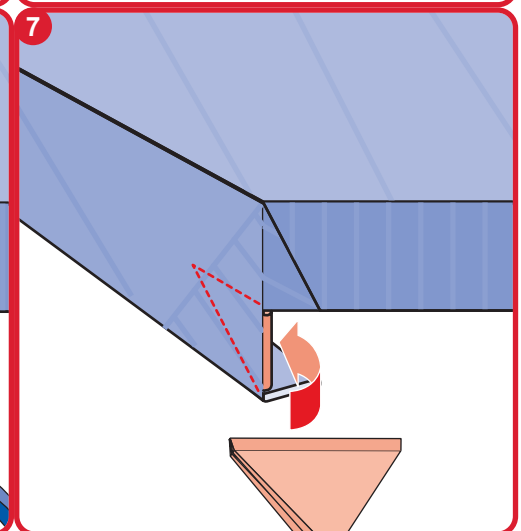
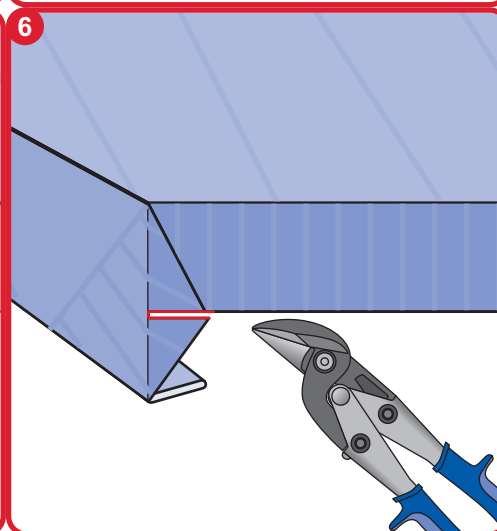
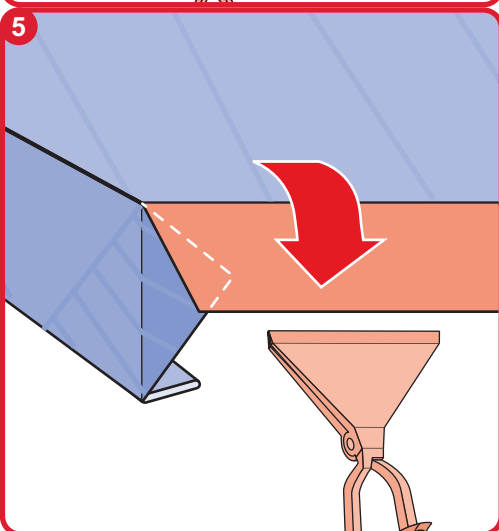
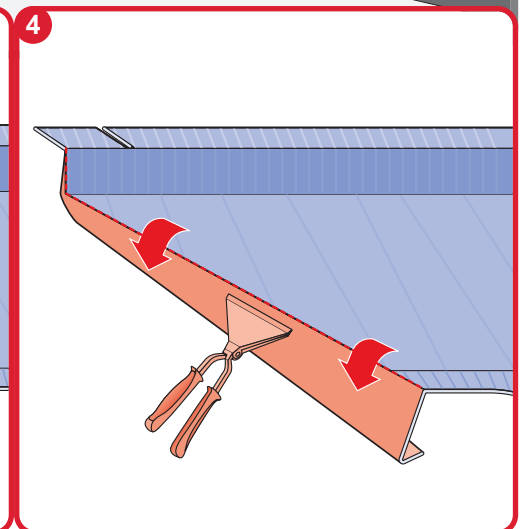
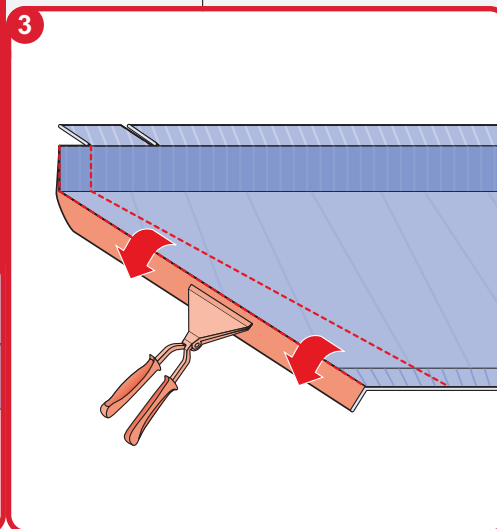
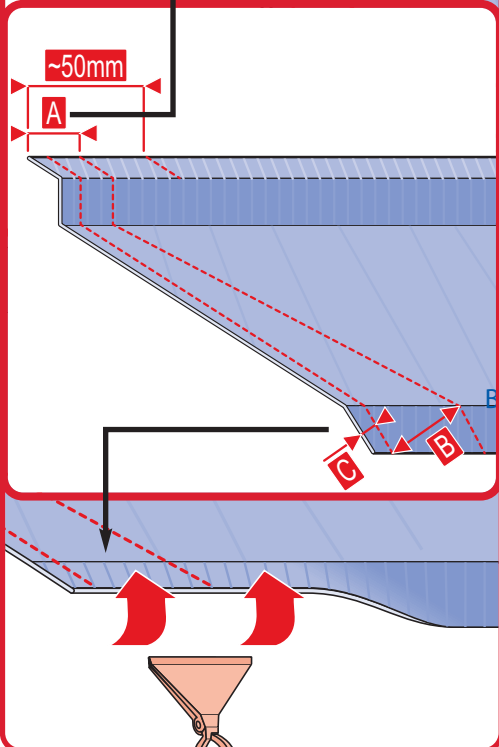
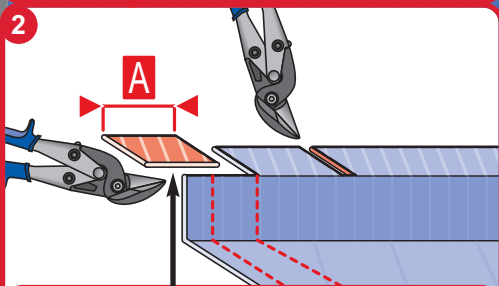
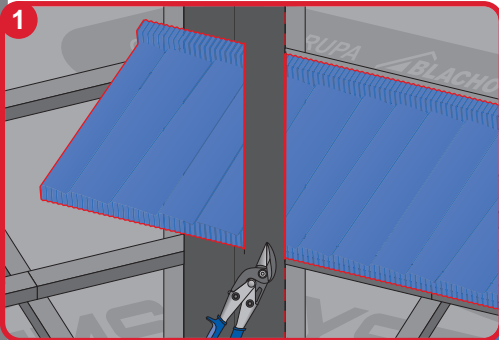

10a

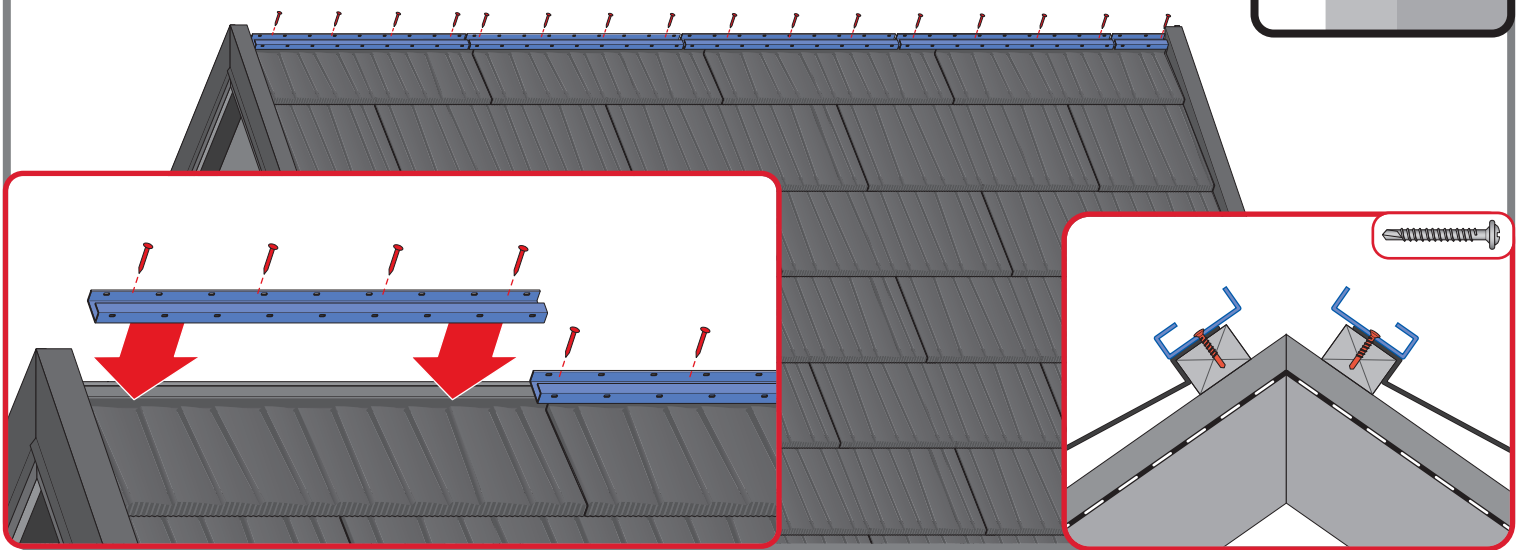

10b

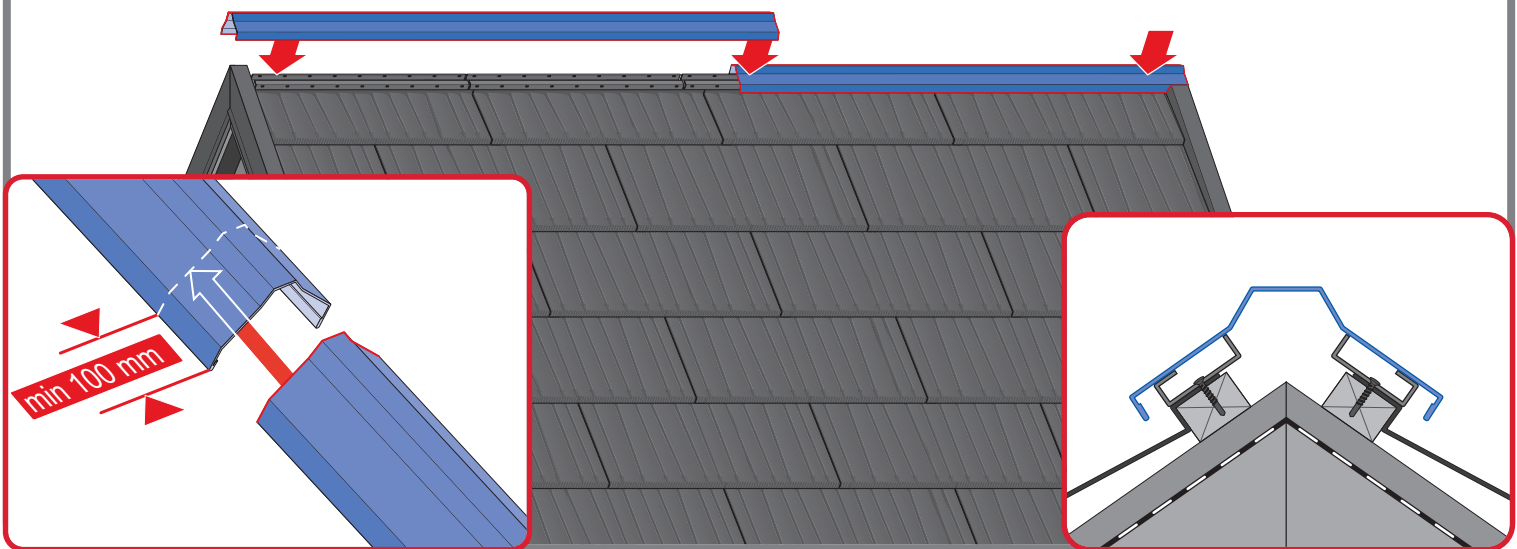

10c

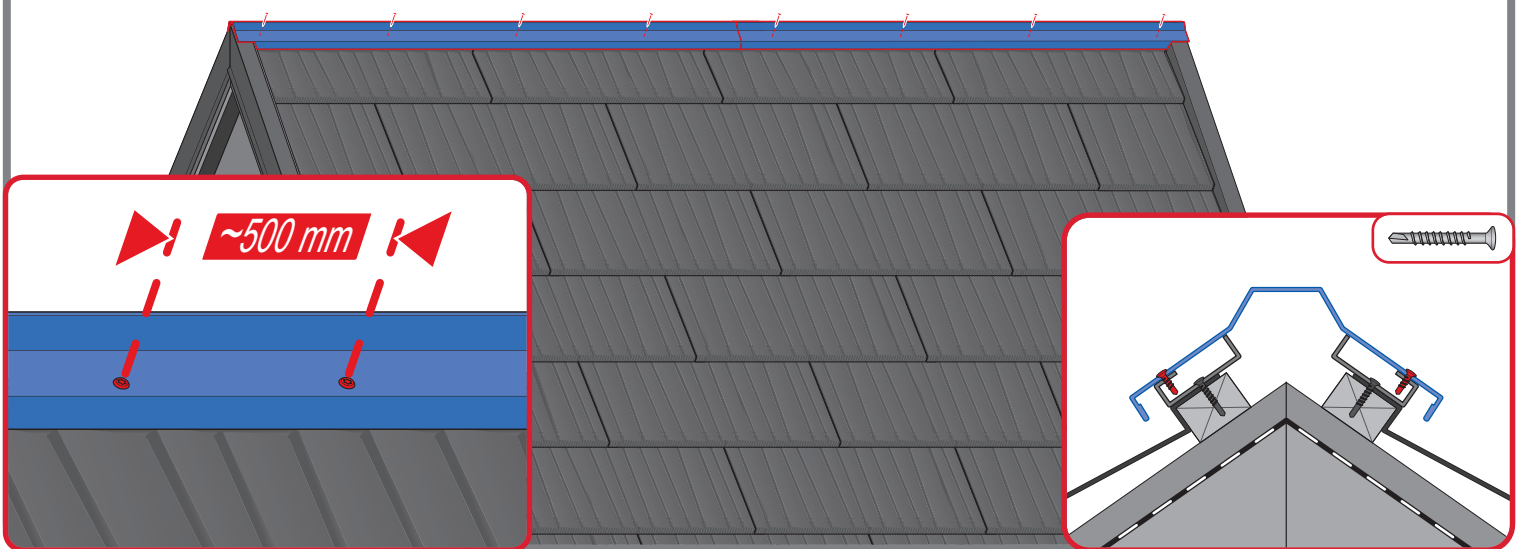

11a

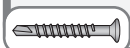
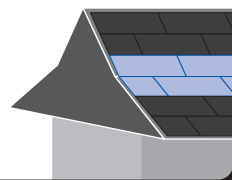

11b

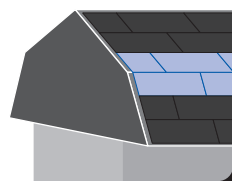

12a

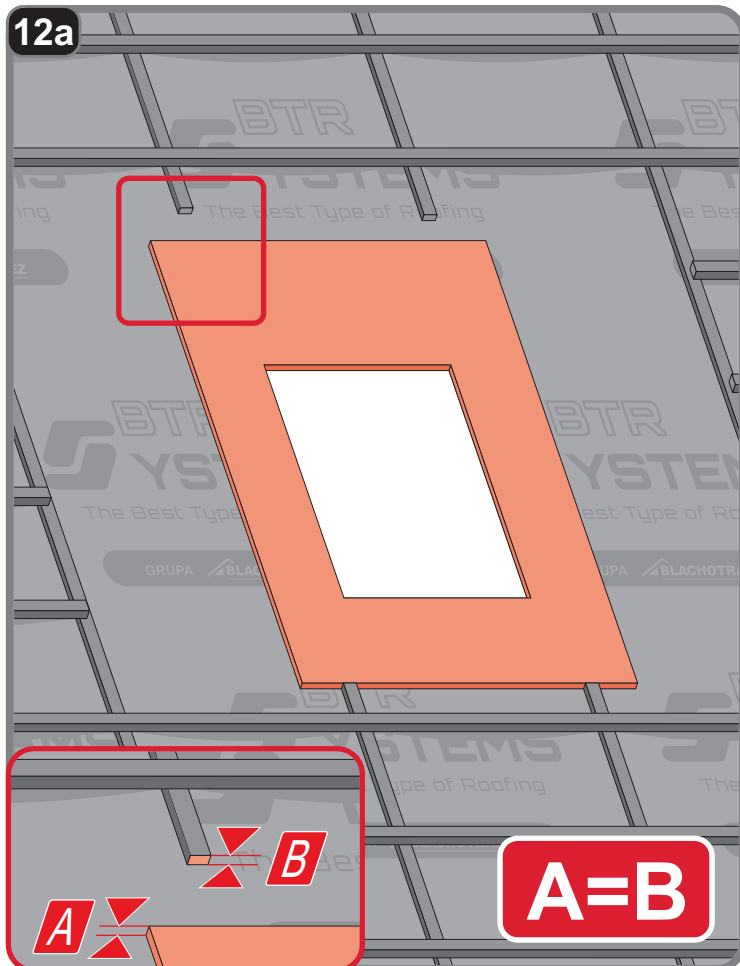

12b

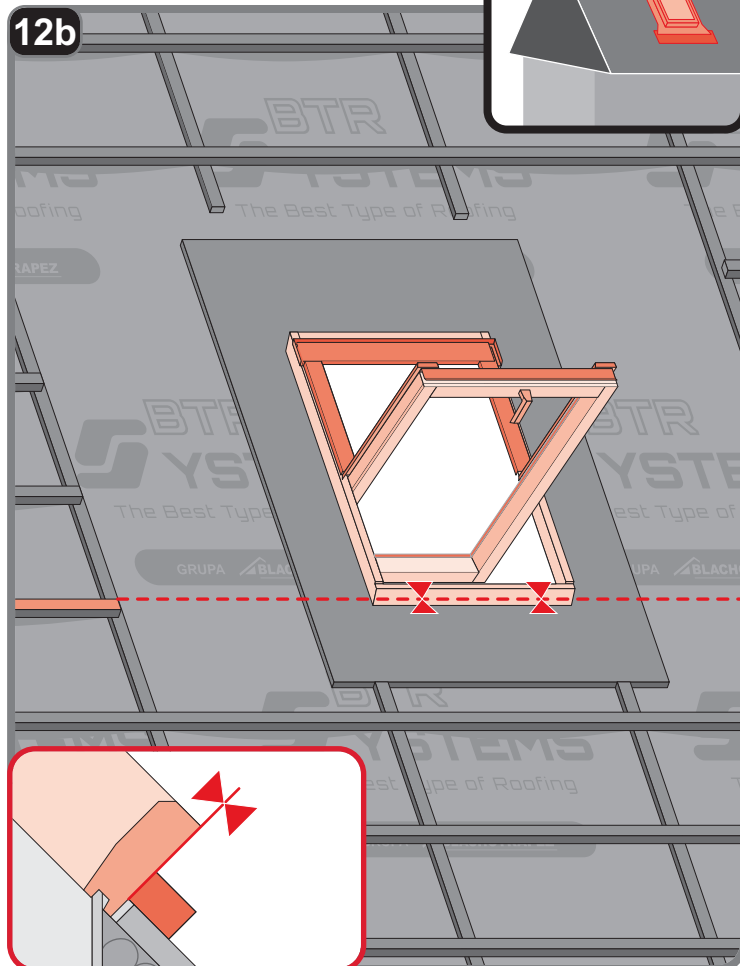

12c

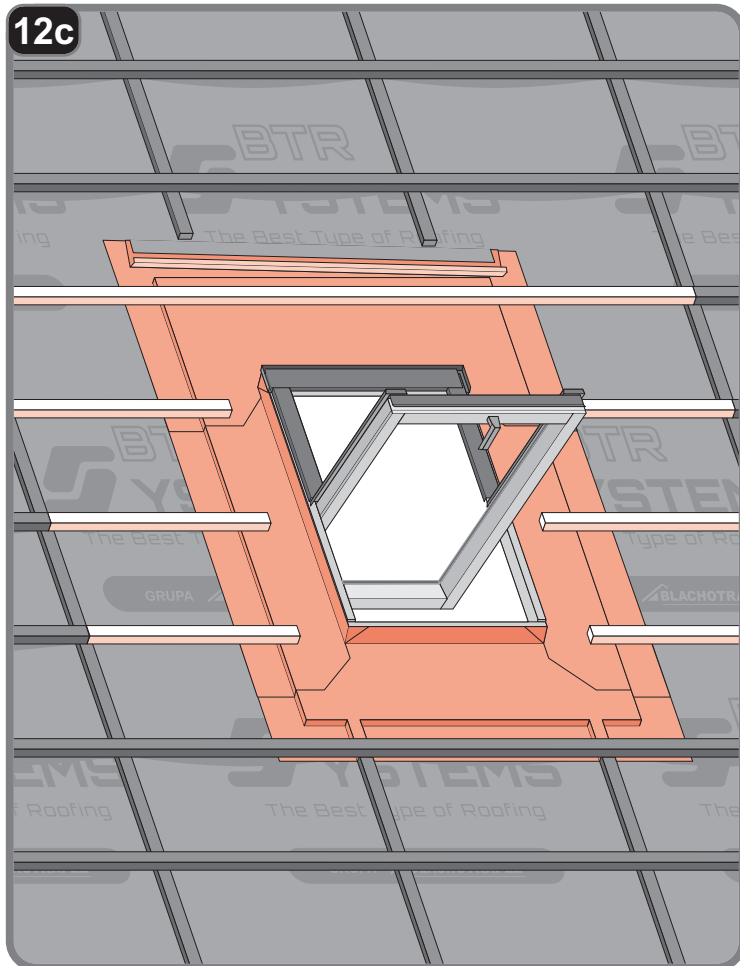

12d

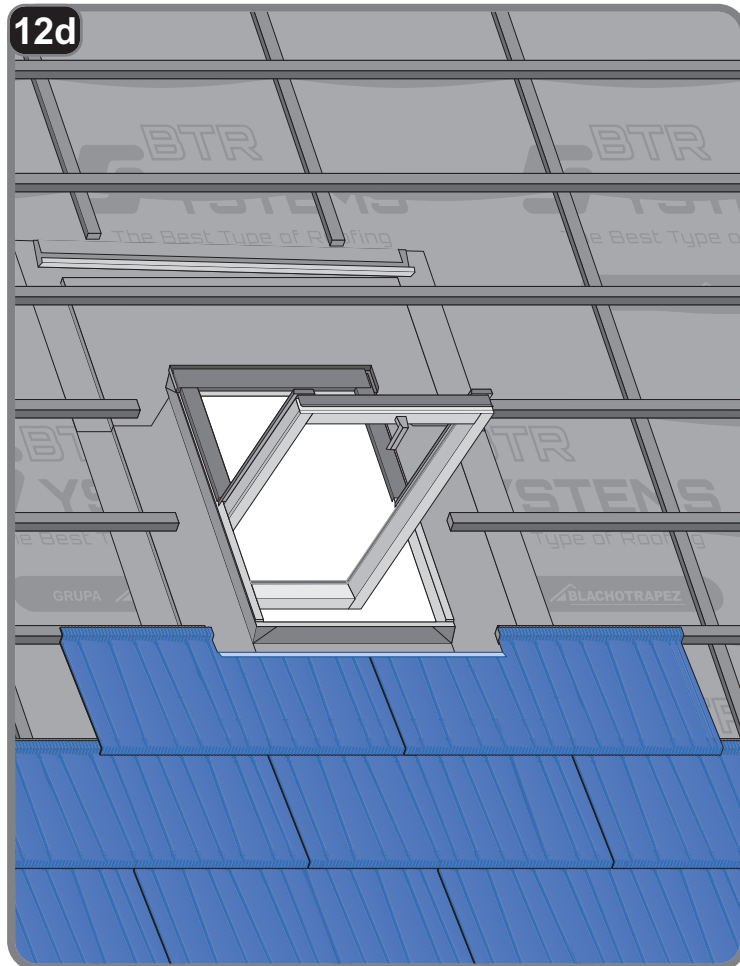

12e

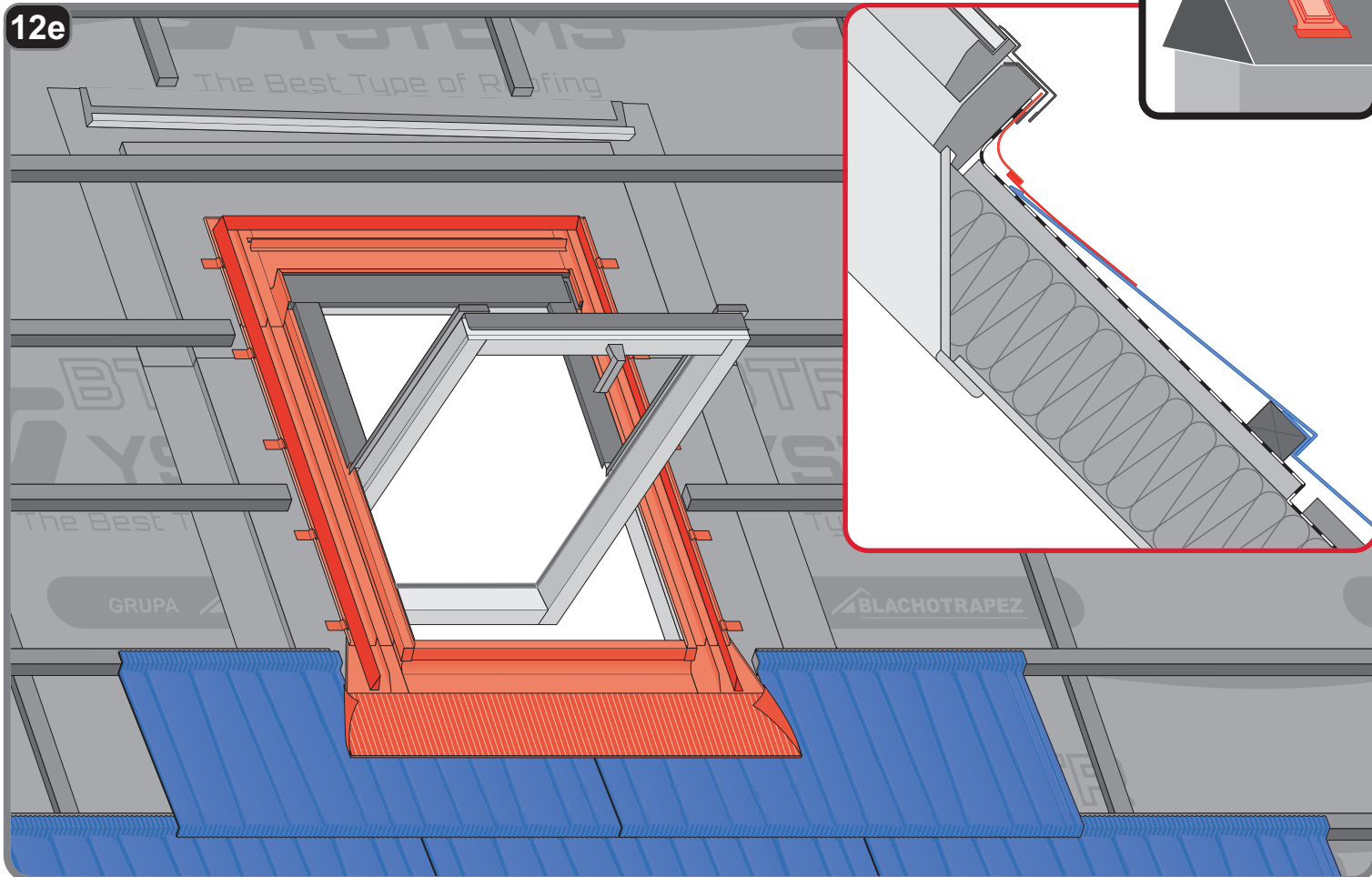

12f

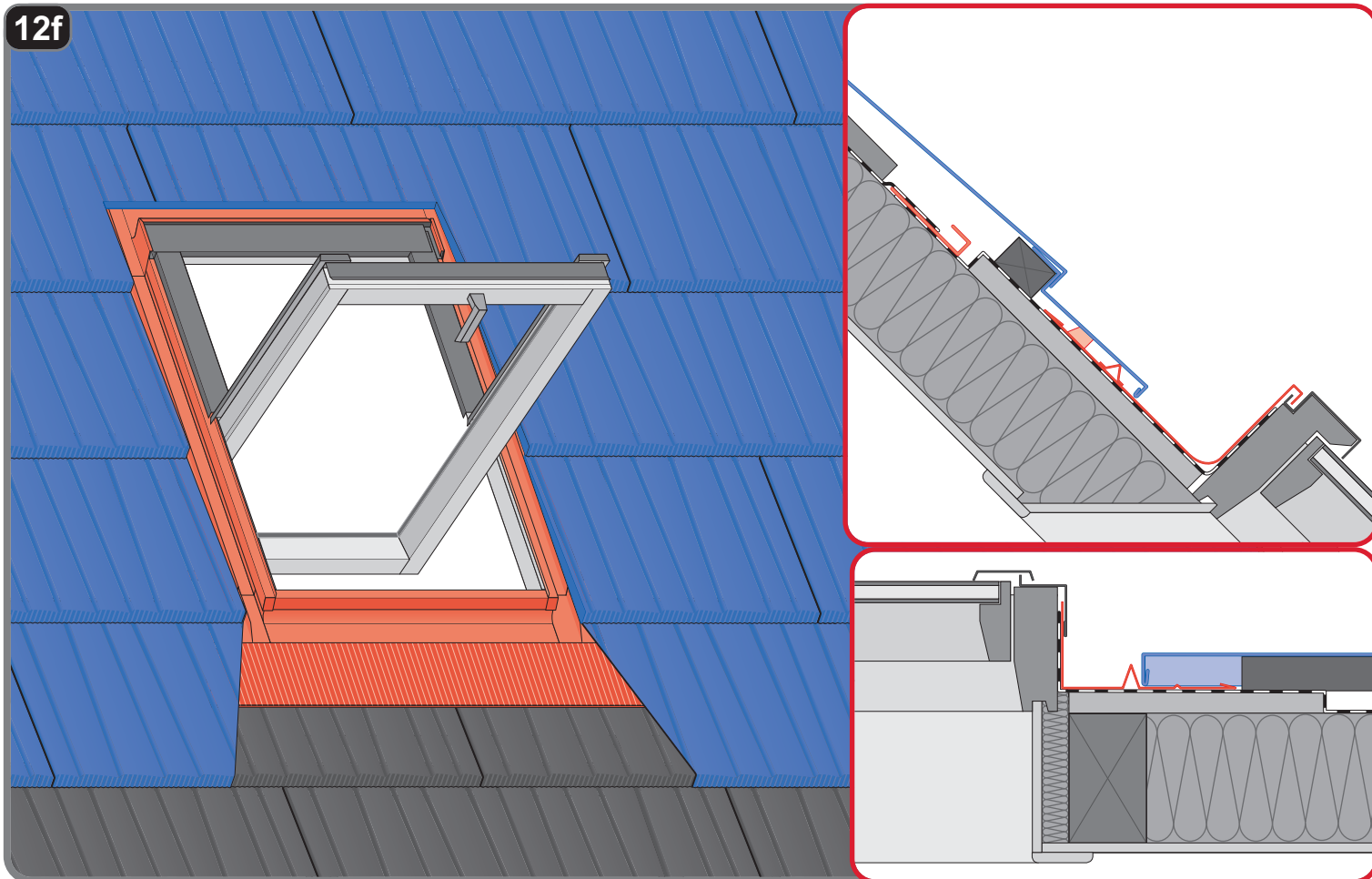



GRUPA  **BLACHOTRAPEZ**